



United States Department of the Interior

BUREAU OF LAND MANAGEMENT OFFICE OF THE DIRECTOR

Carson City Field Office
5665 Morgan Mill Road
Carson City, Nevada 89701
775-885-6000
<http://www.nv.blm.gov>

RECEIVED
D.C.N.R.
1999 DEC 27 AM 11:43



In Reply Refer To:
4100 (NV032)

December 23, 1999

Dear Interested Party:

Dick Huntsberger has requested temporary nonrenewable cattle grazing in the Clifton Flat Allotment (refer to enclosed map). The Carson City Field Office is considering approval of this request since it is within the established period of use (11/1-3/31) and will not exceed the total number of animal unit months of specified livestock grazing identified for the allotment. There will be no change in the kind or class of livestock.

If you have any comments regarding this matter, please provide them prior to January 14, 2000.

Sincerely,

Katrina Leavitt
Rangeland Ecologist

OFFICIAL ALLOTMENT MAP

THE CLIFTON FLAT
RANGE ALLOTMENT NUMBER 3011
IS SHOWN ON THIS MAP.

ISSUED BY: *Barbara M. [Signature]* 1/27/92
AREA MANAGER DATE

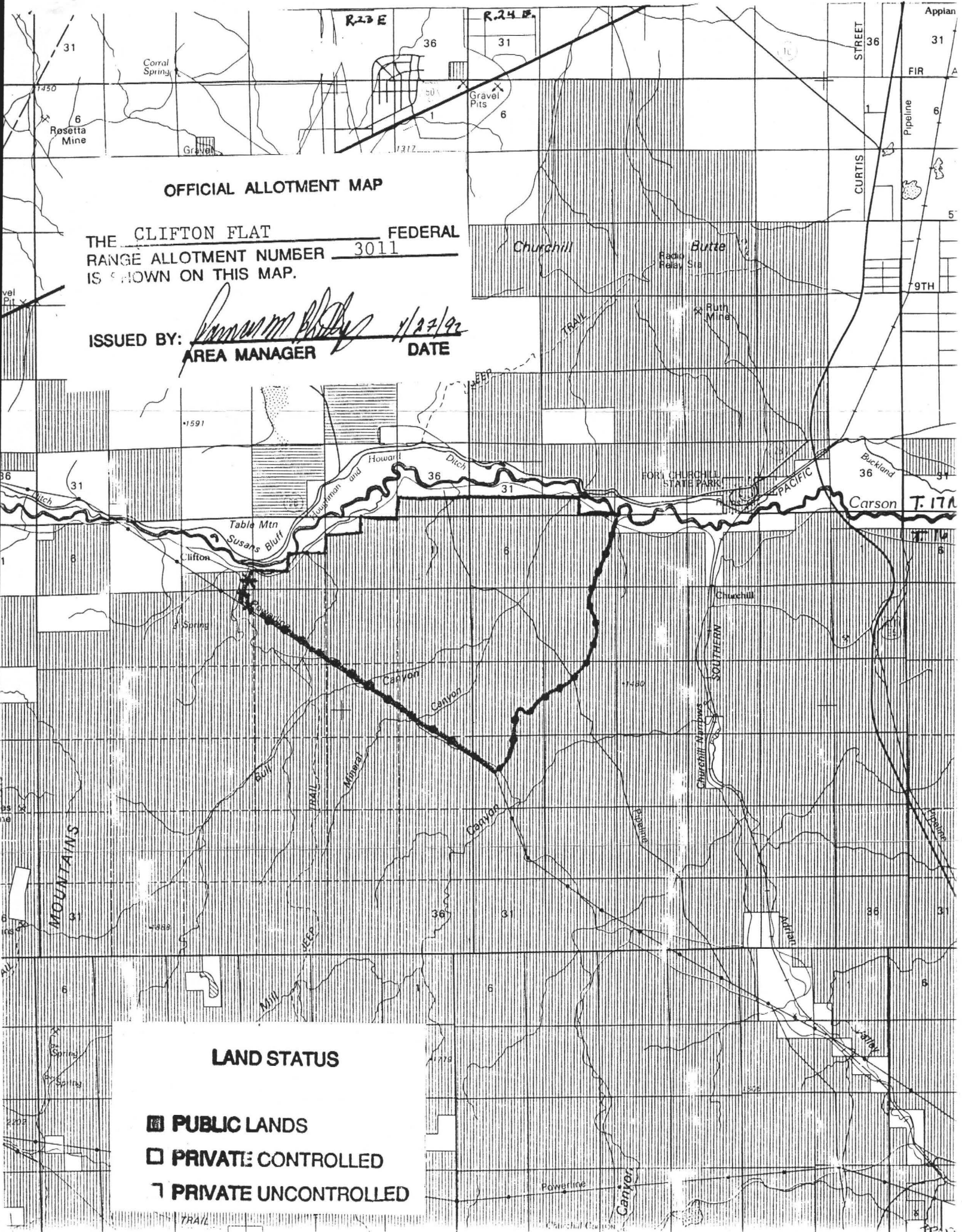

LAND STATUS

- PUBLIC LANDS
- PRIVATE CONTROLLED
- PRIVATE UNCONTROLLED