

Maverick Springs  
Albt.

m 8/4/81

IN REPLY REFER TO  
4800



# United States Department of the Interior

## BUREAU OF LAND MANAGEMENT

Ely District Office  
Star Route 5, Box 1  
Ely, Nevada 89301

August 4, 1981

Dawn Lappin  
Wild Horse Organized Assistance Inc.  
Box 555  
Reno, NV 89504

Dear Dawn:

Enclosed are the maps and information you requested for the Maverick Springs fence and wild horse inventories.

In 1980, 1,086 horses were inventoried in the Buck and Bald and Maverick Springs Wild Horse Herd areas. 489 head were removed that same year (see map where horses were gathered).

In May 1981, 587 horses were counted in the Buck and Bald area and 168 in the Maverick Springs area. (See map of the herd areas).

If you need additional information please contact this office again.

Sincerely,

George W. Cropper  
Acting District Manager

Enclosures

597  
1.12  

---

1.194  
597  

---

599  

---

668.64

597  
1.08  

---

4735  
5970  

---

644.35

1086  
489  

---

597  
  
587  
168  

---

755

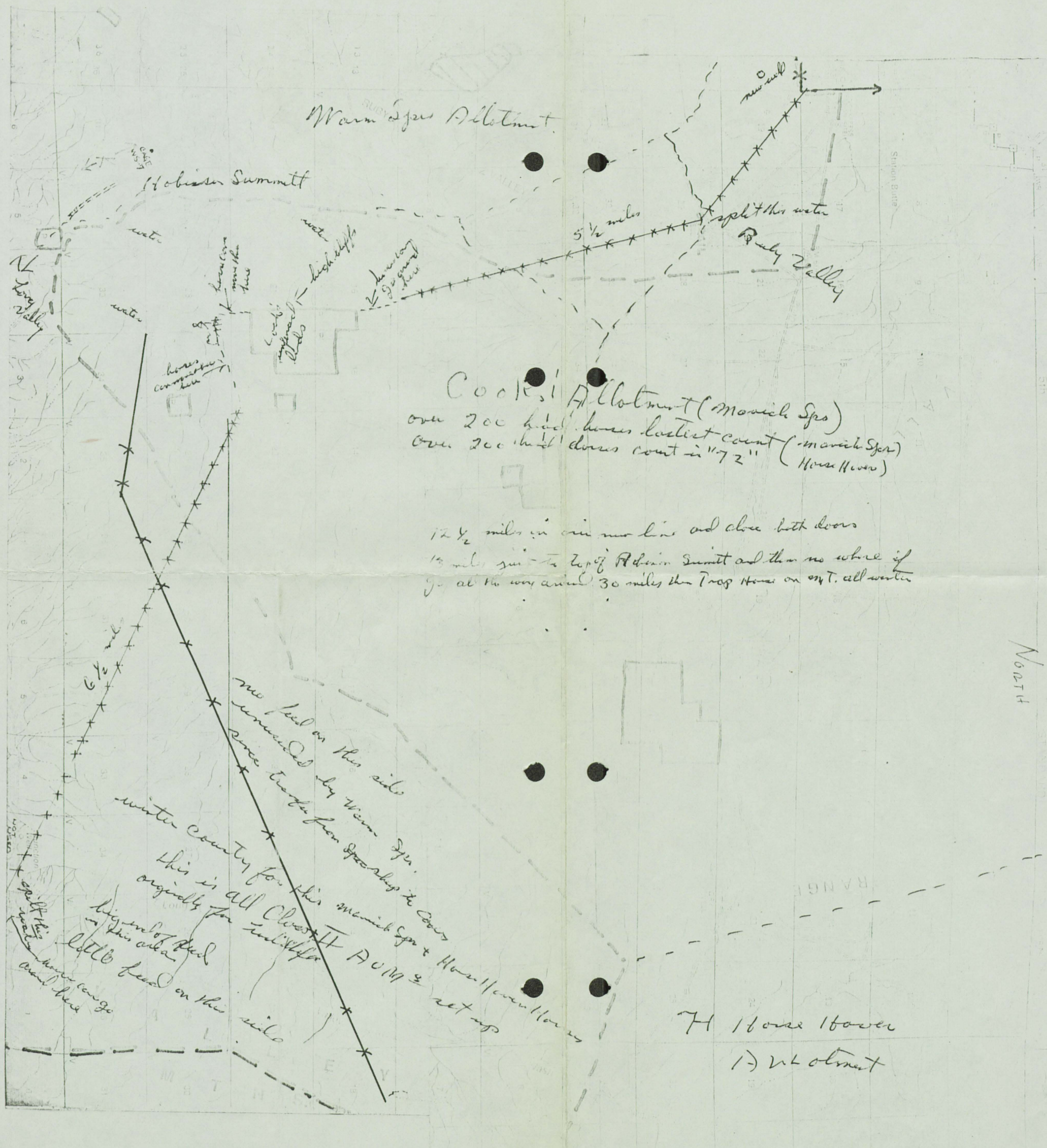

Warm Springs Allotment

Hobson Summit

Cooke's Allotment (Movich Spgs)

over 200 head horses lastest count (Movich Spgs)  
 over 200 head horses count in "72" (Horse House)

12 1/2 miles in air line and above both doors  
 15 miles gain to top of Hobson Summit and then no where if  
 go at the very angle 30 miles then Troop House on mt. all winter

no feed on this side  
 surrounded by Warm Spgs.  
 winter country for this Movich Spgs + Horse House  
 this is all closed off from  
 originally for trail  
 higher of feed  
 on this side  
 little feed on this  
 side

H Horse House  
 1) Allotment

North