



United States Department of the Interior

BUREAU OF LAND MANAGEMENT

Ely District Office  
HC 33 Box 33500  
Ely, Nevada 89301-9408



IN REPLY REFER TO:

4400 (NV-047)

JUN 17 1994

Cathy Barcomb  
Commission for the Preservation of Wild Horses  
Stewart Facility  
Capitol Complex  
Carson City, NV 89710

Dear Ms. Barcomb:

The Egan Resource Area (ERA) has recently completed a third year reevaluation of the North Cove Allotment. A copy of the reevaluation, which includes my management action, is enclosed for your information. The fifth year reevaluation is scheduled for fiscal year 1996.

If you have any questions, please contact Grant Hoggan of my staff at (702) 289-4865.

Sincerely,

Gene L. Drais, Manager  
Egan Resource Area

- 1 Enclosure  
1. North Cove Allotment Reevaluation

NORTH COVE ALLOTMENT (0816) THIRD YEAR RE-EVALUATION SUMMARY

I. INTRODUCTION

A Final Multiple Use Decision on the North Cove Allotment (0816) was issued on February 4, 1992. The decision recommended that the authorized livestock active use shall be changed, over five years, to 1,177 AUMs cattle use, with 583 AUMs placed in suspended non-use.

FROM:

<u>KIND</u>	<u>USE PERIOD</u>	<u>%F.R.</u>	<u>TOTAL AUMS</u>	<u>ACTIVE AUMS</u>	<u>SUSP. AUMS</u>
Cattle	12/01 to 05/15	100	1,760	732	1,028

TO:

<u>YEAR</u>	<u>NUMBER*</u>	<u>KIND</u>	<u>USE PERIOD</u>	<u>%F.R.</u>	<u>AUMS</u>		
					<u>TOTAL</u>	<u>ACTIVE</u>	<u>SUSP</u>
1	161	Cattle	12/1-5/15	100	1,760	879	881
3	184	Cattle	12/1-5/15	100	1,760	1,004	756
5	216	Cattle	12/1-5/15	100	1,760	1,177	583

\*Flexibility in cattle numbers will be allowed up to a maximum of 650 head from 12/1 to 5/15, not to exceed the maximum preference.

In accordance with 43 CFR 4130.6-2, the following terms and conditions will be included in the grazing permit for the North Cove Allotment:

- 1) Up to 282 AUMs of the active preference may be licensed, with water hauling, in the underutilized western portion of the allotment (see Appendix 1 for allotment map showing the approximate location of the western portion). Water hauling locations are flexible and would be included in the terms and conditions of the yearly grazing authorization.
- 2) The remaining 895 AUMs are allocated in conjunction with the historical use around Cabin Well and DLE Well.

The Final Decision mentioned above also established an Appropriate Management Level (AML) of 0 for wild horses of the White River Herd Management Area (HMA) within the North Cove Allotment. The AML was established at 0 because this allotment has been fenced off from wild horse use prior to 1971 and has not received wild horse use ever. This decision does not change the boundary of the White River HMA and it still provides for wild horses an opportunity to use the area in the future if horse use should occur.

## II. MANAGEMENT RE-EVALUATION

### A. Purpose

The purpose of this re-evaluation is to update the change(s) in the grazing use on the North Cove Allotment which was implemented as per the Final Multiple Use Decision dated February 4, 1992. This re-evaluation is necessary to determine if the allotment objectives are being met under the changes in grazing use.

### B. Summary of Studies Data

Utilization pattern mapping was conducted on the allotment in May of 1993. The data collected reflects grazing use on key species (winterfat, Indian ricegrass, Sandberg bluegrass, bottlebrush squirreltail, green molly kochia, alkali bluegrass, basin wildrye, alkali sacaton, and galleta) made by cattle. Deer use is two weeks in the spring and two weeks in the fall. The allotment is on a large migration route for the deer in Management Area 13 with no resident deer using the allotment. Recent estimates of deer numbers migrating through the west portion of the allotment are 500 to 1000 animals. Antelope numbers are estimated to be 20 to 25 animals. Antelope use is partial to yearlong. Historically, shrub-browse utilization has been slight in the west pasture. Use by deer and antelope is not a present concern.

Using the Key Forage Plant Utilization Method, use zones on the allotment were mapped as follows:

<u>Year</u>	<u>Non-Use</u> (0%)	<u>Slight</u> (1-20%)	<u>Light</u> (21-40%)	<u>Moderate</u> (41-60%)	<u>Heavy</u> (61-80%)	<u>Severe</u> (81-100)
1993	4,713 (18%)	15,232 (58%)	6,370 (24%)	0 ---	0 ---	0 ---

On June 10, 1993 a quadrat frequency trend transect was established and read within a key area in the east pasture. On July 19, 1993 another quadrat frequency trend transect was established and read within a key area in the west pasture. (soon to be the middle pasture) Halogeton has invaded in the winterfat interspaces at both key areas.

### C. Conclusions

Utilization pattern mapping for grazing use in 1993 reveals that the allowable use level objectives in the Land Use Plan (LUP) and Rangeland Program Summary (RPS) for cattle, deer, and antelope are being met. Presently, no immediate grazing problems exist either on the upland browse species sites or the valley grass-winterfat sites. This allotment is part of the

White River Herd Management Area (HMA). There has been no known historical wild horse use on the allotment. Currently there are no wild horses on this allotment. The 27 AUMs (two horses yearlong) identified in the RPS is no longer a valid AML.

(Note: After the Final Multiple Decision went into effect (no appeals) in early 1992, the permittee attempted in April 1992 to activate the 282 AUMs in the western portion of the allotment by hauling water. However, the cattle would not stay and eventually trailed back to the east. Now that the recommended drift fence has been built, the permittee is planning on hauling water to the west pasture this spring (1994) and will activate 282 AUMs in this portion of the allotment.)

#### D. Technical Recommendations

Since utilization on this allotment is light or less, the third year increase is recommended. Therefore the active preference will change from 879 AUMs to 1,004 AUMs with 756 AUMs suspended. A four mile drift fence was built as of April 1994 in the west pasture as recommended in the Final Multiple Use Decision. In conjunction with water hauling, this fence will allow for the 282 AUMs to be used in the west portion of the existing west pasture. Future monitoring will be required to observe if use levels are appropriate in relation to the proposed stocking rate allocations. Therefore, use pattern mapping will continue to be conducted. Actual use by pasture will be reported by the permittee annually as required. In addition, the quadrat frequency trend transects will be re-read at three to five year intervals.

#### E. Management Action

The third year increase will be implemented in the 1994 grazing year as listed in the original decision.

APPENDIX 1

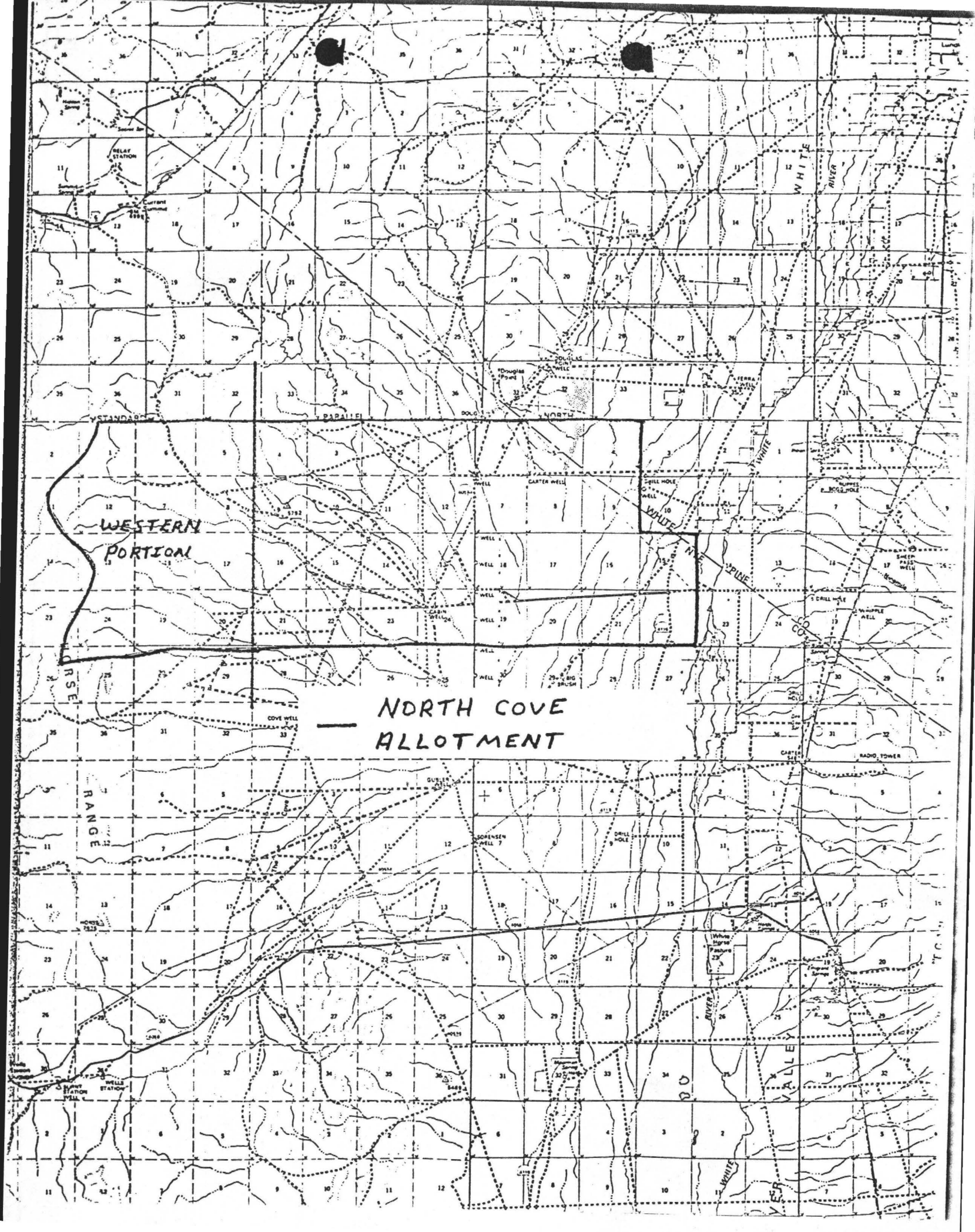

WESTERN  
PORTION

NORTH COVE  
ALLOTMENT

RANGE

WHITE  
RIVER

WHITE  
MOUNTAIN

VALLEY

RELAY  
STATION

Current  
Camp

DOUGLAS  
WELL

FERRA  
WELL

WELL

CARTER WELL

DRILL HOLE  
WELL

CASH  
WELL

WELL 18

WELL 17

WELL 16

WELL 19

WELL 20

WELL 21

WELL 30

WELL 29

WELL 28

DRILL HOLE

WHIPPLE  
WELL

DRILL HOLE

DRILL HOLE

CARTER  
WELL

RADIO TOWER

GUSTIN  
WELL

SORENSEN  
WELL 7

DRILL HOLE

Whim  
Sign

RELAY  
STATION

WELL

WELL

WELL

WELL

WELL

WELL

WELL

WELL

WELL

WELL

WELL

WELL

WELL

WELL

WELL

WELL

WELL

WELL

RELAY  
STATION

RELAY  
STATION

RELAY  
STATION

RELAY  
STATION

RELAY  
STATION

RELAY  
STATION

RELAY  
STATION

RELAY  
STATION

RELAY  
STATION

RELAY  
STATION

RELAY  
STATION

RELAY  
STATION

RELAY  
STATION

RELAY  
STATION

RELAY  
STATION

RELAY  
STATION

RELAY  
STATION

RELAY  
STATION

RELAY  
STATION

RELAY  
STATION

RELAY  
STATION

RELAY  
STATION

RELAY  
STATION

RELAY  
STATION

RELAY  
STATION

RELAY  
STATION

RELAY  
STATION

RELAY  
STATION

RELAY  
STATION

RELAY  
STATION