



United States Department of the Interior

BUREAU OF LAND MANAGEMENT

Elko District Office
3900 East Idaho Street
Elko, Nevada 89801-4611

In Reply Refer To:
4130 (NV-010)

Larry and Antoinette Schutte
Big Springs Ranch
Box 2039, Oasis
Wells, NV 89835

MAY 17 1996

Dear Mr. and Mrs. Schutte:

Your request to renew your grazing permit for the Big Springs Allotment was received on May 15, 1996. The signed "Acceptance of Terms and Conditions" form was also received on May 15, 1996. Based on your acceptance of the terms and conditions, we propose to offer you a term grazing permit effective for the length of the base property lease (May 16, 1996 to May 15, 1999). This permit would be renewed upon renewal of your base property lease, not to exceed ten years.

The new grazing regulations require the authorized officer to consult, cooperate, and coordinate (CCC) with affected permittees, the State agencies responsible for managing resources within the area, and the interested public prior to the issuance of grazing permits (43 CFR 4130.2(b)). Therefore, a copy of this letter and a copy of the acceptance form will be sent to anyone who has expressed an interest in the Big Springs Allotment. (See the attached map for the location of the allotment.) **The interested public is being asked to provide comment by May 31, 1996.** We plan to issue you a temporary use authorization pending completion of the public consultation process.

The terms and conditions outlined in the attached acceptance form are those which have historically appeared on previous annual licenses and permits authorizing grazing use in this allotment. A portion of the Goshute Wild Horse Herd Management Area is located on the eastern edge of this allotment.

The terms and conditions outlined are consistent with the Wells Resource Management Plan. The impacts of livestock grazing under these terms and conditions have been analyzed in the Wells Resource Management Plan Environmental Impact Statement. An Administrative Determination of National Environmental Policy Act (NEPA) Compliance has been completed and is available at the Elko District Office. A monitoring evaluation of the Big Springs Allotment has been initiated and is planned to be completed in 1997.

5/17/96
a! Big Springs, BLM

If we propose to change the terms and conditions of your grazing permit, following the comment period, we will keep you and other interested parties informed.

If you have any questions please contact Karl Scheetz, your assigned Rangeland Management Specialist, at (702) 753-0358. If you would prefer to discuss this matter in person, please call to set up an appointment with us so that we may respond to any questions you may have.

Sincerely yours,

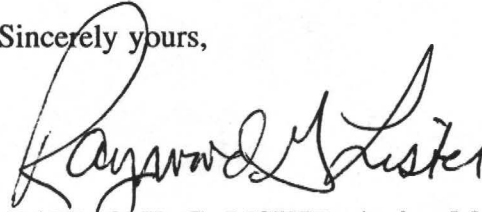

RAYMOND G. LISTER, Acting Manager
Renewable Resources

Enclosures: as stated above

cc:

BSR, Inc.

Scott Egbert

U.S. Fish & Wildlife Service

Nevada Division of Wildlife

Nevada Department of Agriculture

Nevada Commission for the Preserv. of Wild Horses

Elko County Commissioners

Sierra Club, Toyiabe Chapter

Natural Resources Defense Council(NRDC)

Wild Horse Organized Assistance (WHOA)

Animal Protection Institute (API)

Rutgers School of Law - Newark

Wells Resource Area Grazing Assn.

Kenneth Jones

Von Sorenson

Kathryn Cushman

Federal Land Bank

Elko Co. Advisory Board to Manage Wildlife

The Nature Conservancy

**ACCEPTANCE OF TERMS & CONDITIONS and
REQUEST FOR GRAZING PERMIT**

We, Larry and Antoinette Schutte, agree to accept the Terms & Conditions listed below and request that we be offered a Grazing Permit to graze the allotments in which we have a grazing preference.

Proposed Terms & Conditions

<i>Allotment</i>	<i>Livestock Number & Kind</i>	<i>Begin Period</i>	<i>End Period</i>	<i>%PL</i>	<i>Type Use</i>	<i>AUMs</i>
Big Springs 04306	1576 Cattle	03/01	02/28	68	Active	12,862
Fenced Federal	25 Cattle	03/01	03/31	100	Active	25
					Total	12,887

Terms and Conditions

Grazing is prohibited on white sage and saltbush areas between April 1 and October 31 of each year.

Your grazing use area will be limited to that area east of the crest of the Pequop Mountains south of I-80 and east of the rangeline that separates R. 65 E. from R. 66 E. north of I-80 as outlined in the rangeline agreement signed and authorized on September 5, 1990.

Submit actual use reports for the Big Springs Allotment describing use by livestock number and kind, dates of use, and pasture or geographic area of use. Submit your Big Springs actual use report by November 15 annually. Describe all grazing use made from November 1 of the previous year through October 30 of the current year.

Supplemental feeding is limited to salt, mineral and/or protein supplements in block, granular or liquid form. Such supplements must be placed at least ¼ mile from live waters (springs and streams), troughs, wet or dry meadows, and aspen stands.

All riparian enclosures, including spring development enclosures, are closed to livestock use unless specifically authorized in writing.

Payment of grazing fees is due on or before the due date specified on the grazing bill. Failure to pay the grazing bill within 15 days of the due date specified on the bill shall result in a late fee assessment of \$25.00 or 10 percent of the grazing bill, whichever is greater, but not to exceed \$250.00

The term of the Grazing Permit will be From May 16, 1996 to May 15, 1999.

Signed: James D. Schutte

5/15/96
Date

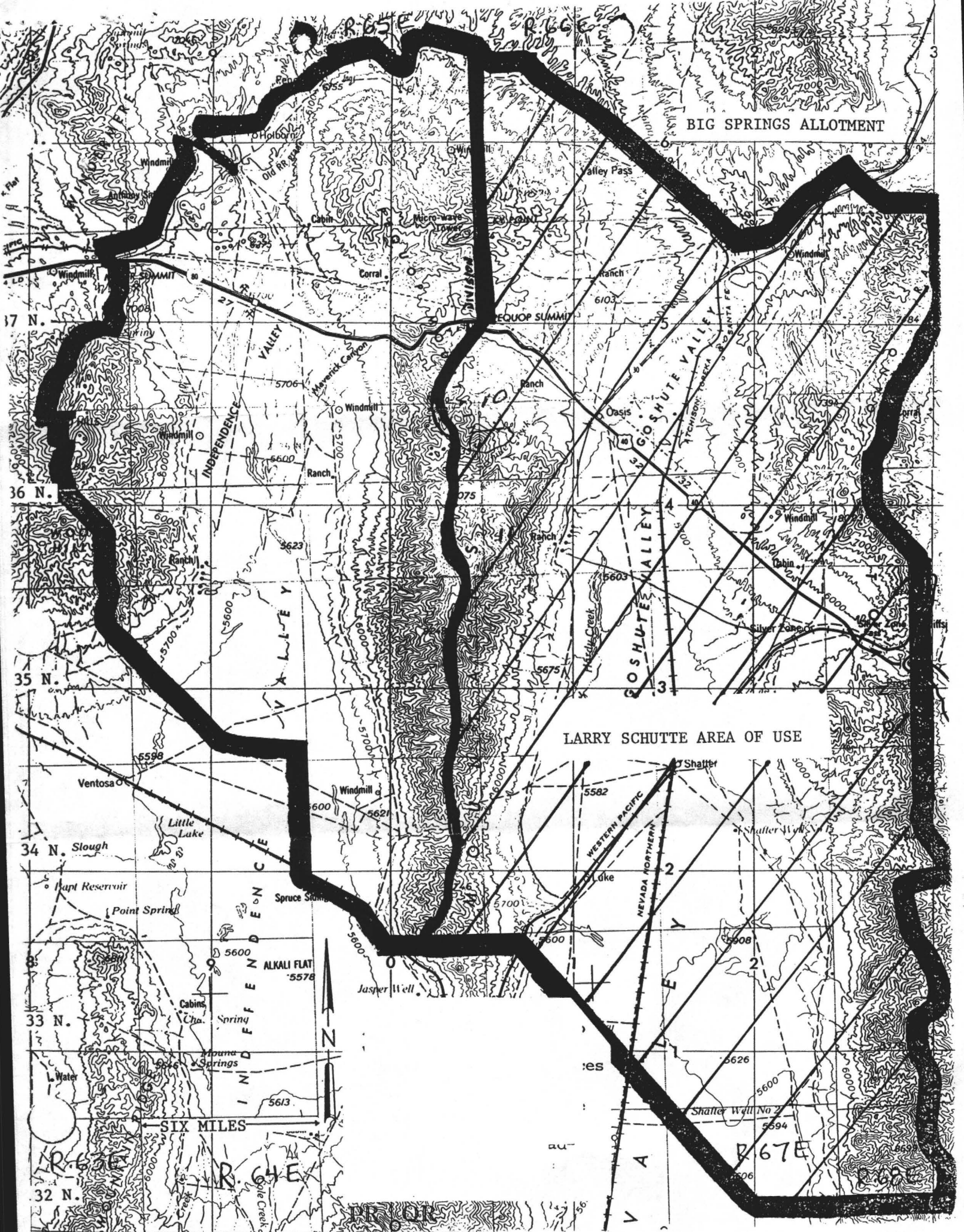

BIG SPRINGS ALLOTMENT

LARRY SCHUTTE AREA OF USE

SIX MILES



R. 65 E.

R. 66 E.

R. 67 E.

R. 67 E.

32 N.

33 N.

34 N.

35 N.

36 N.

37 N.

PR. 10



COMMISSION FOR THE
PRESERVATION OF WILD HORSES

255 W. Moana Lane

Suite 207A

Reno, Nevada 89509

(702) 688-2626

May 31, 1996

Mr. Raymond G. Lister
Renewable Resources
Elko District
Bureau of Land Management
3900 East Idaho Street
Elko, Nevada 89801-4611

Subject: Big Springs 10 Year Permit - Goshute HMA

Dear Mr. Lister:

The Commission for the Preservation of Wild Horses has received and reviewed the "acceptance of terms and conditions" for the long term grazing permit of the Big Springs Allotment. This allotment is a portion of the Goshute Wild Horse Management Plan and subject to conditions of the Wells Resource Management Plan - Wild Horse Amendment.

To our knowledge, no resource activity plan has been prepared for this allotment or herd management area. We are encouraged that the allotment is scheduled for an evaluation/multiple use decision in 1997. Since rangeland monitoring data have been collected since the 1986 land use plan, it would be appropriate to prepare an environmental assessment for the allotment evaluation or any pending long term grazing authorization. Re-issuance of long term authorizations are not programmatic under previous environmental impact statements and new federal regulations require full consultation during the development of resource activity plans, environmental documents or equivalents.

We would appreciate your attention on this matter.

Sincerely,

A handwritten signature in cursive script that reads "Catherine Barcomb".

CATHERINE BARCOMB
Executive Director



COMMISSION FOR THE
PRESERVATION OF WILD HORSES

255 W. Moana Lane

Suite 207A

Reno, Nevada 89509

(702) 688-2626

May 31, 1996

Mr. Raymond G. Lister
Renewable Resources
Elko District
Bureau of Land Management
3900 East Idaho Street
Elko, Nevada 89801-4611

Subject: Big Springs 10 Year Permit - Goshute HMA

Dear Mr. Lister:

The Commission for the Preservation of Wild Horses has received and reviewed the "acceptance of terms and conditions" for the long term grazing permit of the Big Springs Allotment. This allotment is a portion of the Goshute Wild Horse Management Plan and subject to conditions of the Wells Resource Management Plan - Wild Horse Amendment.

To our knowledge, no resource activity plan has been prepared for this allotment or herd management area. We are encouraged that the allotment is scheduled for an evaluation/multiple use decision in 1997. Since rangeland monitoring data have been collected since the 1986 land use plan, it would be appropriate to prepare an environmental assessment for the allotment evaluation or any pending long term grazing authorization. Re-issuance of long term authorizations are not programmatic under previous environmental impact statements and new federal regulations require full consultation during the development of resource activity plans, environmental documents or equivalents.

We would appreciate your attention on this matter.

Sincerely,

A handwritten signature in cursive script that reads "Catherine Barcomb".

CATHERINE BARCOMB
Executive Director