



United States Department of the Interior

BUREAU OF LAND MANAGEMENT

Elko Field Office
3900 East Idaho Street
Elko, Nevada 89801-4611

In Reply Refer To:
4130 (NV-012)

FEB 10 1999

Egbert Livestock LLC
c/o F. Scott Egbert
HC 60 Box 135
Wells, NV 89835

GRAZING PERMIT RENEWAL BIG SPRINGS ALLOTMENT

Dear Mr. Egbert:

Your grazing permit for the Big Springs Allotment will expire on February 28, 1999 and must be renewed prior to authorization to graze on public lands for the 1999 grazing season. In order to authorize your 1999 grazing use, we need to have the attached "Acceptance of Terms and Conditions" form signed and returned as promptly as possible. The term of this permit will be from March 1, 1999 to February 28, 2000 based on a one year renewal of your previous base property lease from Newmont Gold Company. Your grazing permit for the Big Springs Allotment would be renewed upon renewal of your base property lease, not to exceed ten years (ending February 28, 2009).

The Big Springs Allotment was classified as an Improve ("I") category allotment through the Wells Resource Management Plan (RMP). The objective for "I" category allotments is to improve conditions. At this time, the Elko Field Office is not proposing to change your grazing preference or periods of use. Evaluation of livestock grazing management in relation to achievement of the Rangeland Health Standards and Guidelines approved for the Northeastern Great Basin Area of Nevada and multiple use objectives is scheduled for completion this year (1999).

Please note that several new terms and conditions have been added to your grazing permit. Since a recent evaluation has not been completed for the Big Springs Allotment, a new term and condition has been added to the enclosed acceptance form which states that if an assessment results in a determination that changes are necessary in order to comply with the Rangeland Health Standards and Guidelines approved for the Northeastern Great Basin Area of Nevada and multiple use objectives, the permit or lease will be reissued subject to revised terms and conditions. In addition, your grazing permit will continue to define your area of use within the Big Springs Allotment as that area west of the Pequop Mountain watershed divide (The area east of the Pequop Mountain watershed divide is currently permitted to Parasol Ranching LLC). Closure of the Wood Hills Burn to livestock grazing ends on

February 28, 1999 and will no longer be included as a term and condition. The remaining terms and conditions on the enclosed acceptance form are standard terms and conditions.

The new grazing regulations also require the authorized officer to consult, cooperate, and coordinate with affected permittees, the State agencies having lands or responsible for managing resources within the area, and the interested public prior to the issuance or renewal of grazing permits (43 Code of Federal Regulations 4130.2(b)). Therefore, a copy of this letter, a copy of the terms and conditions, and a map showing the location of the Big Springs Allotment will be sent to anyone who has expressed an interest in the management of livestock grazing on the Big Springs Allotment. **The interested public is being asked to provide comments, if any, within 15 days of the date of this letter.** You will be notified of any changes to terms and conditions that may be warranted as a result of comments received.

Land ownership within the area of use for Egbert Livestock LLC is characterized as a checkerboard land pattern with alternating sections of public and private lands. Within the grazing use area for Egbert Livestock LLC, which is defined as that area west of the Pequop Mountain watershed divide, there are no wild horse herd management areas. There are no streams within Egbert Livestock LLC's area of use.

The terms and conditions outlined are consistent with the Wells Resource Management Plan and have been analyzed in the Wells Resource Management Plan Environmental Impact Statement.

If you have any questions please contact Karl Scheetz, your assigned Rangeland Management Specialist at (775) 753-0280. If you would prefer to discuss this matter in person, please call to set up an appointment with us so that we may respond to any questions you may have.

Sincerely,



CLINTON R. OKE
Assistant Field Manager
Renewable Resources

Enclosures: As stated

cc: Newmont Gold Corporation
U.S. Fish and Wildlife Service
Nevada Division of Wildlife - Elko
Board of Elko County Commissioners
Nevada Cattlemen's Association
Resource Concepts, Inc.
HTT Resource Advisors
Von L. Sorensen
Wild Horse Organized Assistance (WHOA)
Commission for the Preservation of Wild Horses
International Society for the Protection of Mustangs and Burros
Elko County Conservation Association

ACCEPTANCE OF TERMS & CONDITIONS and
REQUEST FOR GRAZING PERMIT

We, Egbert Livestock LLC, agree to accept the Terms & Conditions listed below and request that we be offered a Grazing Permit to graze the allotment in which we have a grazing preference.

Proposed Terms & Conditions

<i>Allotment</i>	<i>Livestock Number & Kind</i>	<i>Begin Period</i>	<i>End Period</i>	<i>% PL</i>	<i>Type Use</i>	<i>AUMs</i>
Big Springs	799 Cattle	03/01	02/28	56	Active	5370
Big Springs Fenced Federal Range	15 Cattle	03/01	03/30	100	Active	15

Terms and Conditions:

If an assessment results in a determination that changes are necessary in order to comply with the standards and guidelines, the permit or lease will be reissued subject to revised terms and conditions.

Your grazing use area within the Big Springs Allotment will be limited to the west side of the allotment. This includes the Independence Valley Pasture, Holborn Pasture, and that portion of the North Pequop Mountain Pasture which is situated west of the rangeline that separates R. 65 E. from R. 66 E. north of I-80.

There are no historic suspended nonuse AUMs attached to this grazing permit.

Actual use data on all pastures must be submitted to this office within 15 days from the last day of use.

Pursuant to 43 CFR 10.4(g) the holder of this authorization must notify the authorized officer, by telephone, with written confirmation, immediately upon the discovery of human remains, funerary items, sacred objects, or objects of cultural patrimony. Further, pursuant to 43 CFR 10.4(c) and (d), you must stop activities in the immediate vicinity of the discovery and protect it from your activities for 30 days or until notified to proceed by the authorized officer.

Supplemental feeding is limited to salt, mineral, and/or protein supplements in block, granular, or liquid form. Such supplements must be placed at least ¼ mile from live waters (springs and streams), troughs, wet or dry meadows, and aspen stands.

All riparian enclosures, including spring development enclosures, are closed to livestock use unless specifically authorized in writing.

Payment of grazing fees is due on or before the due date specified on the grazing bill. Failure to pay the grazing bill within 15 days of the due date specified on the bill shall result in a late fee assessment of \$25.00 or 10 percent of the grazing bill, whichever is greater, but not to exceed \$250.00.

The term of this permit would be from March 1, 1999 to February 28, 2000.

Signed: _____

Date: _____

BIG SPRINGS ALLOTMENT

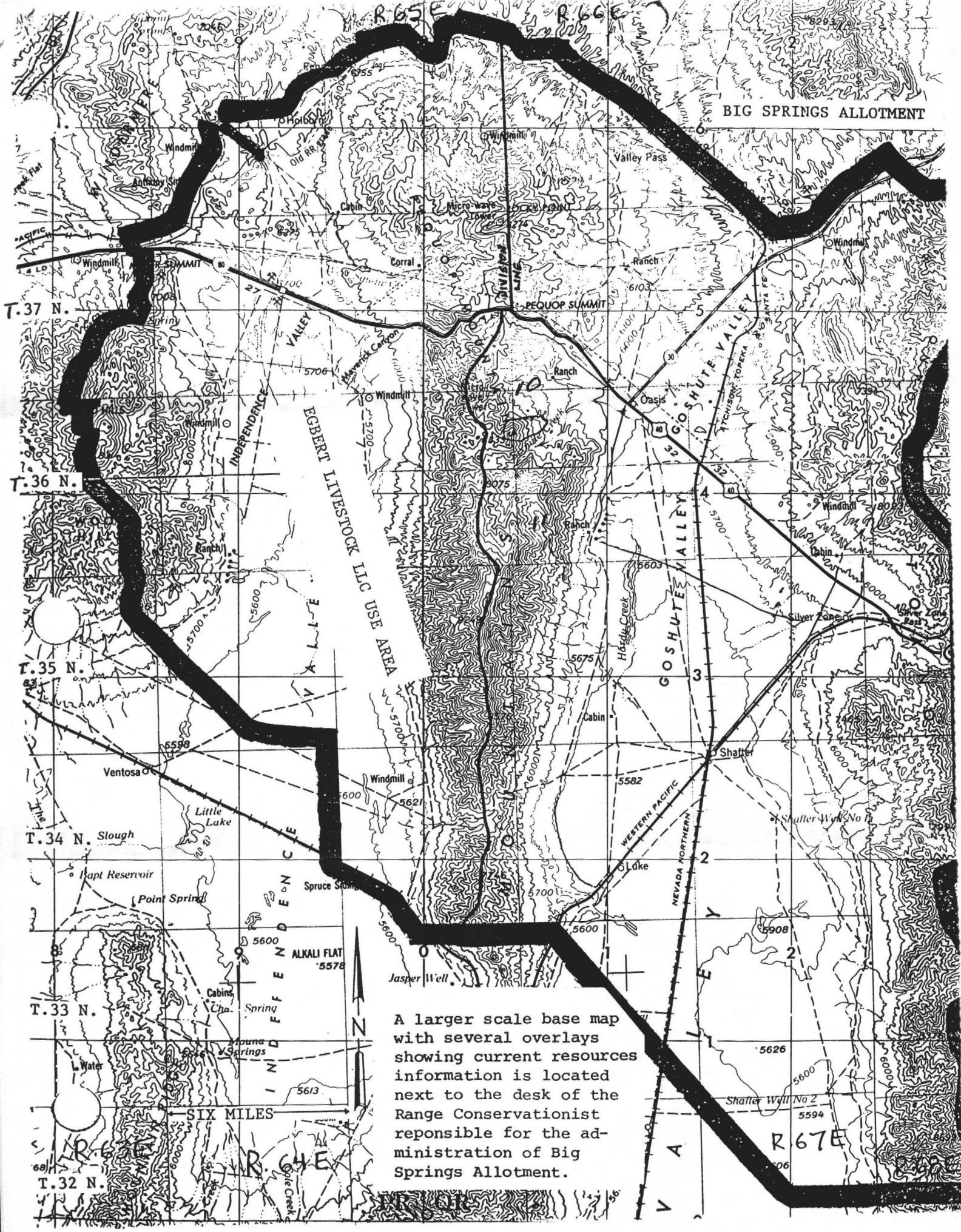

EGBERT LIVESTOCK LLC USE AREA

A larger scale base map with several overlays showing current resources information is located next to the desk of the Range Conservationist responsible for the administration of Big Springs Allotment.

R 67 E