

L 3/26/98



United States Department of the Interior

BUREAU OF LAND MANAGEMENT
Elko Field Office
3900 East Idaho Street
Elko, Nevada 89801-4611

The Wells WH RMP Amendment established a 10% use on winter range prior to livestock. We assume from this notice that wildhorses are below AUM.

In Reply Refer To:
4120 (NV-012)

MAR 26 1998

sucker !

Dear Interested Public:

In accordance with the Grazing Regulations, "... the authorized officer shall consult, cooperate and coordinate with affected permittees or lessees, the State having lands or responsible for managing resources within the area, and the interested public prior to issuance of nonrenewable grazing permits and leases" (43 CFR 4130.6-2).

On March 17, 1998 William and Elizabeth Dickinson applied to graze 205 cows on the Juniper Seeding in the North Butte Valley Allotment starting 4/15/98. The Wells Resource Management Plan (RMP) describes the livestock grazing period of use in the North Butte Valley Allotment as 5/1 to 12/22. An allotment evaluation was completed in 1989, and a grazing agreement was signed on 2/20/90. The season of use outlined for the Juniper Seeding this year is from 5/1 to 6/20. However applications for early turnout into the seedings in the North Butte Valley Allotment have been approved the past few years. The permitted use in the North Butte Valley Allotment is 1,645 AUMs. Although the application requests an early turnout, total AUMs of use would not exceed permitted use.

The North Butte Valley Allotment is a medium sized cattle grazing allotment located in the northern portion of Butte Valley, approximately 50 miles south of Wells, Nevada. The Juniper Seeding is located in the northern portion of the allotment (see attached map). A portion of the Maverick/Medicine Herd Management Area (HMA) occurs within this allotment. This allotment receives only incidental to light use by wild horses. Crested wheatgrass provides most of the forage in this pasture and there are no streams or springs in this pasture. The permittee uses a pipeline in the Juniper Seeding to water his livestock. Approval of the grazing application is consistent with multiple use objectives for this allotment.

In addition to the existing terms and conditions, the following term and condition will apply:

The early turnout (4/15/98 through 4/31/98) is authorized as change in period of use, and will not result in a permanent change to your grazing permit.

If you have any comments regarding the approval or denial of this application, please provide them to this office within 15 days of the date of this letter.

If you have any questions, please call Bruce Thompson at (702) 753-0200.

Sincerely yours,

A handwritten signature in black ink, appearing to read "Clinton R. Oke", with a horizontal line underneath.

CLINTON R. OKE, Assistant District Manager
Renewable Resources

Enclosure: As stated above

cc: William and Elizabeth Dickinson
Animal Protection Institute
Commission for the Preservation of Wild Horses
Elko Board of County Commisioners
Natural Resources Conservation Service
Nevada Cattlemens Assoc./Nevada Land Action Assoc.
Nevada Division of Wildlife - Elko
Nevada Woolgrowers Association
Resource Concepts, Inc.
Paul Bottari
US Fish and Wildlife Service
Wells Resource Area Grazing Assoc.

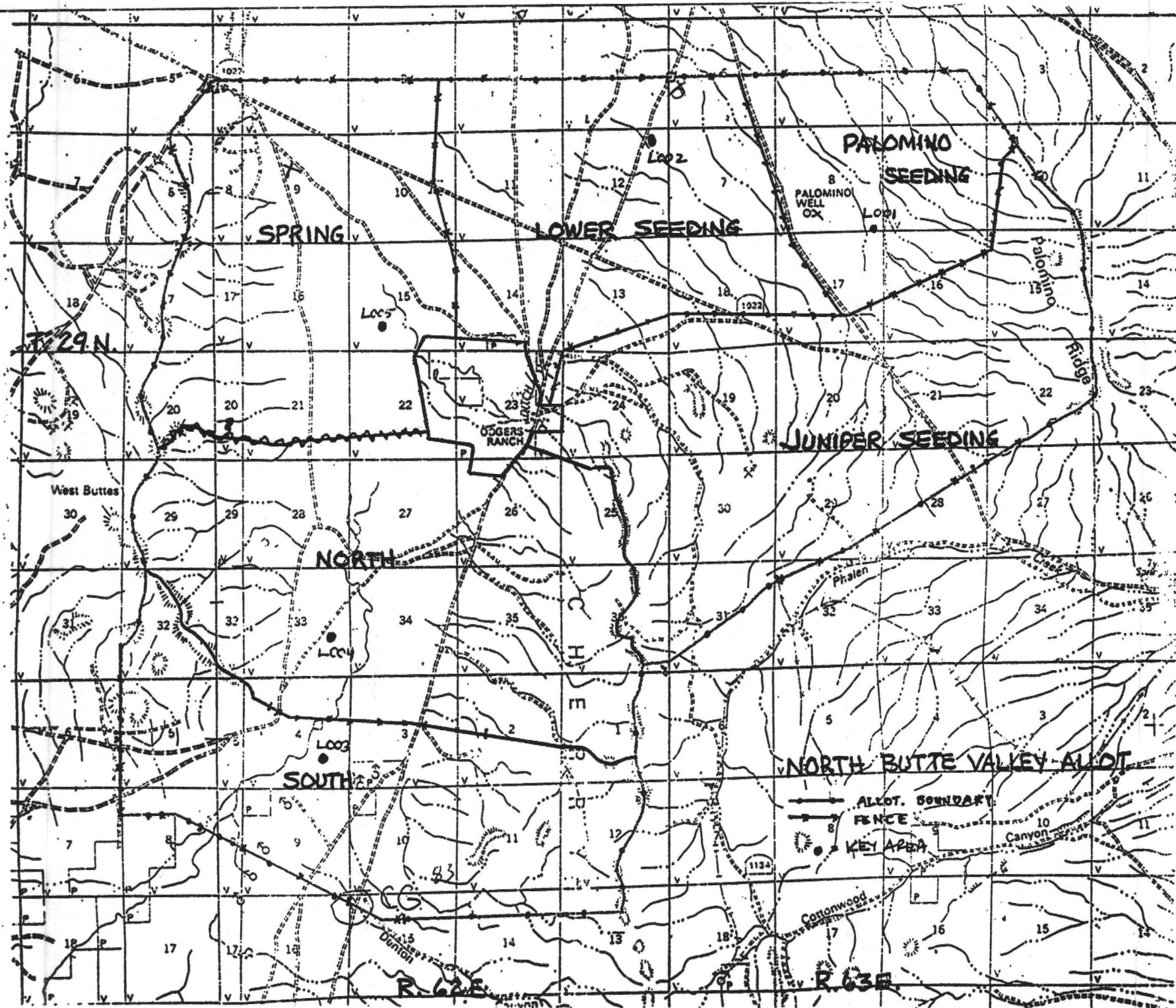



DEPARTMENT OF CONSERVATION AND NATURAL RESOURCES
COMMISSION FOR THE
PRESERVATION OF WILD HORSES

123 W. Nye Lane, Room 248

Carson City, Nevada 89706-0818

Phone (702) 687-1400 • Fax (702) 687-6122

April 2, 1998

Clinton Oke, Assistant District Manager
BLM-Elko Field Office
3900 East Idaho Street
Elko, Nevada 89801-4611

Dear Mr. Oke,

Thank you for the opportunity to review and comment on the early turnout for the North Butte Valley Allotment.

The Wells Wild Horse RMP Amendment established a 10% use on winter range prior to livestock. From this document we must assume that with allowing the early use that habitat, that wild horses are below AML. Please correct us if we are wrong.

If you have any questions, please feel free to call.

Sincerely,

A handwritten signature in cursive script that reads "Catherine Barcomb".

CATHERINE BARCOMB
Administrator