

United States
Department of
Agriculture

Forest
Service

Humboldt
National
Forest

Ely Ranger District
P.O. Box 539
Ely, Nevada 89301

FS -
Quinn

F.S. Ely

3/20/87

Reply To:2260

Date:3/20/87

Commission for the Preservation of Wild Horses
c/o Terri Jay, Executive Director
625 Fairview, Suite 111
Carson City, Nevada 89701

Dear Ms. Jay,

The recently completed Humboldt National Forest Land and Resource Management Plan has as one of its goals, "to manage the Quinn Wild Horse Territory in accordance with the Wild Horse and Burro Act and the approved territory plan." We have not yet completed the management plan for the Quinn Wild Horse Territory and that is the reason for my letter to you. A plan will be written this year to guide management of the Quinn Wild Horse Territory.

The Quinn Wild Horse Territory is located on the southwest corner of the Quinn Canyon division on the Ely Ranger District. I have included a map with this letter showing the territory boundary. The total size of the territory is 26,661 acres, 20 percent of which is suitable for use by horses. The condition of the soil and vegetation resources breaks down as follows: 21 percent fair, 66 percent poor, 13 percent very poor.

Because of the generally poor/very poor condition class of the range resource, our main objectives will be to manage cattle and wild horses in such a way that range resources improve to good or better condition.

Actions are currently underway to get a hold on the cattle grazing within the portions of two allotments located in the proposed Quinn Wild Horse Territory (attached map). The two grazing allotments are Big Creek allotment and Pine Creek-Quinn Canyon allotment.

The Big Creek allotment is scheduled for 5 years of complete rest from cattle grazing starting in 1988 with a decision being made 5 years hence, to continue allowing cattle grazing in this allotment or to end cattle grazing. If cattle grazing is allowed at the end of 5 years rest, then it is expected that it will be reduced from the current permitted AUM's. Currently we are fencing boundaries of the allotment and plan completion of the majority of fences by this summer.

The Pine Creek-Quinn Canyon allotment is currently managed under an approved Grazing Management Plan. Approximately 40-50 cattle graze this area each summer. Some fencing needs to be completed along the southwestern corner of

Quinn Canyon in order to control trespass stock from the BLM. This fencing is scheduled for completion by 1988. Some adjustment will be needed to bring permitted use into line with capacity.

The anticipated stocking level for the Wild Horse Territory is no wild horses for at least the next 5 years, in order to allow for range resource recovery in conjunction with permitted livestock reductions. Following improvement of the range resource to good or better condition, which is expected to take longer than 5 years, the territory will be stocked with 12-16 wild horses. The population of this territory has been estimated at 8-12 horses during the past 10 years based on arial and ground counts.

I would like to ask you for your input into preparation of the management plan for this territory, particularly your concerns over population goal numbers, needed improvements such as water developments, monitoring needs, and the need for a field trip to the territory.

If you would like further information about the territory please contact Mike Lawrence at my office in Ely, Nevada at 702-289-3031 or write to him at the address above.

I would like to receive any comments that you might have regarding management of the Quinn Wild Horse Territory. Please send your comments to me or Mike Lawrence by April 17, 1987. Thank you very much.

Sincerely,



RENE P. DEMEULE
District Ranger

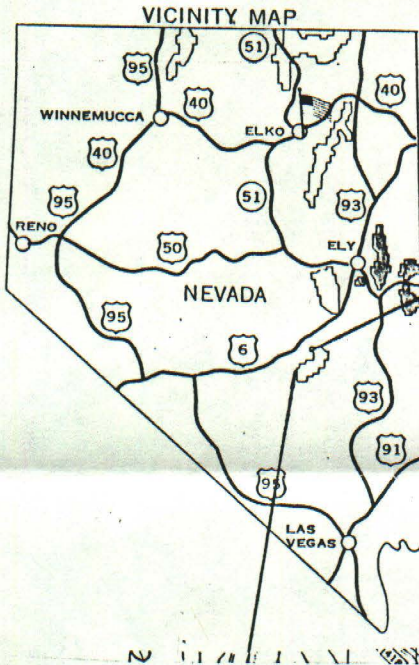

T. 5 N.

BIG CREEK ALLOTMENT

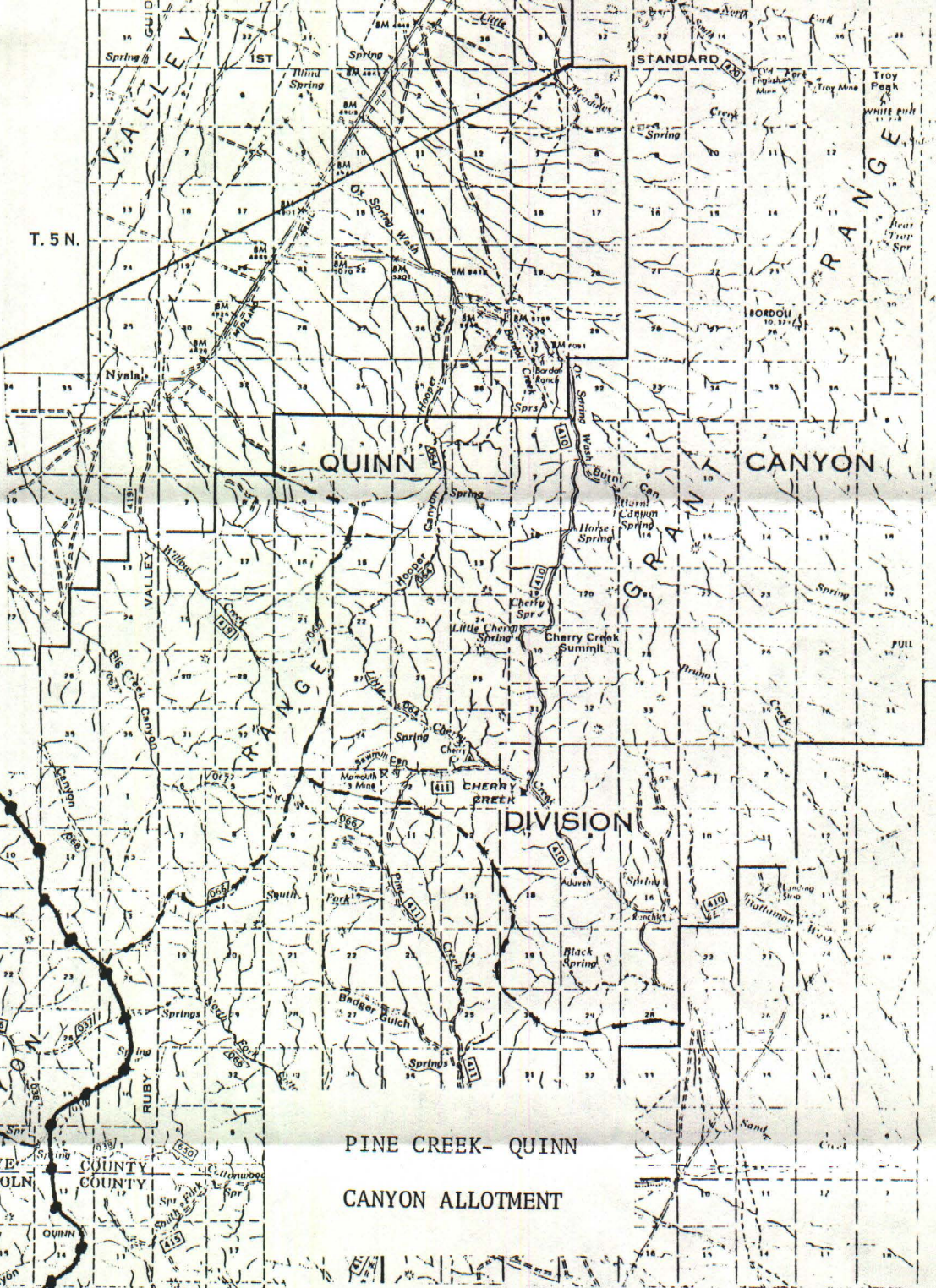
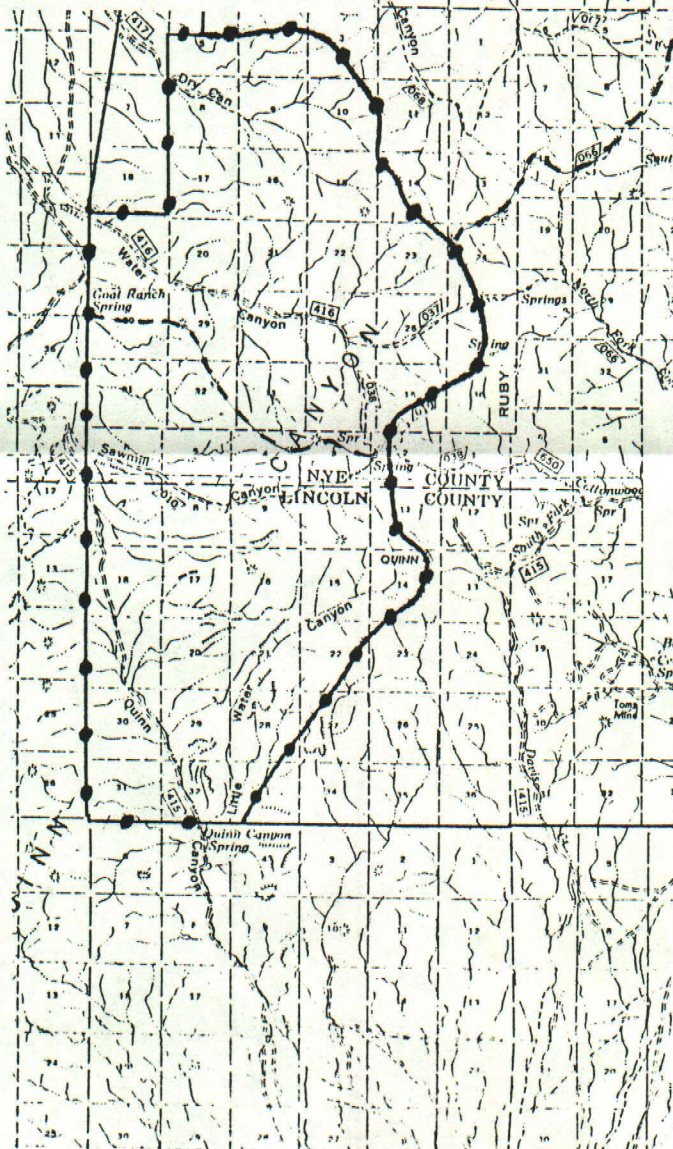

PINE CREEK- QUINN
CANYON ALLOTMENT

FIGURE I. Location of the Quinn Wild Horse Territory, Ely Ranger District.

- - - Allotment Boundary
- Territory Boundary

Scale: .28 in. = 1 mile
Mount Diablo Meridian
M. Lawrence 3/87