

a: North Butte TMR 3/6/97



United States Department of the Interior

BUREAU OF LAND MANAGEMENT

Elko Field Office
3900 East Idaho Street
Elko, Nevada 89801-4611

In Reply Refer To:
4120 (NV-010)

*Received
3/13/97*

MAR 6 1997

Dear Interested Public:

In accordance with the Grazing Regulations, "... the authorized officer shall consult, cooperate and coordinate with affected permittees or lessees, the State having lands or responsible for managing resources within the area, and the interested public prior to issuance of nonrenewable grazing permits and leases" (43 CFR 4130.6-2).

On February 12, 1997, William and Elizabeth Dickinson applied to graze 205 cows on the Palomino Seeding in the North Butte Valley Allotment starting 4/16/97. The Wells Resource Management Plan (RMP) describes the livestock grazing period of use in the North Butte Valley Allotment as 5/1 to 12/22. An allotment evaluation was completed in 1989, and a grazing agreement was signed on 2/20/90. No modification was made to the period of use. However applications for early turnout into the seedings in the North Butte Valley Allotment have been approved the past few years. The permitted use in the North Butte Valley Allotment is 1,645 AUMs. Although the application requests an early turnout, total AUMs of use would not exceed permitted use.

The North Butte Valley Allotment is a medium sized cattle grazing allotment located in the northern portion of Butte Valley, approximately 50 miles south of Wells, Nevada. The Palomino Seeding is located in the northeast portion of the allotment (see attached map). A portion of the Maverick/Medicine Herd Management Area (HMA) occurs within this allotment. This allotment receives only incidental to light use by wild horses. Crested wheatgrass provides most of the forage in this pasture and there are no streams or springs in this pasture. The permittee uses a well in the Palomino Seeding to water his livestock. Approval of the grazing application is consistent with multiple use objectives for this allotment.

In addition to the existing terms and conditions, the following term and condition will apply:

The early turnout (4/16/97 through 4/31/97) is authorized as a temporary deviation from the permit dates for the William and Elizabeth Dickinson grazing permit.

If you have any comments regarding the approval or denial of this application, please provide them to this office within 15 days of the date of this letter. If you have any questions, please call Bruce Thompson at (702) 753-0200.

Sincerely yours,

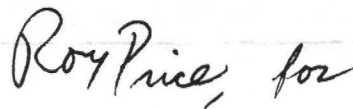
A handwritten signature in cursive script that reads "Roy Price, for".

CLINT R. OKE
Assistant District Manager
Renewable Resources

Enclosure: As stated above

cc: William and Elizabeth Dickinson
American Horse Protection Association, Inc.
Animal Protection Institute
Commission for the Preservation of Wild Horses
Kathryn Cushman
Elko Board of County Commissioners
Cliff Gardner
Humane Society of the US
Kenneth Jones
Natural Resources Defense Council
The Nature Conservancy
Nevada Cattlemens Association
Nevada Dept. of Agriculture
Nevada Division of Environmental Protection
Nevada Division of Wildlife
Bertrand Paris & Sons
Rutgers School of Law
Sierra Club, Toiyabe Chapter
US Fish and Wildlife Service
Wells Res. Area Grazing Assn.
Wild Horse Organized Assistance

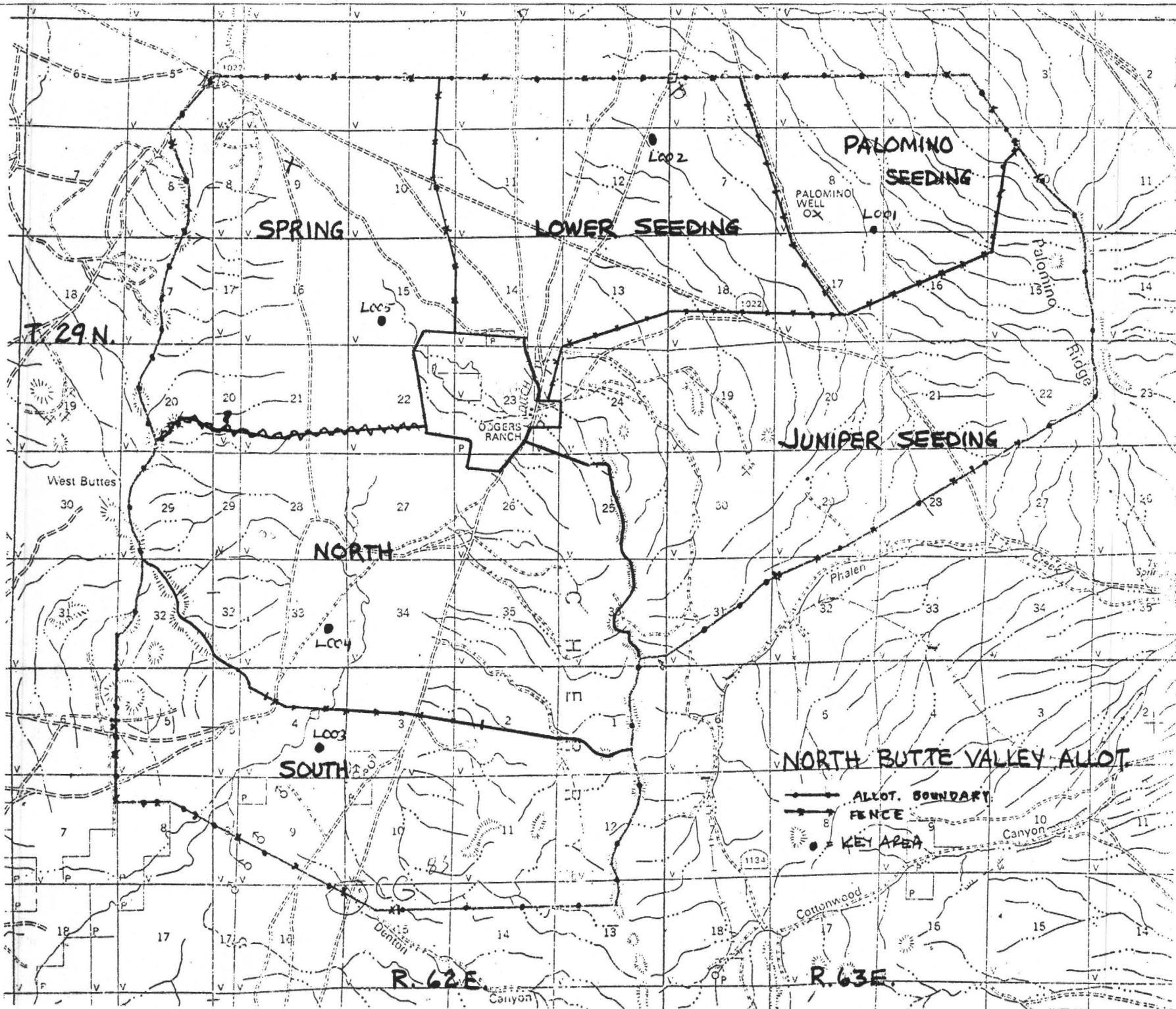

T. 29 N.

SPRING

LOWER SEEDING

PALOMINO SEEDING

JUNIPER SEEDING

NORTH

SOUTH

NORTH BUTTE VALLEY ALLOT.

- ALLOT. BOUNDARY
- FENCE
- KEY AREA

R. 62 E.

R. 63 E.



COMMISSION FOR THE
PRESERVATION OF WILD HORSES

1105 Terminal Way

Suite 209

Reno, Nevada 89502

(702) 688-2626

April 1, 1997

Ms. Helen Hankins
Elko District
Bureau of Land Management
3900 East Idaho Street
P.O. Box 831
Elko, Nevada 89803

Subject: TNR - North Butte - Maverik/Medicine HMA

Dear Ms. Hankins:

Thank you for consulting the Commission for the Preservation of Wild Horses concerning the issuance of temporary use of the seeding in the North Butte Allotment. As you are aware, the Wells Wild Horse Amendment established a 10% use limit to key winter ranges for the Maverick/Medicine Herd.

It is encouraging that the District issued a multiple use decision for this allotment seven years ago; however, new additional data should be assessed for any adjustment to increase use. Though no environmental assessment was provided, we assume that the observed "light and incidental" use of wild horses suggest a need to increase wild horse numbers within this Herd Management Area.

We would appreciate the estimated actual use by wild horses and an estimated appropriate management level for this allotment.

Sincerely,

A handwritten signature in cursive script that reads "Catherine Barcomb".

CATHERINE BARCOMB
Executive Director