

BEAR CREEK SNOW COURSE

8100 ELEVATION

27 MEAS. @ 50 FT.

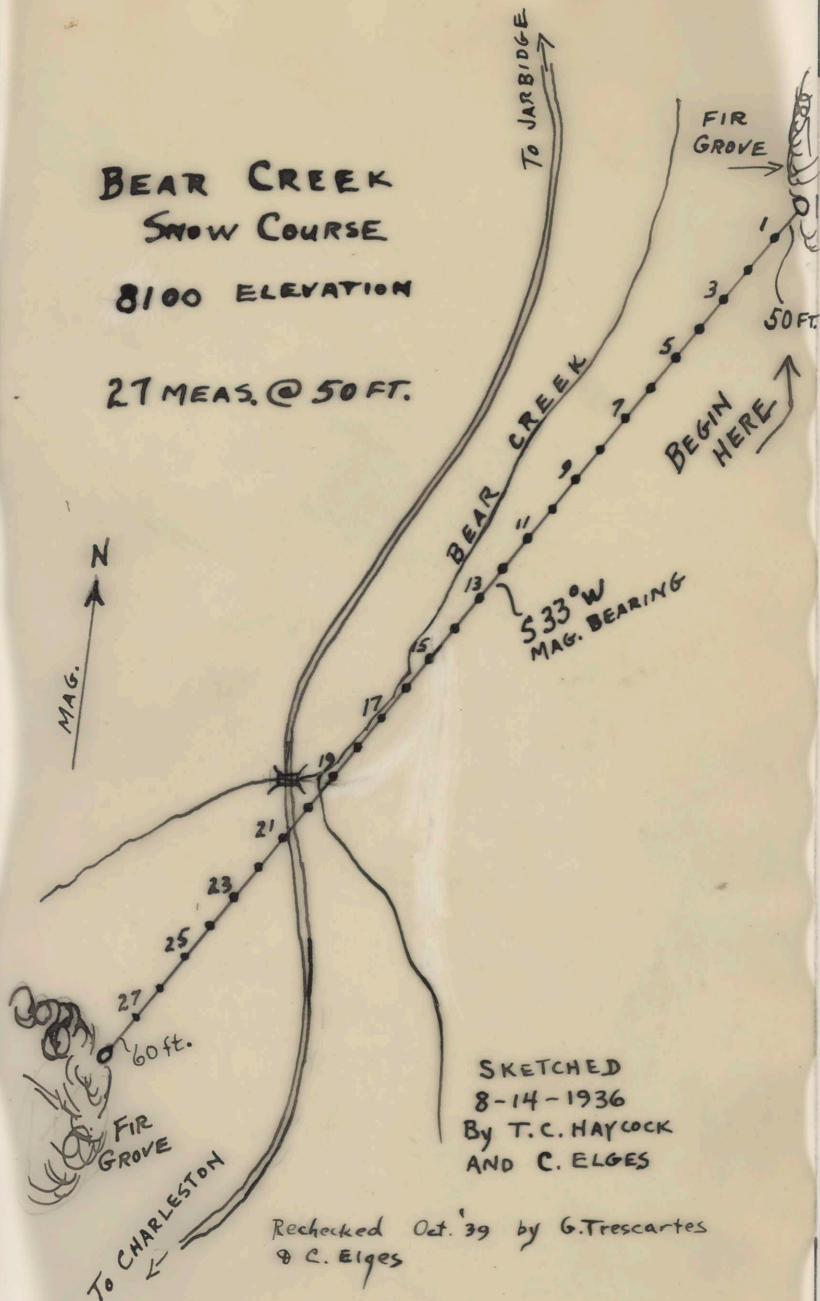

SKETCHED
8-14-1936
By T. C. HAYCOCK
AND C. ELGES

Rechecked Oct. '39 by G. Trescartes
& C. Elges

FOX CREEK SNOW COURSE

6900 ELEVATION

15 MEAS. @ 50 FT.

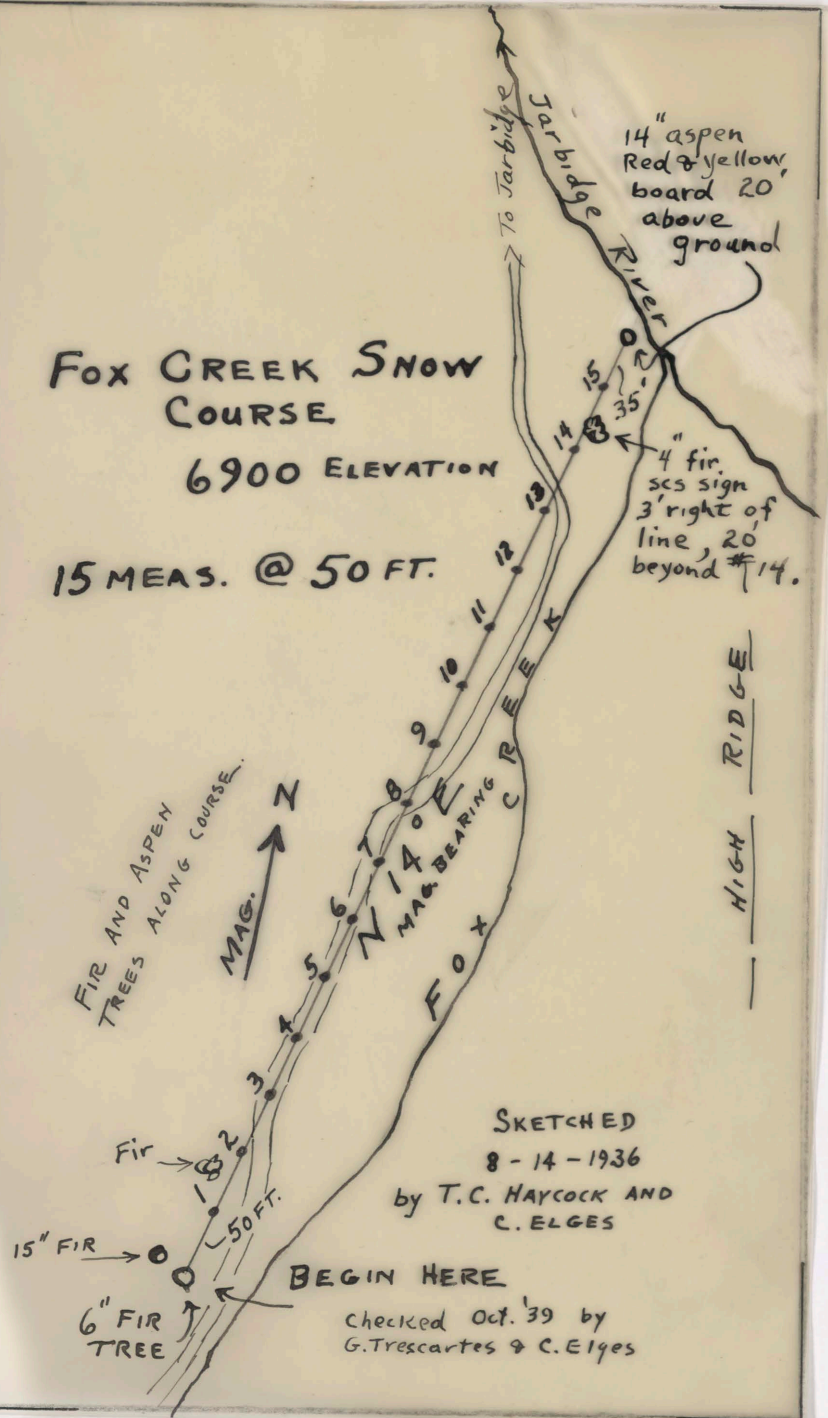

SKETCHED
8-14-1936
by T.C. HAYCOCK AND
C. ELGES

BEGIN HERE

checked Oct. '39 by
G. Trescartes & C. Elges

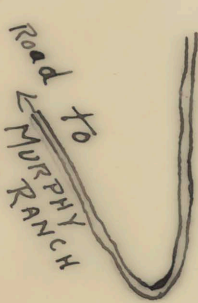

G. Aspen
Group
14
26
6" aspen
U.S.D.A. MARKER

DRY CREEK 6500

26 meas. @ 50 ft.

Mapped and
Marked by
G. TRES CARTES
and C. ELGES
October 23, 1938

DRY CREEK

low ridge

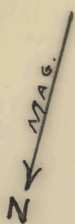

S 12° E
MAG.

4x4 post
U.S.D.A. MARKER

50'

BEGIN
HERE

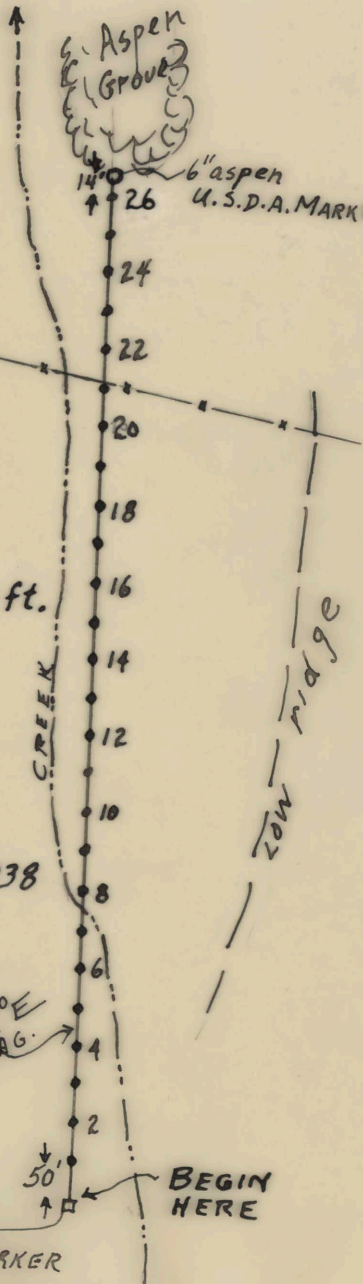

Laid out 10/30/39 by H. Dill
and C. Elges

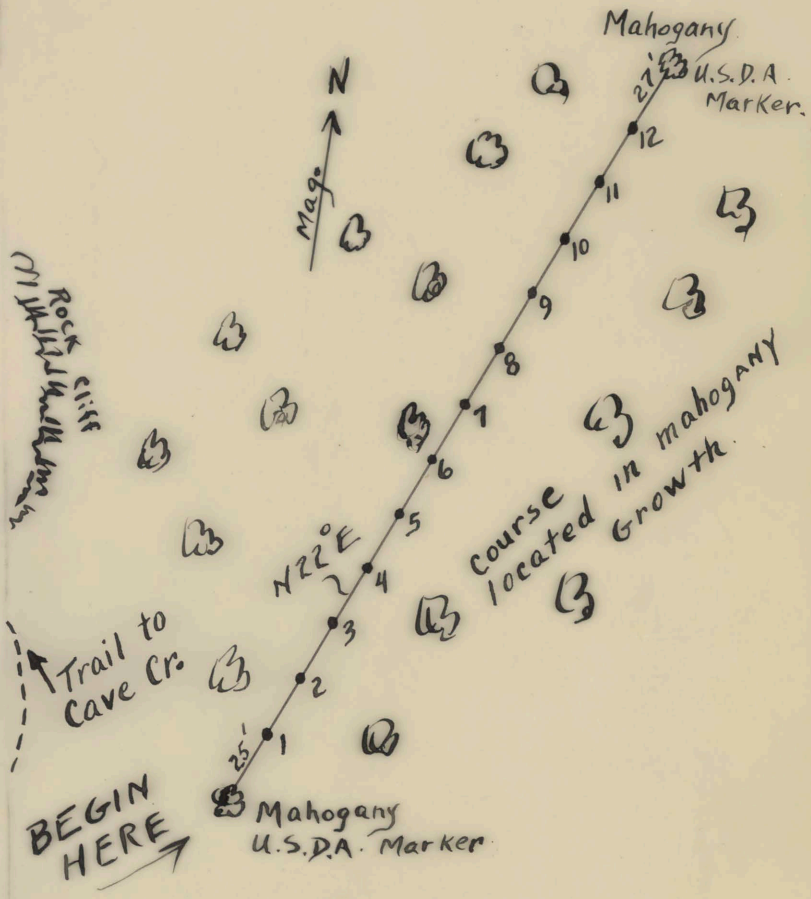

CAVE CREEK
12 meas @ 25 ft.
7000' ELEV.

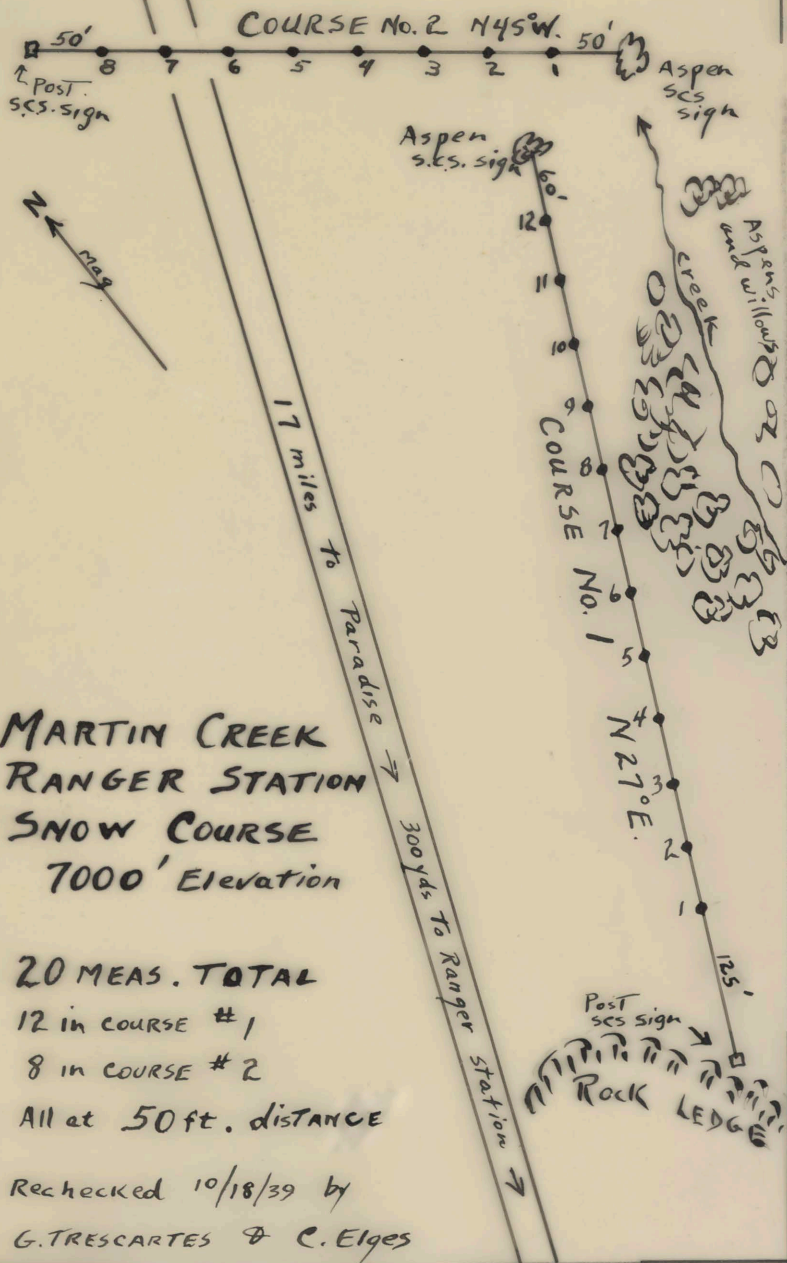

Laid out 10/30/39 by H. DILL
and C. Elges



HAGER CANYON

11 meas. @ 50 ft.

8500' ELEV.

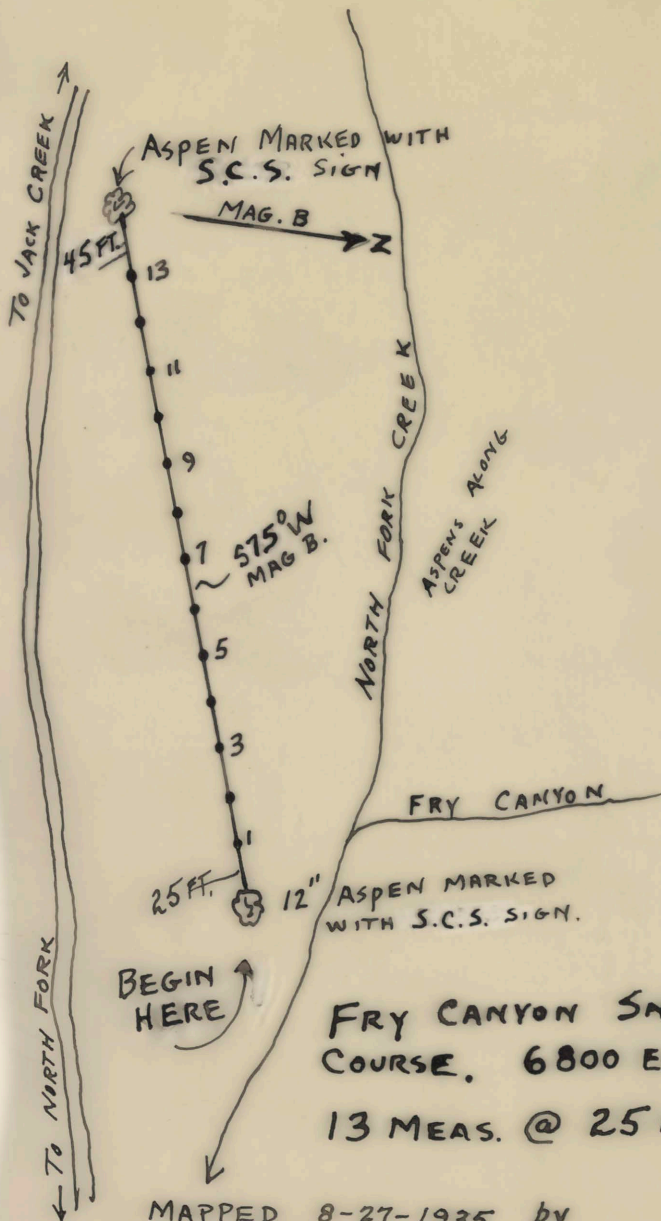

FRY CANYON SNOW COURSE. 6800 ELEV.
13 MEAS. @ 25 FT.

MAPPED 8-27-1935 by
 J.C. MARR & A. ROHWER
 RECHECKED OCT. '39 by C. ELGES & G. TRES CARTES

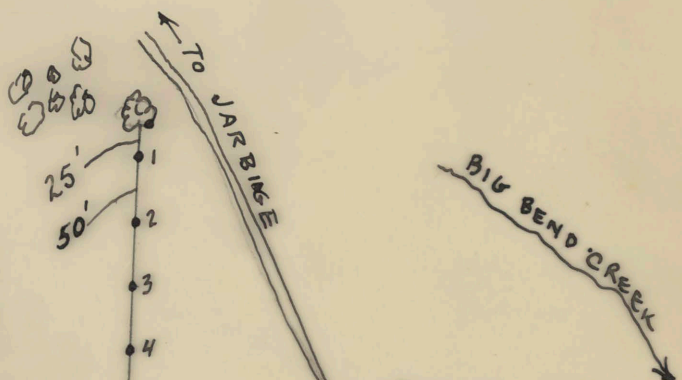

**BIG BEND
SNOW COURSE
6800 FT. ELEV.**

21 MEAS. @ 50 FT.

SKETCHED
8-27-1935
by J.C. MARR
& A. ROHWER

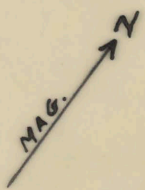

185' from
21 To END
POST

END
POST

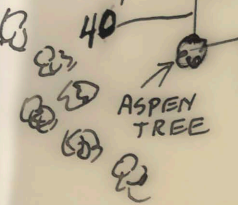

N39° E
MAG. B.

OLD PLACER
DITCH

1 1/2 MILE TO
GOLD R.S.

Rechecked Oct. '39
by C. Elges & G. Trescartes

"THE MEADOWS"

← TO TUSCARORA 12 MILES TO JUNCTION WITH GOLD CR. R. →

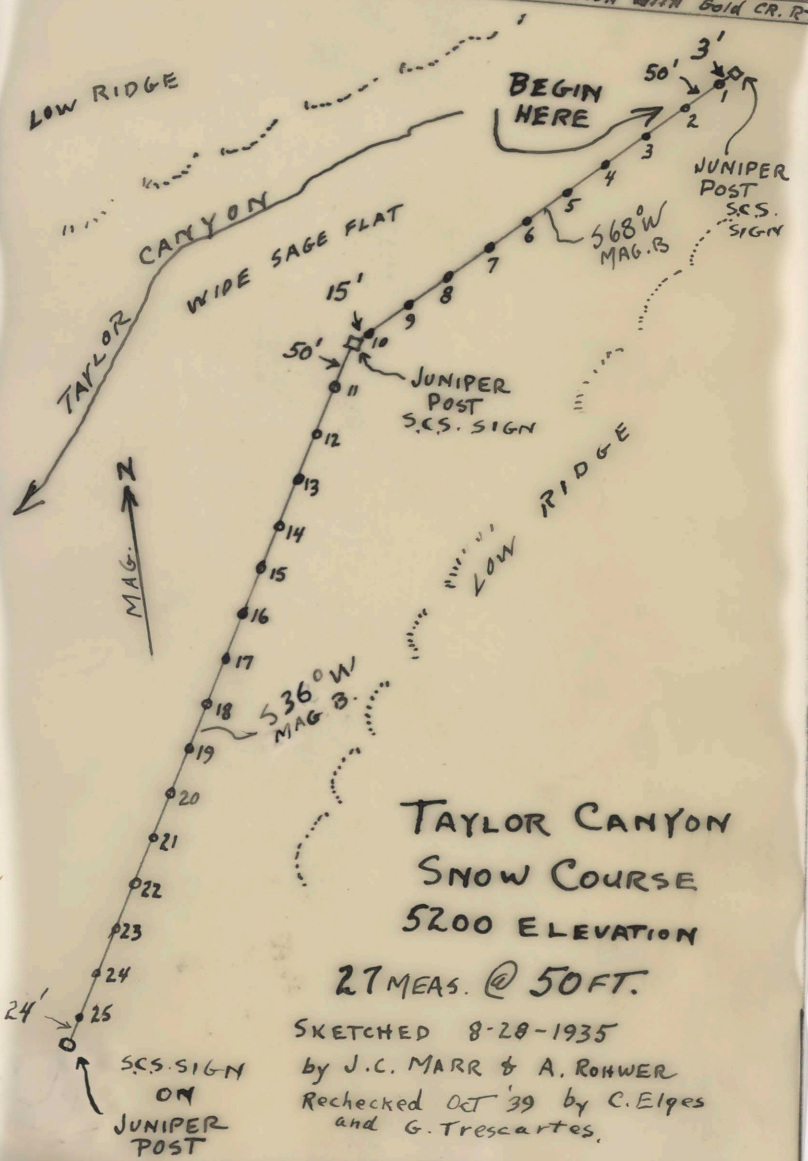

TAYLOR CANYON
SNOW COURSE
5200 ELEVATION

27 MEAS. @ 50 FT.

SKETCHED 8-28-1935
by J.C. MARR & A. ROHWER
Rechecked OCT '39 by C. Elges
and G. Trescartes.

LAMANCE CR. 7000' ELEV.

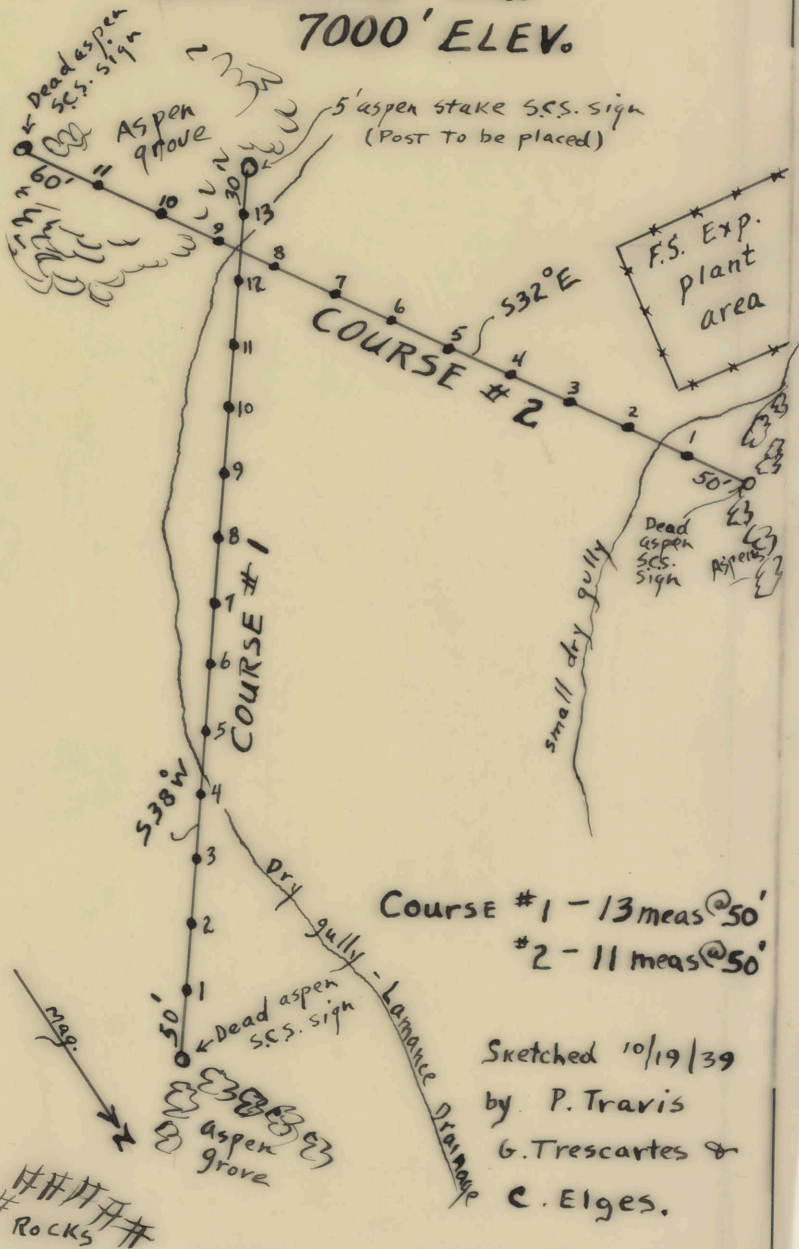

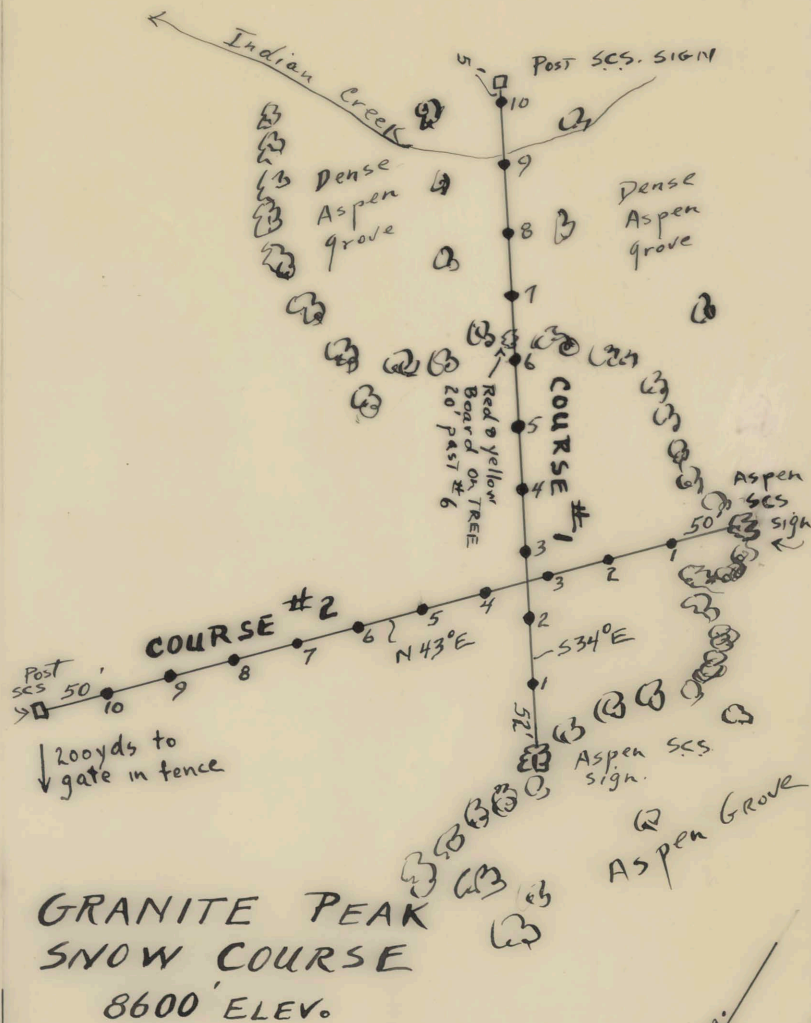

Rechecked 10/18/39
G. Trescartes & C. Elges

creek trib. to
Martin Cr.

LAMOILLE CANYON ROAD



1/4 MEAS. @ 50 FT.

LAMOILLE CREEK 7400

MAPPED & MARKED OCTOBER 9, 1938

By G. TRES CARTES & C. ELGES

2 aspens U.S.D.A. MARKER

4" Aspen U.S.D.A. MARKER 2' to right of line

Slight Angle at #9

clearing

Group of 4 Aspens 2' to left of line. U.S.D.A. MARKER.

Slight Angle at #3 and #5

4" Aspen U.S.D.A. MARKER

3 N 87° E MAG.

clearing

BEGIN HERE

15" MANOGANY U.S.D.A. MARKER

MAG. BEARING

50'

46'

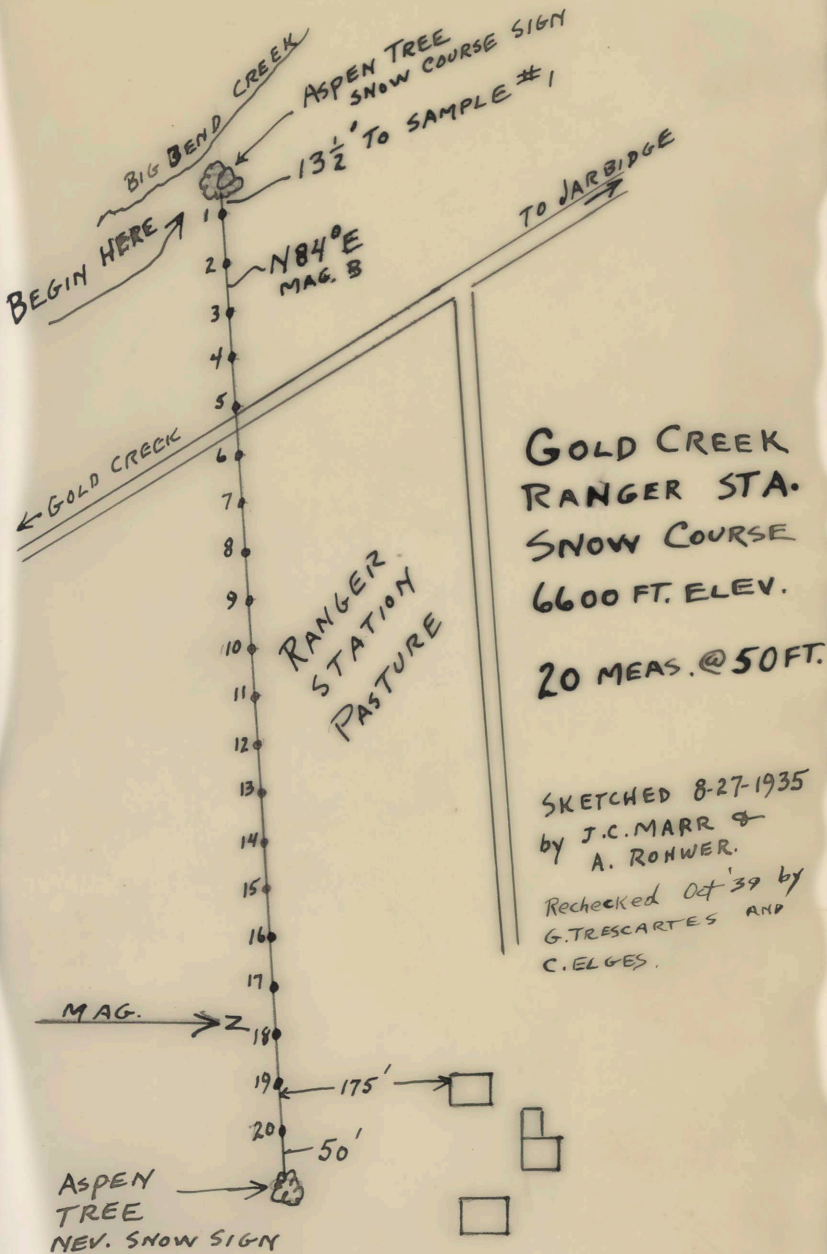

UPPER JACK CREEK SNOW COURSE

7800' Elev.

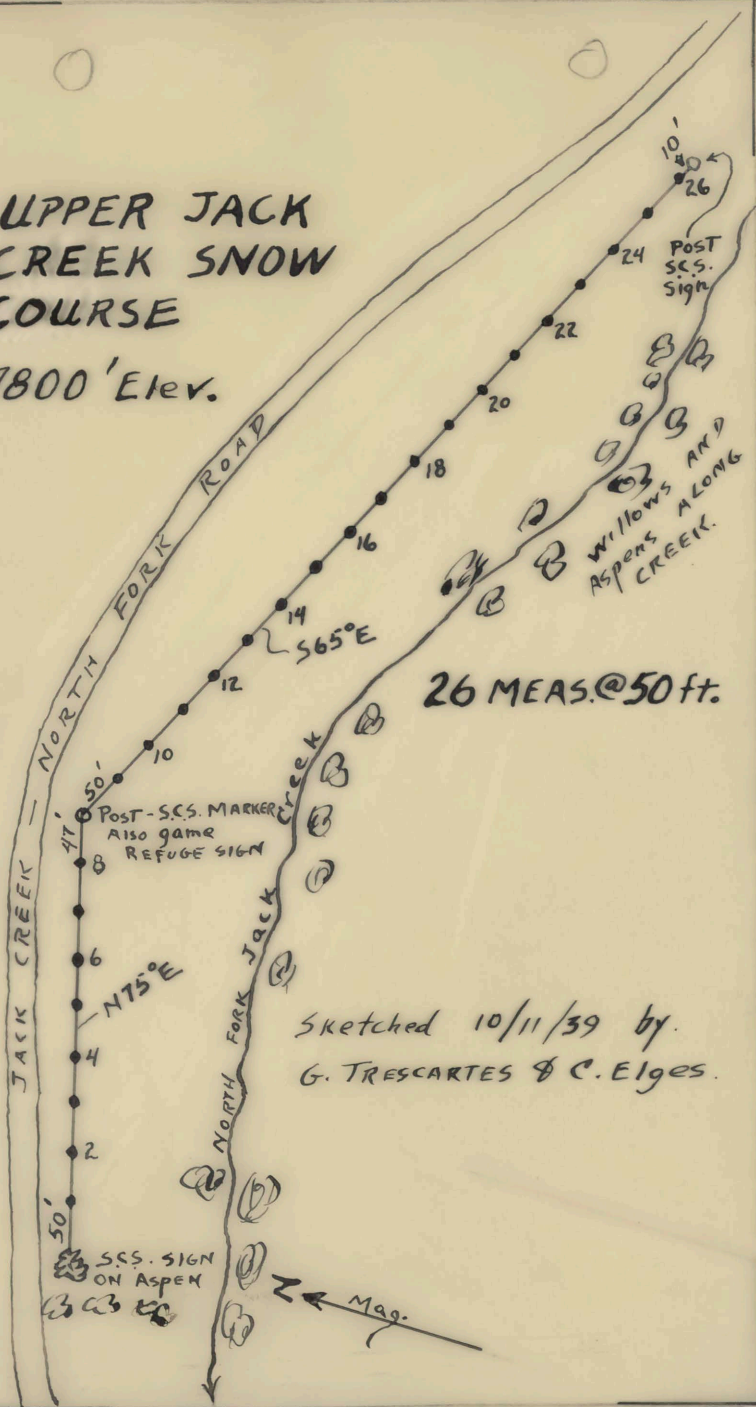

26 MEAS. @ 50 ft.

Sketched 10/11/39 by
G. TRES CARTES & C. ELGES.

LOWER JACK CREEK COURSE

located in hay field

12 MEAS @ 50 ft.

Sketched 10/11/39 by
C. Elges & G. Trescartes.

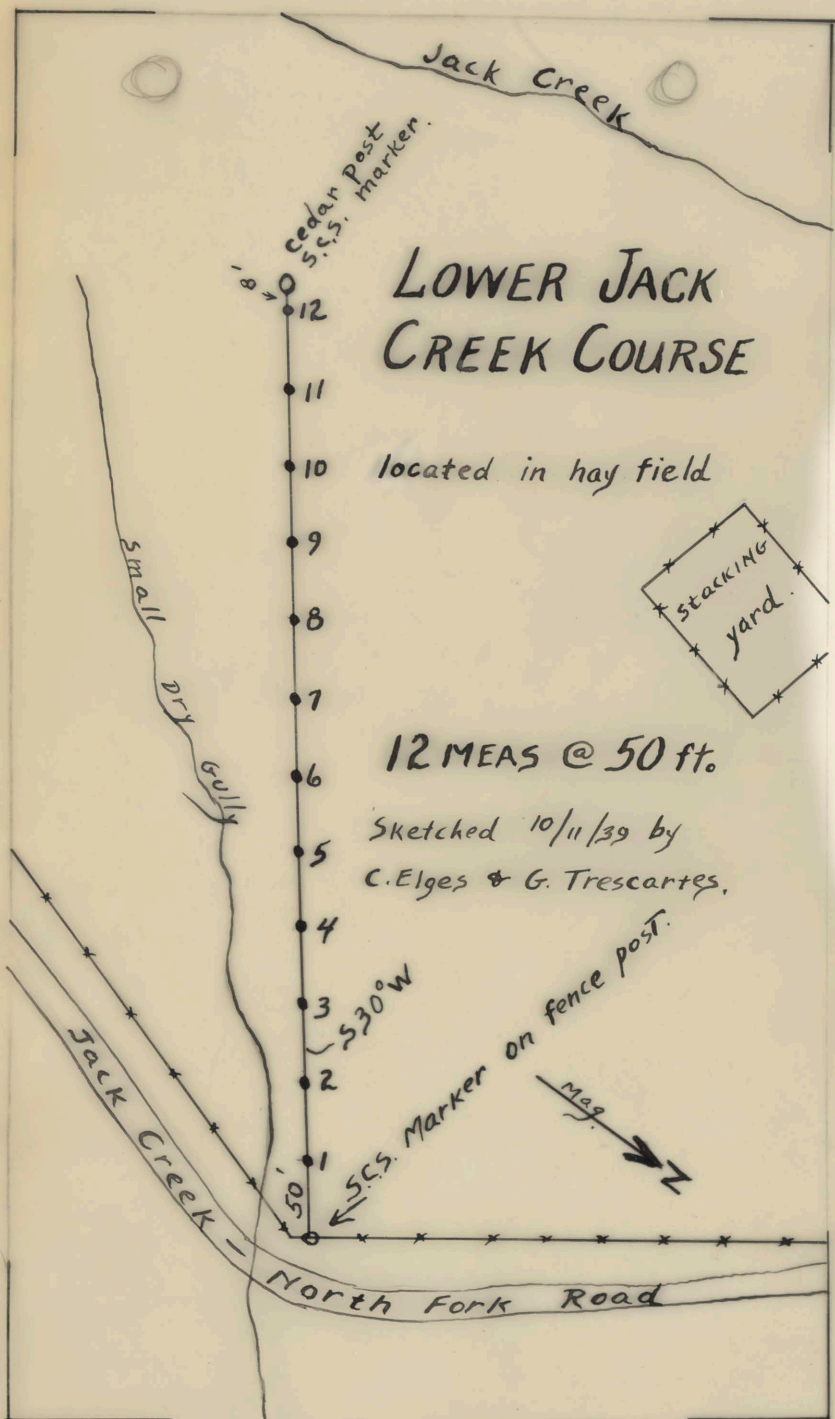

LAMOILLE TERRACE
 SNOW COURSE
 8500 Elev.

11 meas. @ 50ft.

laid out 10/23/39
 by G. Trescartes &
 C. Elges.

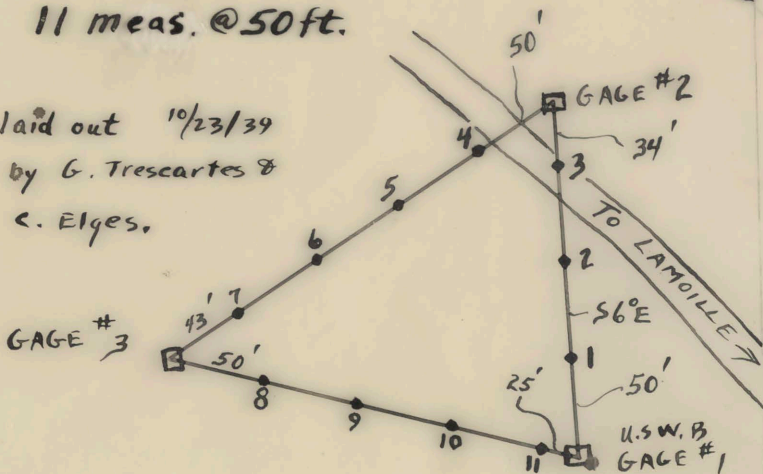

MAG.
 ↓
 2

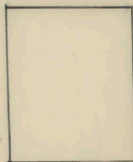

RANGER
 STATION

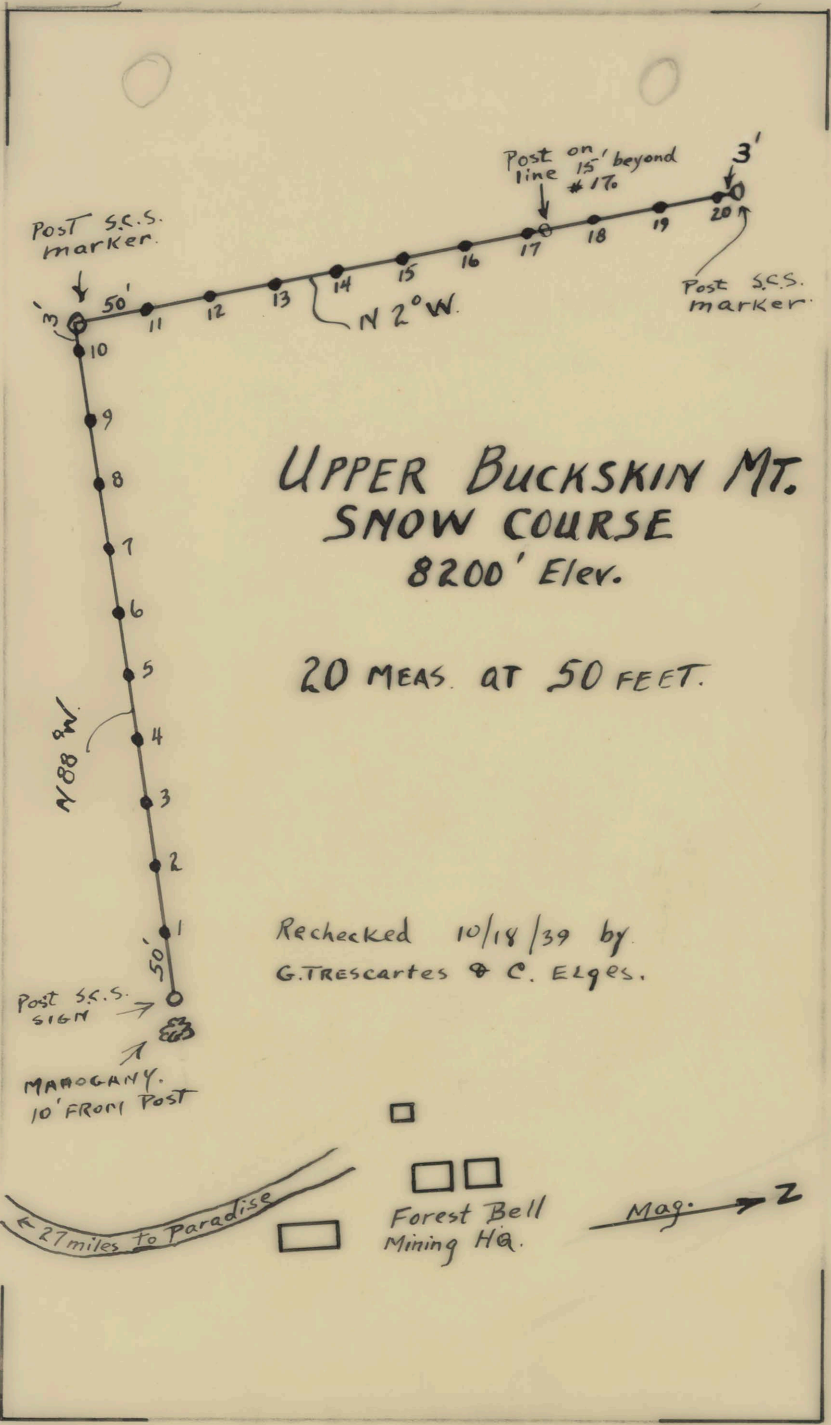

UPPER BUCKSKIN MT.
SNOW COURSE
8200' Elev.

20 MEAS. AT 50 FEET.

Rechecked 10/18/39 by
G. TRESCARTES & C. ELGES.

Post S.C.S.
516M →
↑
MAROGANY.
10' FROM POST

← 27 miles to Paradise

□
□ □
Forest Bell
Mining Hq.

Mag. → Z

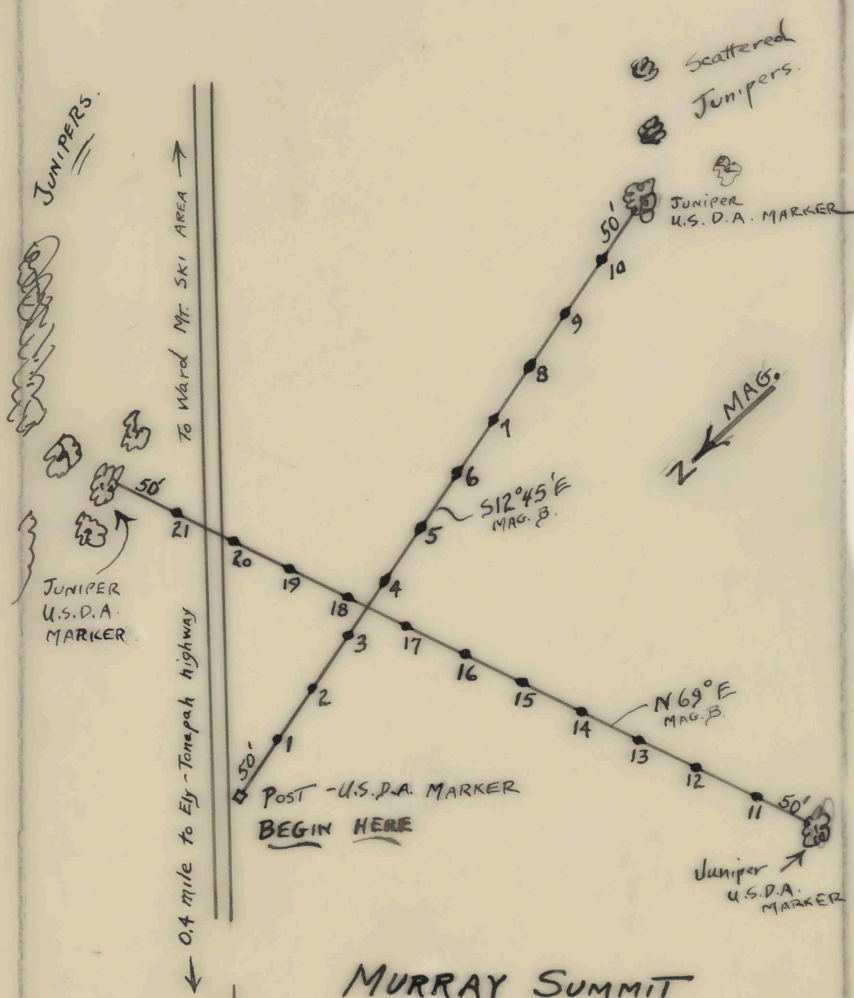

MURRAY SUMMIT SNOW COURSE

21 MEAS. @ 50 FT.

Laid out August 12, 1936 by
E.R. HILL & CARL ELGES.

ELEV = 7500 FT.

Nev. State highway No. 6

RYAN RANCH 5775

Mapped and Marked October 23, 1938
by G. TRES CARTES and C. ELGES

19 MEAS. AT 50 FT.

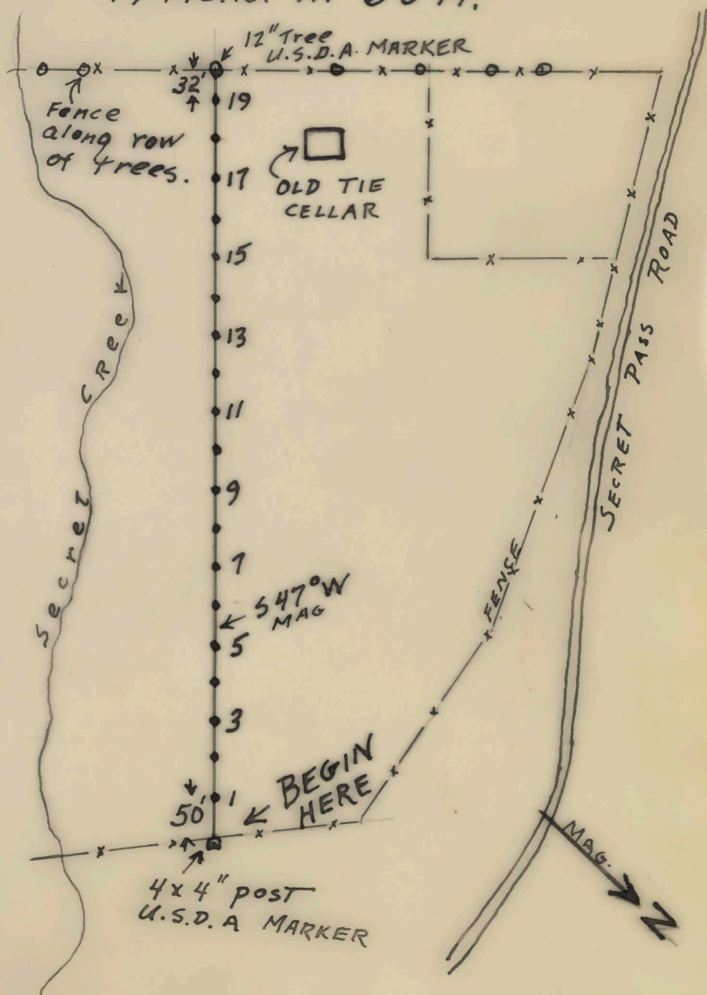

CEDAR Post, U. S. D. A. MARKER.

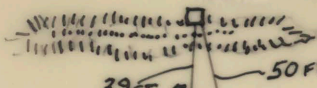

← Rocky ridge

N36°W
MAG.

8
9
10



4
5
6
3
2

S20°E
MAG.

11
12
13

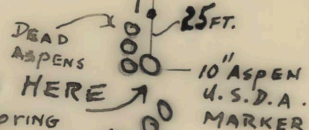

BEGIN HERE

Spring

DEAD ASPENS

14
15



DEAD CHOKES
CHERRIES

16

17

46 FT.

CEDAR Post
U. S. D. A. MARKER

HARRISON PASS No. 2. 7400

MARKED and MAPPED
October 25, 1938
by G. TRESKARTES & C. ELGES

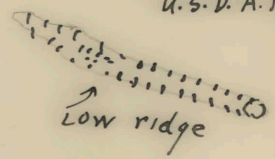

Low ridge

LAMOILLE CREEK 8100

MARKED AND MAPPED
OCTOBER 6, 1938
by G. TRES CARTES AND
C. ELGES.

15 MEAS. @ 50 FT.

COURSE LIES
ALONG OLD
FOREST SERVICE
TRAIL MAG. → Z

5" aspen
U.S.D.A. MARKER

8" aspen
U.S.D.A. MARKER

5" Mahogany 29' beyond
6. U.S.D.A. MARKER

12" MAHOGANY
8' from # 5

8" aspen 29' beyond # 3
U.S.D.A. MARKER

6" aspen 8' from # 2

6" aspen
12' from # 2

N 65° W.
MAG. BEARING

LARGE ROCK
Fence goes over
rock and is
visible from road

5" aspen U.S.D.A.

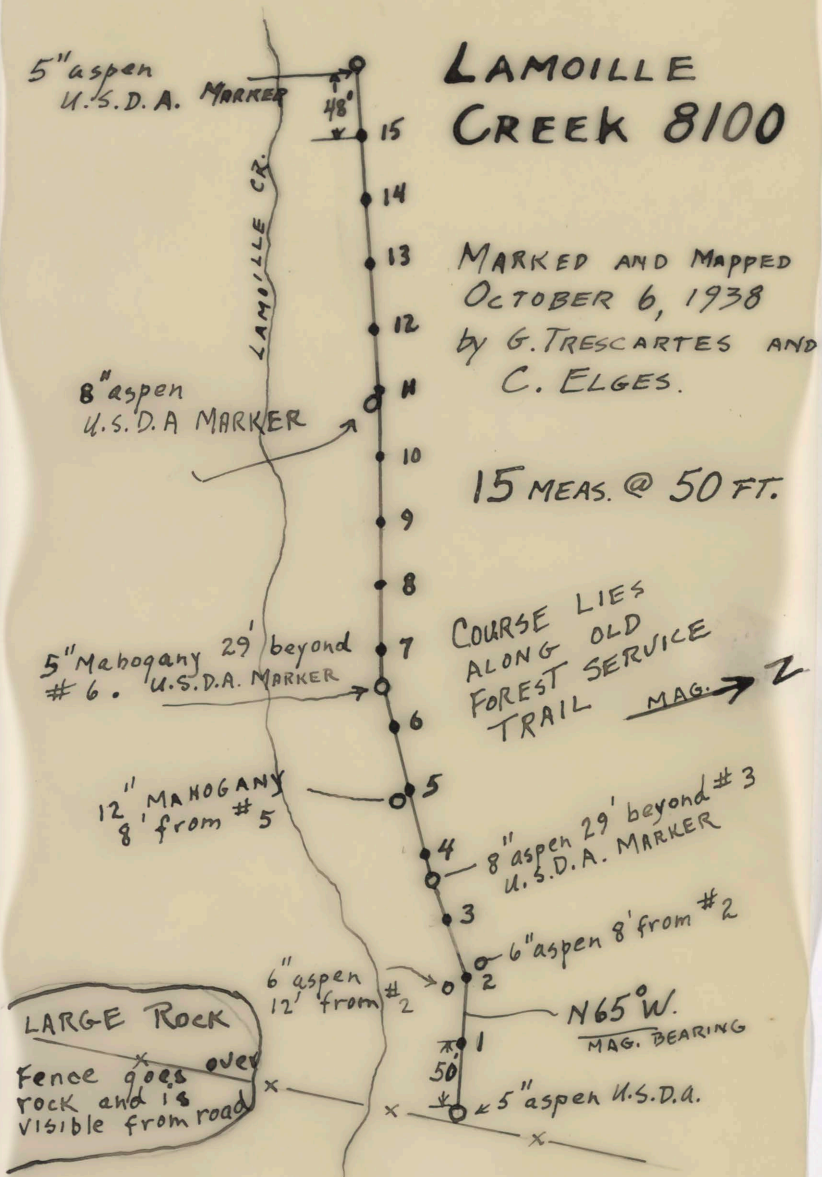

Harrison Pass # 1 6600

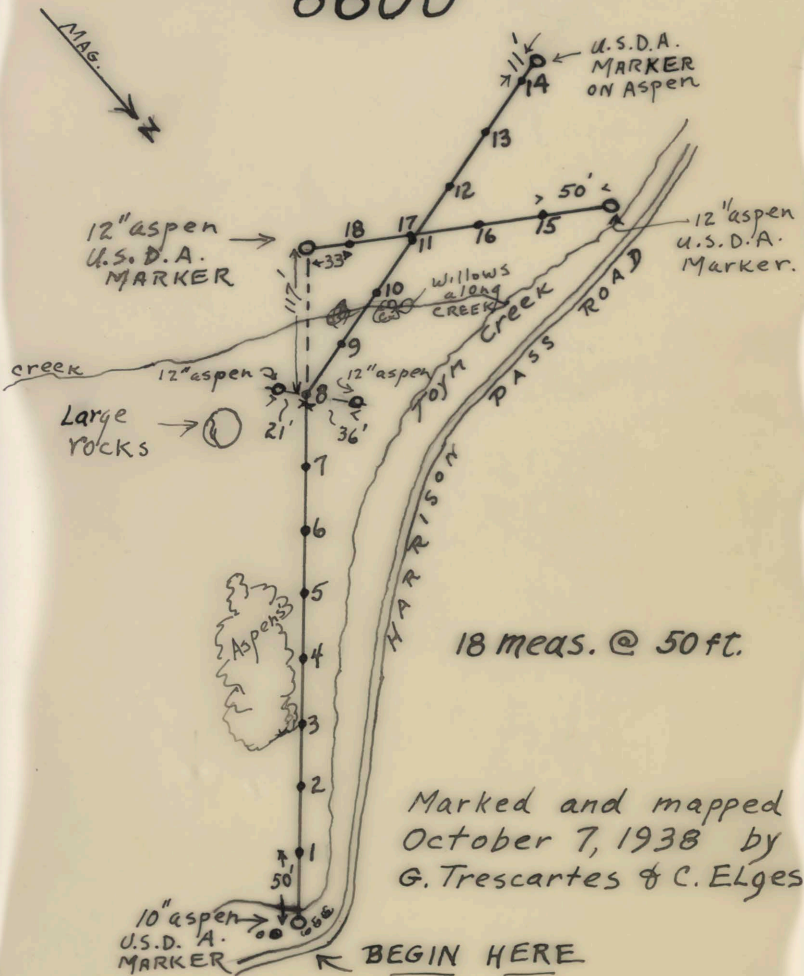

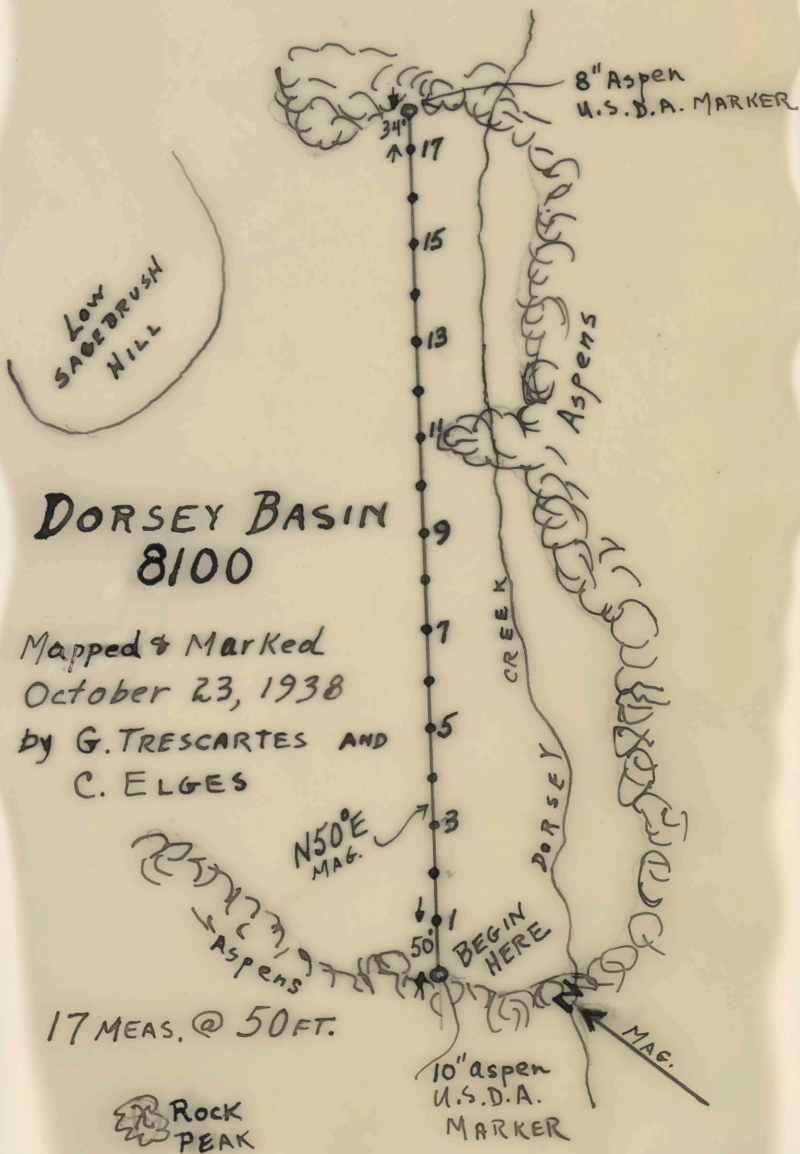

LAMOILLE CREEK 7600

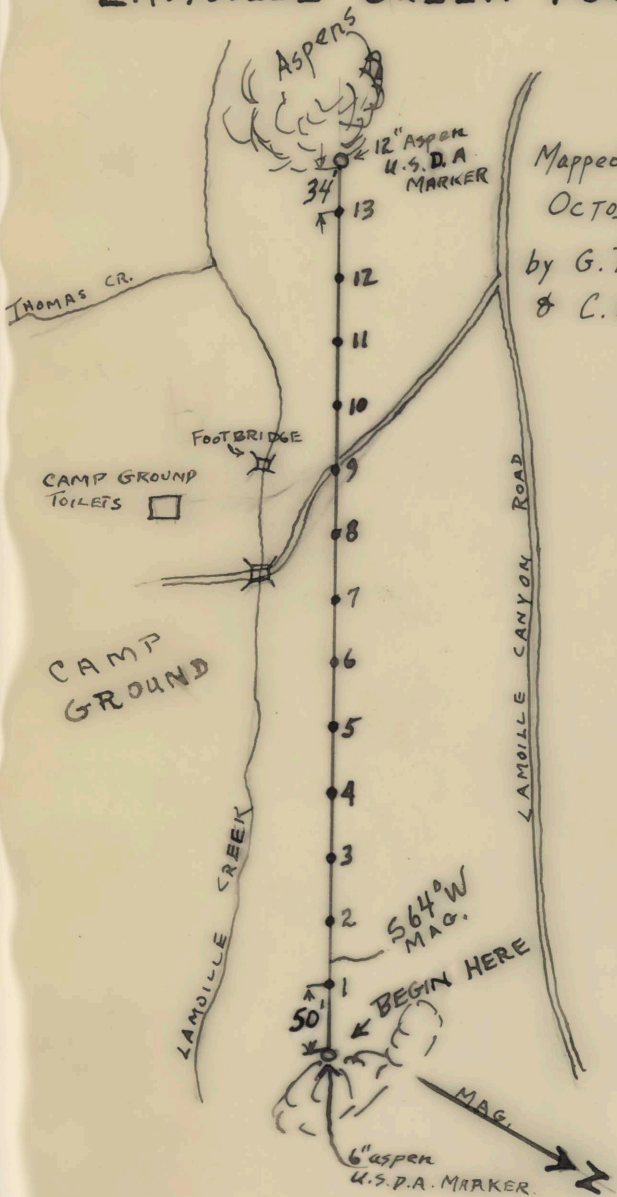

Mapped & MARKED
OCTOBER 9, 1938
by G. TRES CARTES
& C. ELGES

□
SNOW
SURVEY
CABIN

COURSE RUNS
THRU DENSE ASPENS
TRAIL CUT FOR COURSE
AND BLAZED WITH
ORANGE PAINT.

COURSE IN
LINE WITH PEAK
↑

DIRECTION OF
ROCK MONUMENT
TOP OF PEAK
↑

18"
1
15
5" aspen
U.S.D.A. MARKER.

U.S.D.A. MARKER ON
Aspen 13 ft. in front
of meas. #10

CORRAL CANYON 8500

Posted & Mapped
October 26, 1938
by G. TRES CARTES
and C. ELGES

15 MEAS. @ 50 ft.

3" Aspen
9' in front
of #5

N 75° W
MAG.

MAG. → 2

12" aspen 24' in front
of #3. BLAZED

10ft.

BEGIN HERE

14" aspen
U.S.D.A. MARKER

CLEARING

ASPENS

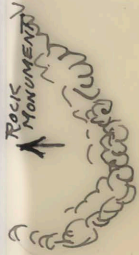

LAMOILLE CREEK 9000

Marked & Mapped
October 6, 1938
by G. TRES CARTES
and C. ELGES

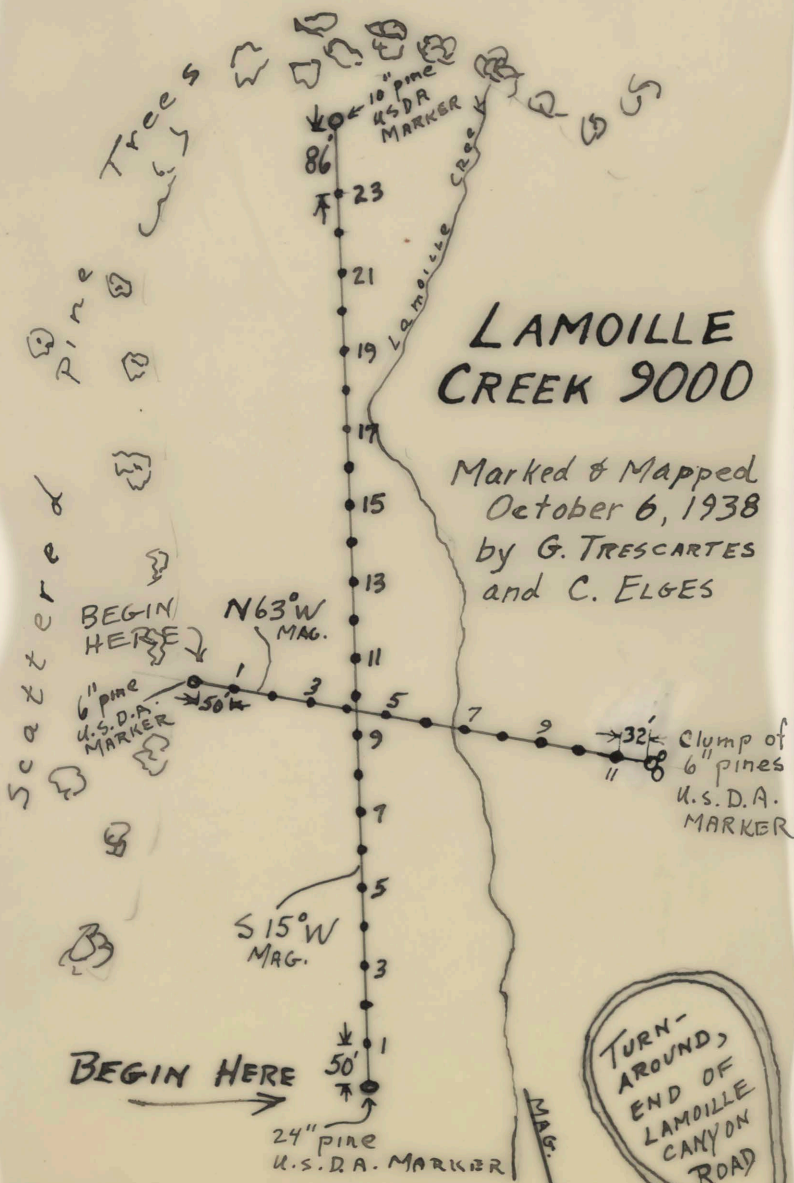

MAIN COURSE - 23 MEAS @ 50 FT.
CROSS COURSE - 11 MEAS. @ 50 FT.

RODEO FLAT
SNOW COURSE
7000 ELEVATION

17 MEAS.
@ 25 FT.

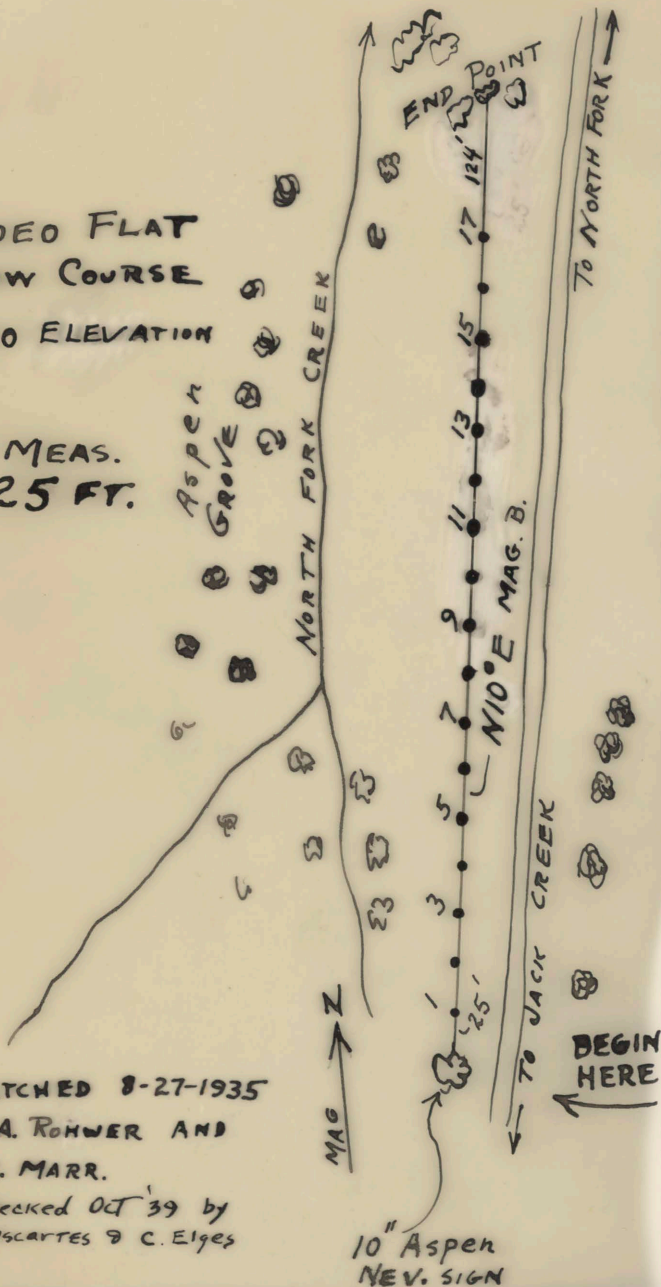

SKETCHED 8-27-1935
By A. ROHWER AND
J. C. MARR.

Rechecked OCT '39 by
G. Trescartes & C. Elges

10" ASPEN
NEV. SIGN

Aspens along creek



approx
150

road to
flume intake

Aspen tree fartherest
east in group, no
marker on this tree.

The tree to left
has a red and
yellow board. It is
about 15 ft. off
line

TROUT CREEK

- 20
- 19
- 18
- 17
- 16
- 15
- 14
- 13
- 12
- 11
- 10
- 9
- 8
- 7
- 6
- 5
- 4
- 3
- 2
- 1

Cedar post with USDA
marker 5 ft. beyond
sample no. 12.

Trout Creek 6900

20 measurements
at 50 ft. spacings

Posted and sketched
Oct. 24, 1938 by
Gerald Trescartes
and Carl Elges

N4°W

BEGIN HERE

USDA marker on
6 inch aspen at
edge of grove

Aspen
grove

50'

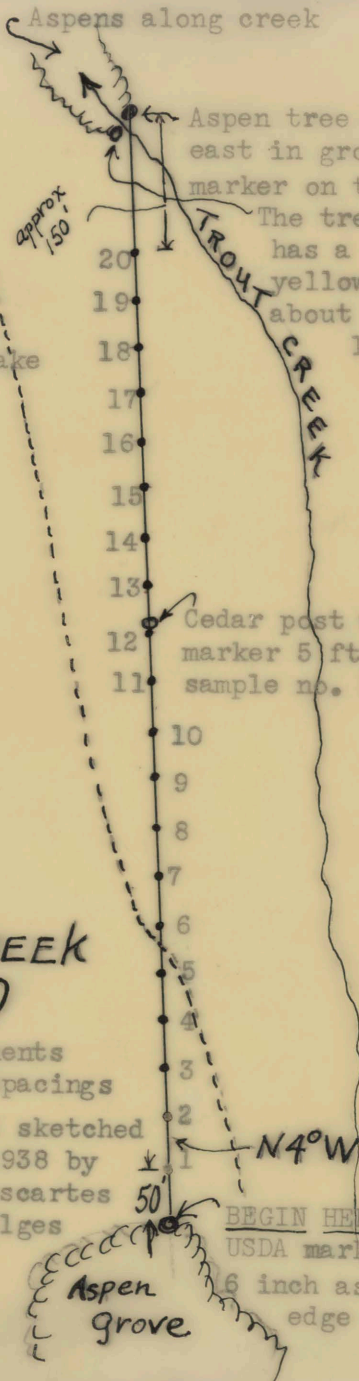

MAG. ↑

9" PINE U.S.D.A. MARKER
DISTANCE #18 TO TREE = 7 ft.

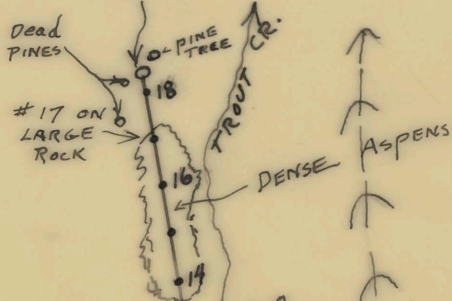

TROUT CREEK 8500

Mapped and posted
October 24, 1938 by
G. Trescartes and C. Elges

Entire Course located in
aspens and brush.

18 meas. @ 50 ft.



↑ High rocky canyon
wall

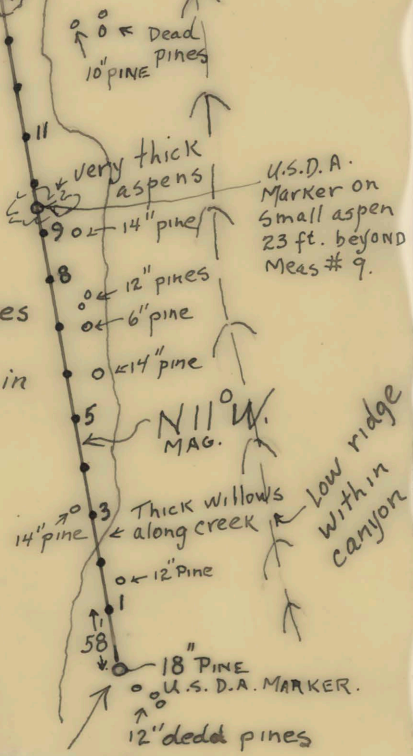

BEGIN HERE

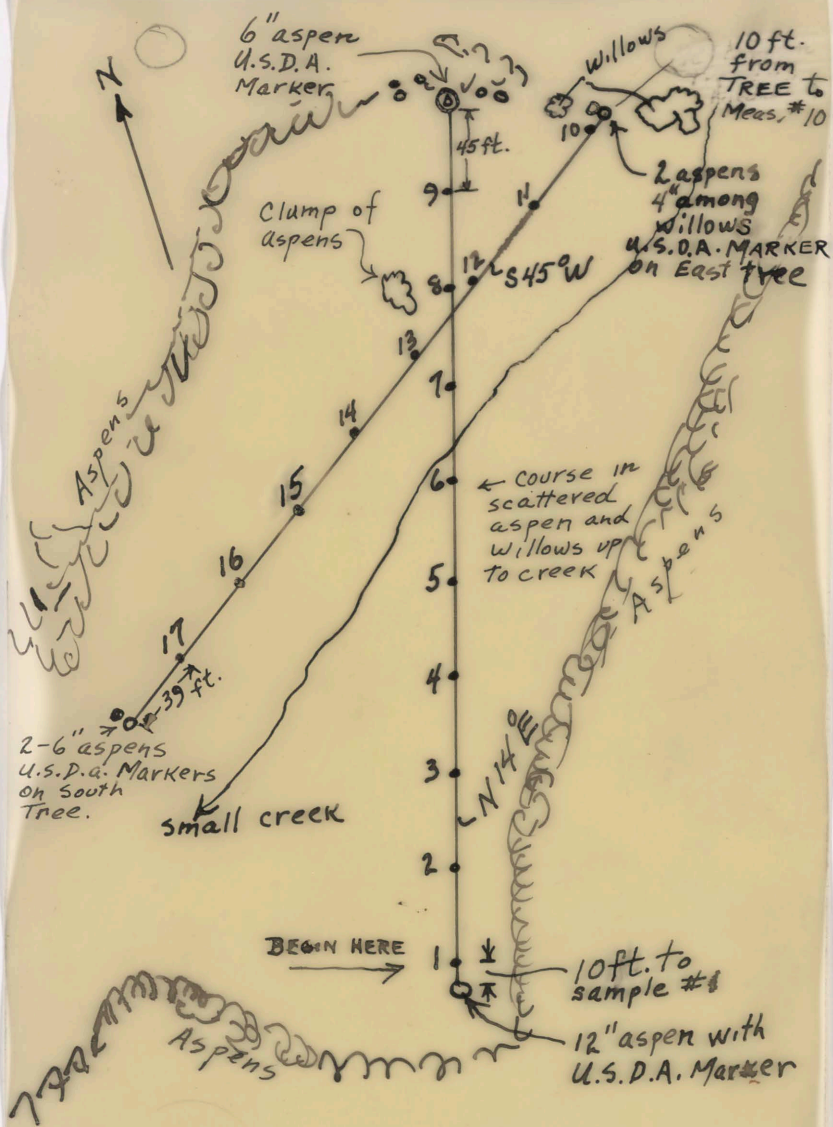

GREEN Mt. 8000 FT. ELEV.

Mapped and posted Oct. 27, 1938 by T. Toym,
 G. Trescartes, & C. Elges. COURSE located
 on East side drainage of North Fork
 of GREEN Mt. Creek.

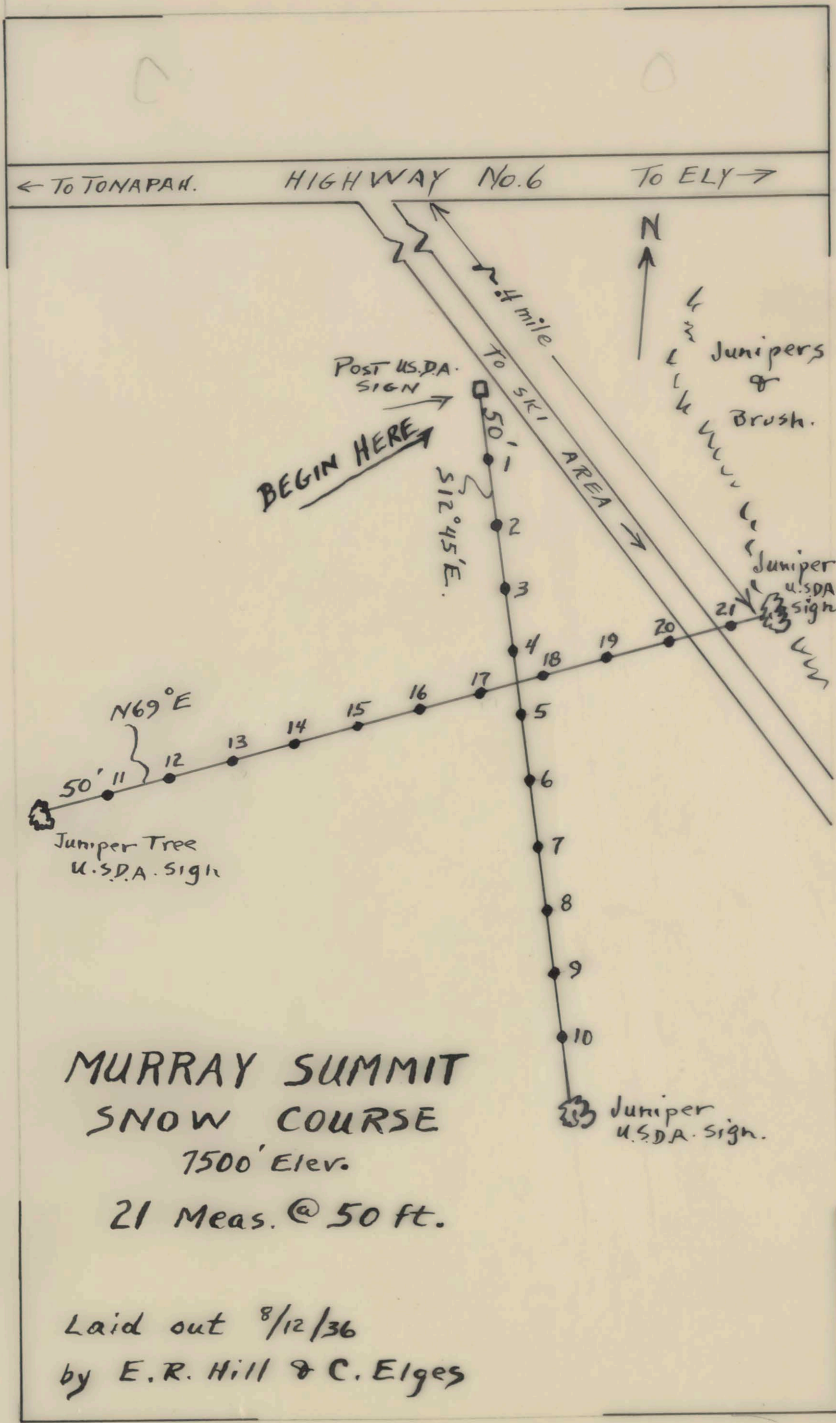

MURRAY SUMMIT
SNOW COURSE
 7500' Elev.
 21 Meas. @ 50 ft.

Laid out 8/12/36
 by E. R. Hill & C. Elges

LARGE ROCK

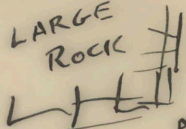

LARGE Aspen grove



Peak in line with COURSE

MARYS RIVER SNOW COURSE

22 MEAS. @ 50 FT.

MAPPED & MARKED

8-15-1936

by T.C. HAYCOCK AND C. ELGES

ROCKS

old 76 creek sheep trail

Rechecked & Cleared October '39

by G. Troscartes & C. Elges.

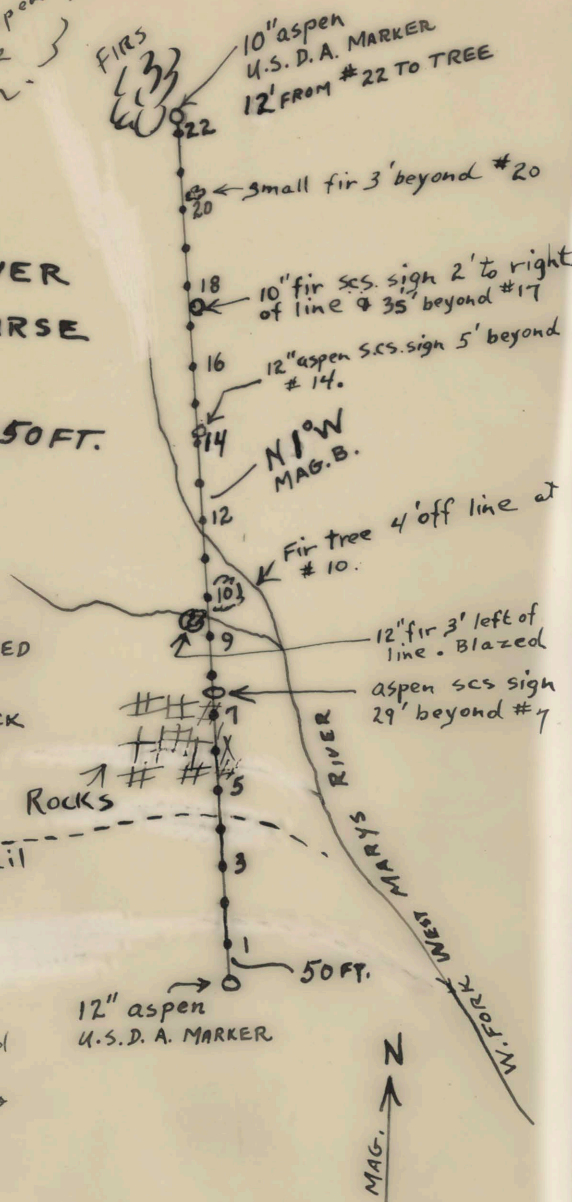

MAG. N

MIDAS SNOW COURSE

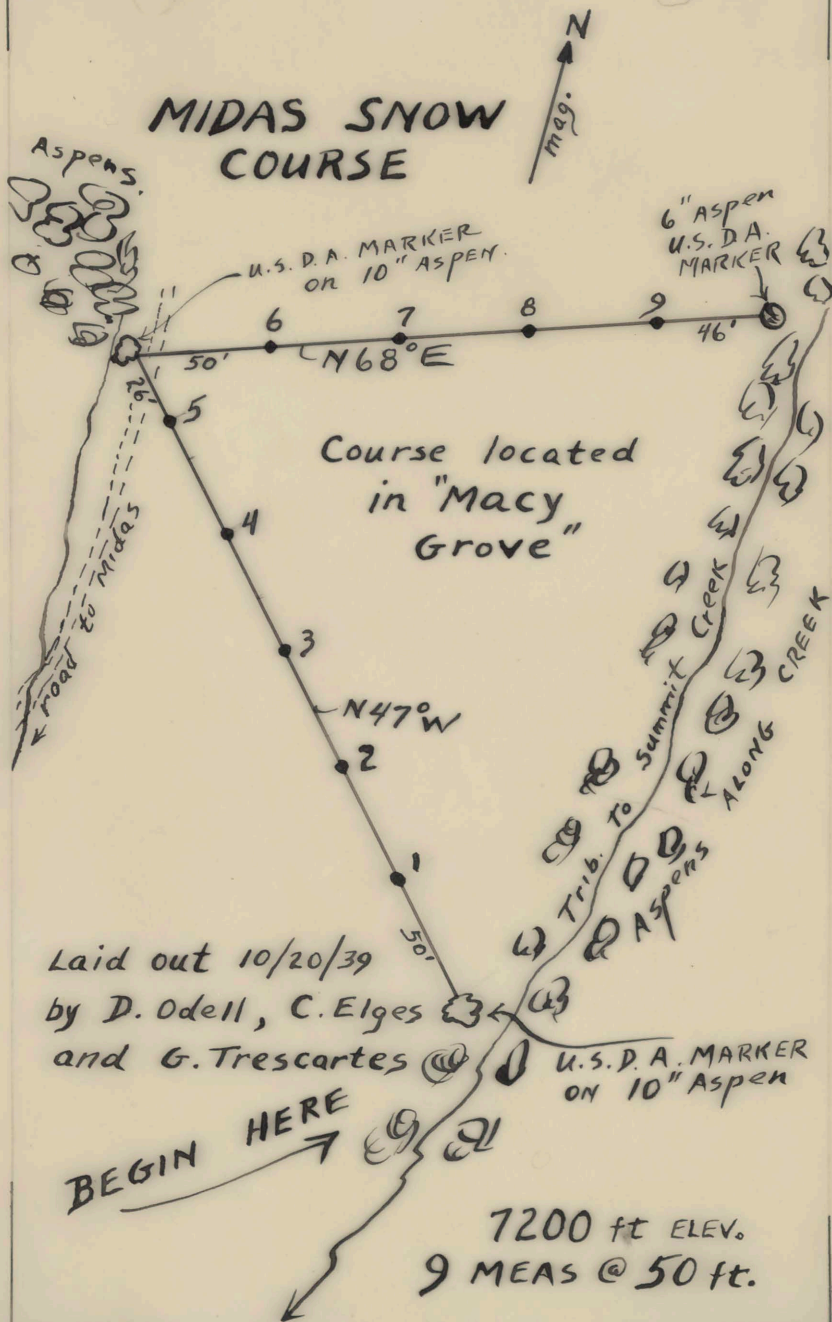

**LOWER
BUCKSKIN
MT. SNOW
COURSE**
6800' Elev.

COURSE #1 - 10 samples
#2 - 12 "
@ 50 ft. spacings

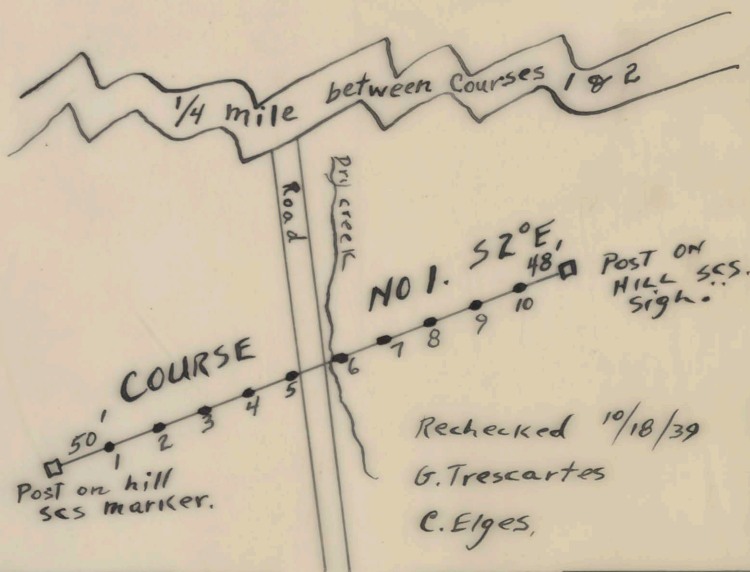
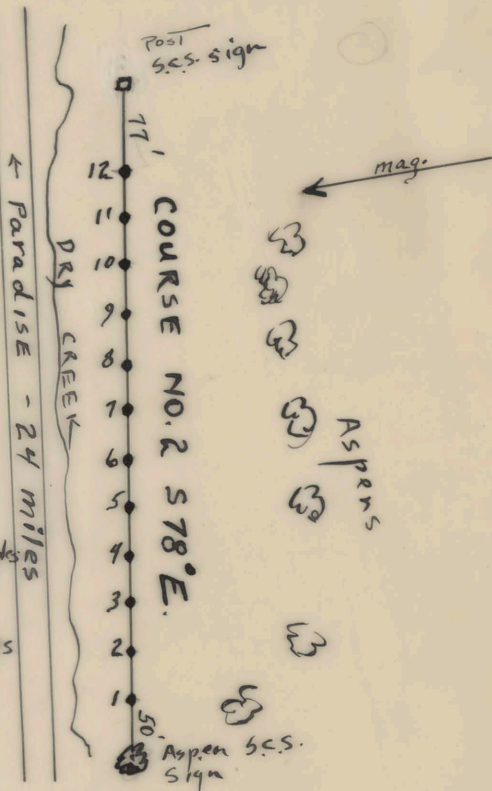

Rechecked 10/18/39
G. Trescartes
C. Elges.

TREMEWAN SNOW COURSE

5600ft. Elev.
10 meas. @ 50 ft.

SKETCHED 10/10/39
by G. TRES CARTES
AND C. ELGES.

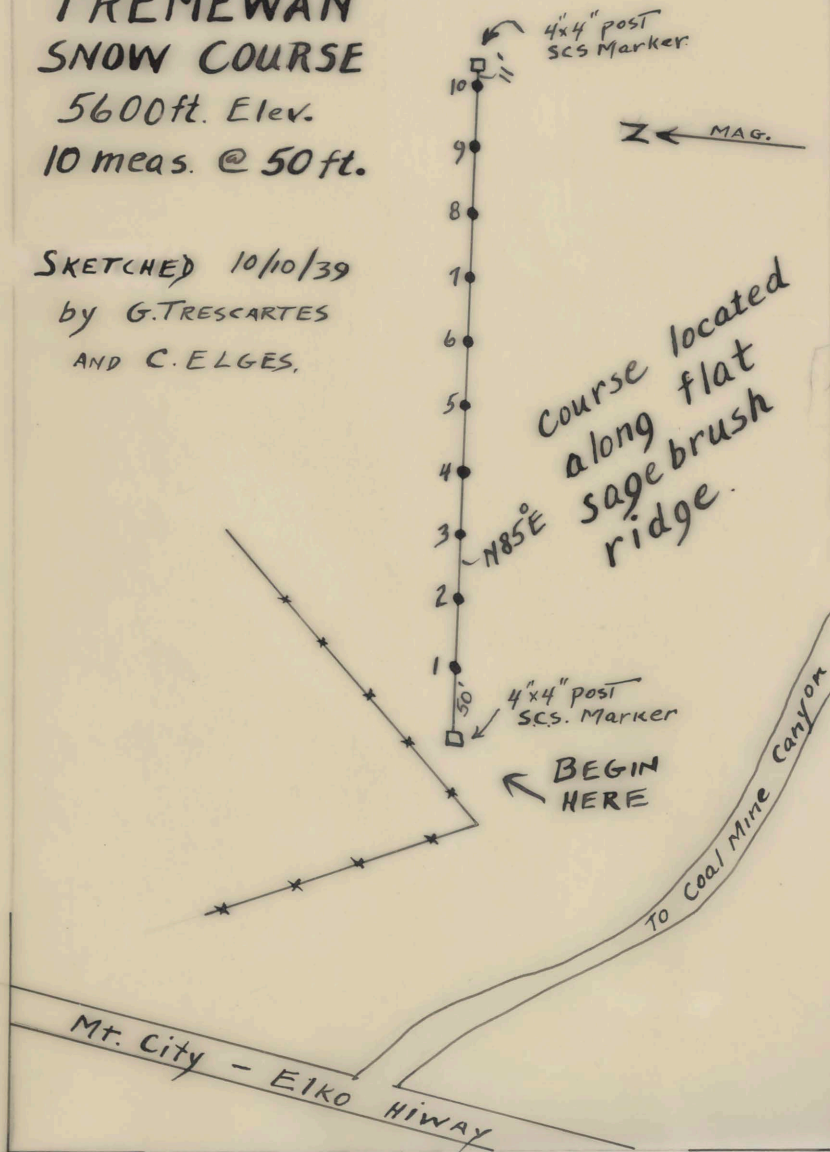

COURSE LOCATED
A SHORT DISTANCE
ABOVE SUMMER
HOME AREA.

LOCATED, POSTED & SKETCHED
NOV. 21, 1940 by R.B. GRIFFITH
AND CARL ELGES

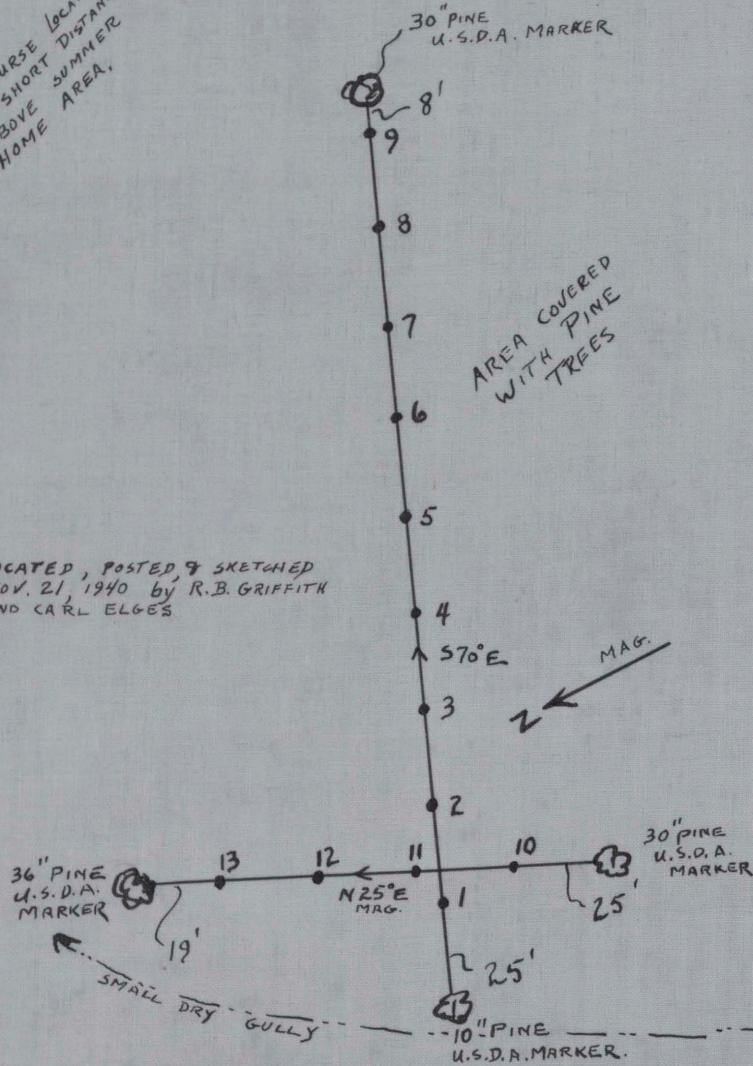

**RAINBOW
CANYON**
7800' ELEV.

125 YDS. TO WATER
TANK

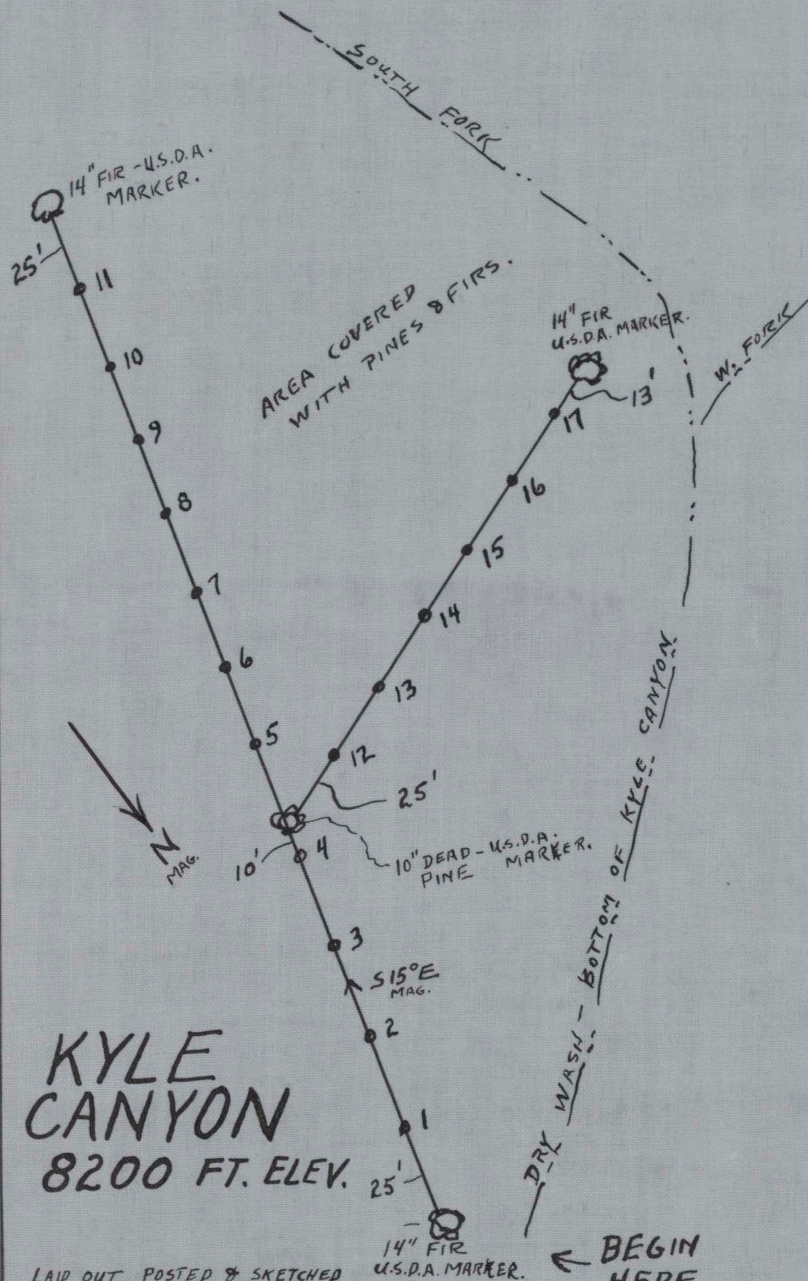

**KYLE
CANYON**
8200 FT. ELEV.

LAI D OUT, POSTED & SKETCHED
NOV. 21, 1940 by GRIFFITH
AND ELGES.

BEGIN
HERE
17 MEAS. @ 25'

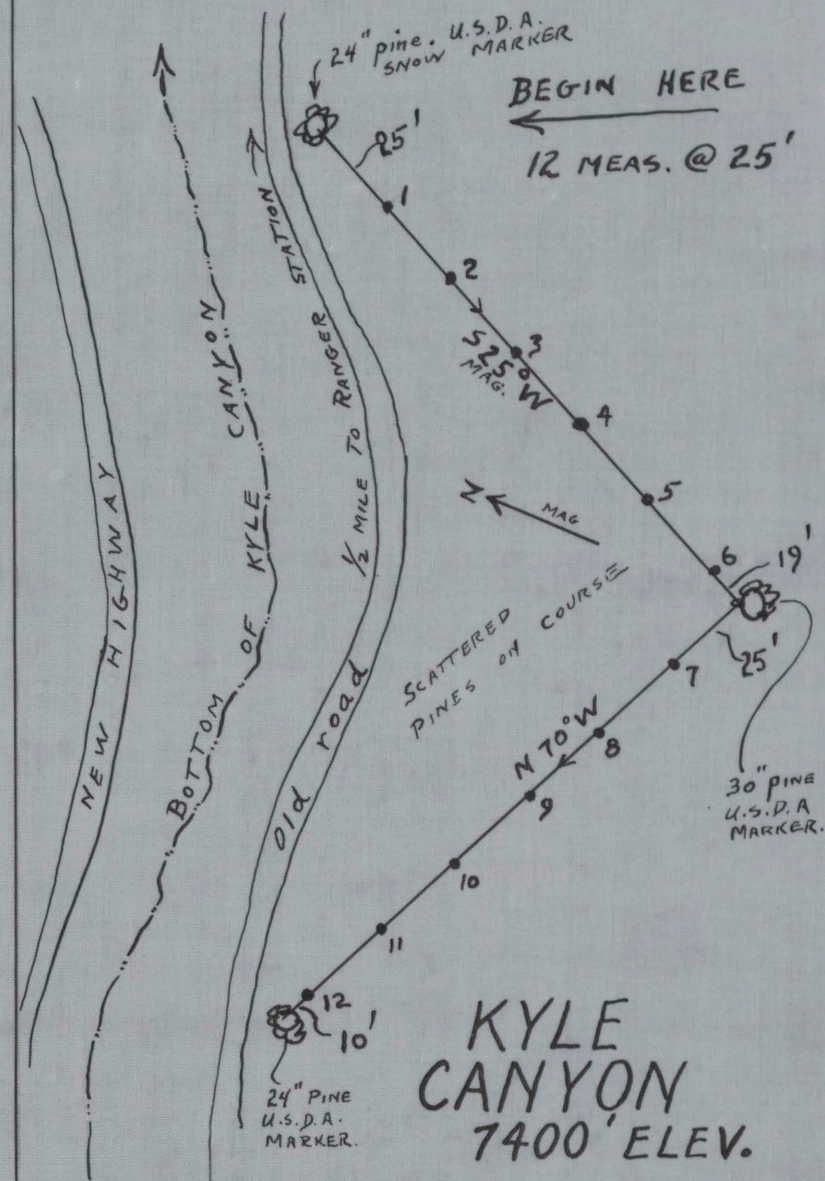

**KYLE
CANYON**
7400' ELEV.

LAI D OUT, POSTED & SKETCHED NOV. 21, 1940 by
R.B. GRIFFITH & CARL ELGES