

STATE OF CALIFORNIA  
DEPARTMENT OF PUBLIC WORKS  
SACRAMENTO

DIVISION OF WATER RESOURCES  
401 PUBLIC WORKS BUILDING

EDWARD HYATT, STATE ENGINEER  
CHIEF OF DIVISION

January 24, 1936

Professor H. P. Boardman  
University of Nevada  
Reno, Nevada.

Dear Mr. Boardman:

Reference is made to your letters of January 16th and 19th, 1936, the latter enclosing copy of your letter to Professor Clyde relative to numbering and signing of courses.

In response to a card from Dr. Church, I am sending him today, two copies each of the sketches of Ward Creek and Upper Rubicon snow courses and pursuant to your letter of January 16th I am enclosing for you one copy each of the above sketches and one copy each of Blue Lakes, Burnside, Williams, Pacific Valley and Carson Pass courses. I am sending one copy each of these latter also to Dr. Church. We do not seem to have any sketch of Silver Peak course and I don't believe Mr. Munson ever made up this sketch at the time he was making those for Burnside, Williams, etc.

And now relative to the signs and numbering of courses, I agree with you that it would be much better to place the new markers in the Summer time. I do not see how it would be feasible for the men to be burdened with doing that work at the time of making the snow surveys. I have as yet received no communication from Mr. McLaughlin or Mr. Marr relative to their plan for numbering the courses. I can appreciate the difficulties and inconsistencies which may arise if a definite plan for the numbering is not adopted and carried out by all the agencies *doing* the snow survey work. I am inclined to agree with you that the proper way of numbering would be by drainage basins. Off hand I should think that the courses in each basin could be numbered independently and then for the purposes of the Bureau of Agricultural Engineering files, subscript letters could be added which would indicate first the drainage basin and second the State. For instance, our Summit course shown as #6 in the Yuba Basin might be called 6 Y.C for Yuba and State of California, and you would have a number for it followed by T.N for Truckee Basin and State of Nevada. As you say, the one difficulty with this is the duplication of numbers for the same course. However, some simple designation might be evolved so that an inspection of the Federal agencies' files would readily show those courses for which there are duplicate numbers. I do not know what system Mr. McLaughlin has proposed and whether or not he has already decided upon a certain system or is still casting about for the best. In any event we shall of course wish to conform to whatever system is adopted.

As we have all of our courses already signed and still have a considerable supply of these signs on hand for replacements, Mr. McLaughlin did not have any of the new Federal signs made up for California. It would probably be best to ultimately have our courses marked by the Federal signs but we may as well use those which we have for the present.



Professor H. P. Boardman - 2.

January 24, 1936

We expect to have the surveys made at practically all of our key courses at the end of this month and we shall be glad to forward you the results as usual for the courses in which you are interested. According to our last information from the Pacific Gas and Electric Company, the surveys will be made as usual at the end of January, February, March and April at Summit, Lake Fordyce, Carson Pass, Silver Lake, and Blue Lakes.

Very truly yours,

---

Harlowe M. Stafford  
SNOW SUPERVISOR

HMS:EB

Encl.

cc: Mr. W. W. McLaughlin  
Division of Irrigation  
Bureau of Agricultural Engineering  
Post Office Box 180  
Berkeley, California.

cc: Dr. J. E. Church ✓  
University of Nevada  
Reno, Nevada.



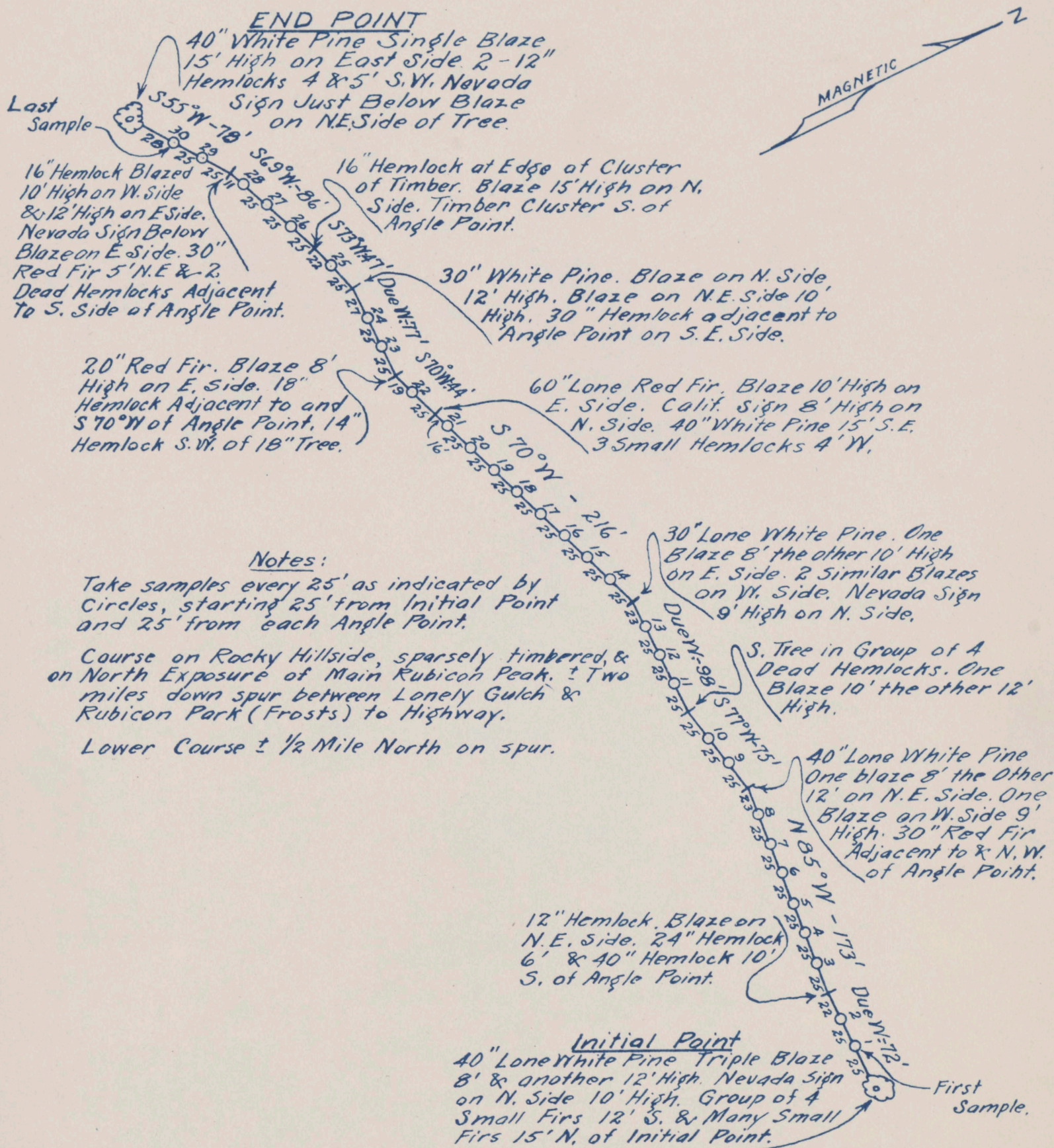

CALIFORNIA COOPERATIVE SNOW SURVEYS  
LAKE TAHOE BASIN

RUBICON PEAK - UPPER COURSE  
ELEVATION 8100'

11/20/30



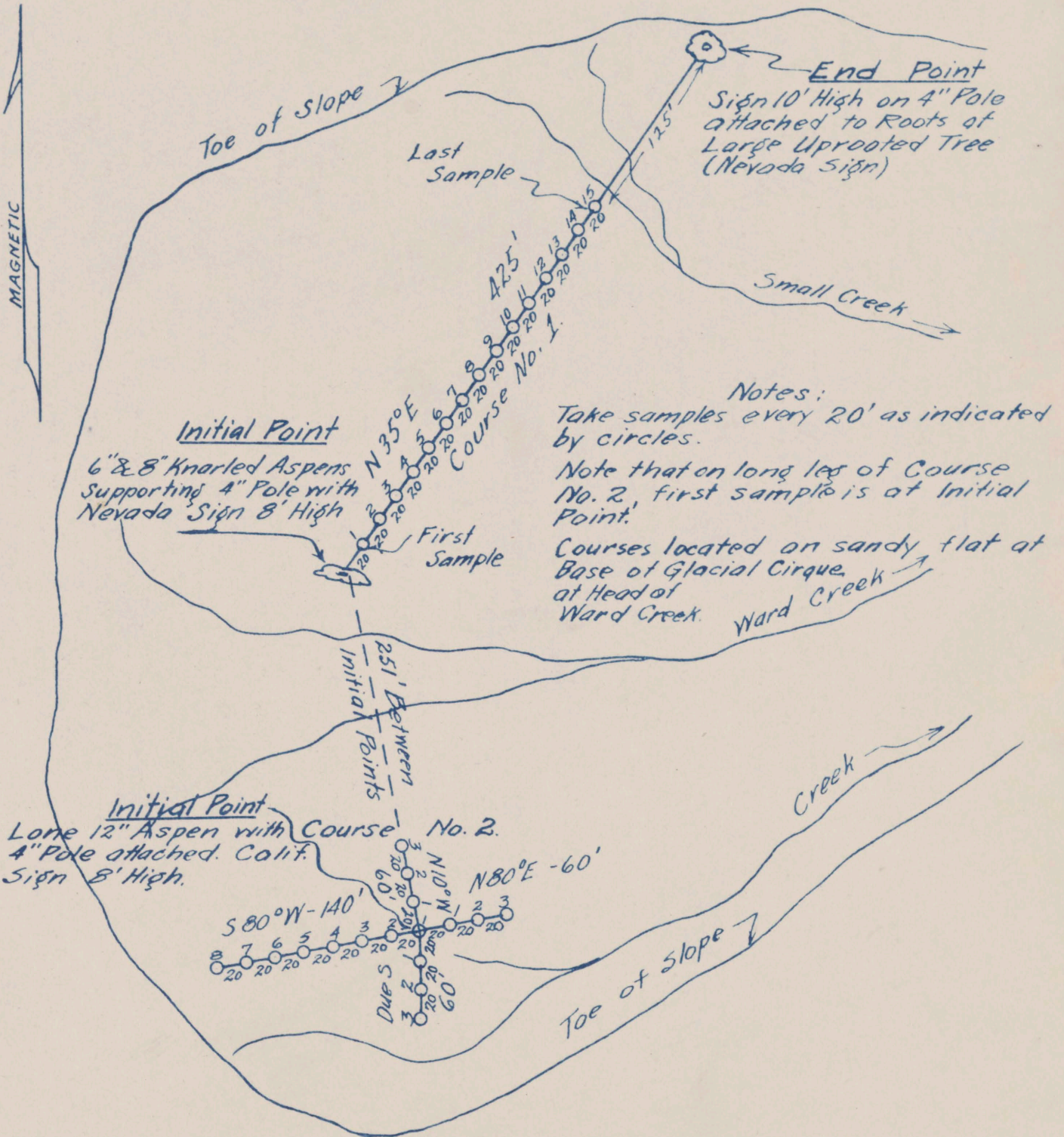

CALIFORNIA COOPERATIVE SNOW SURVEYS  
LAKE TAHOE BASIN

WARD CREEK COURSE  
ELEVATION 7000'



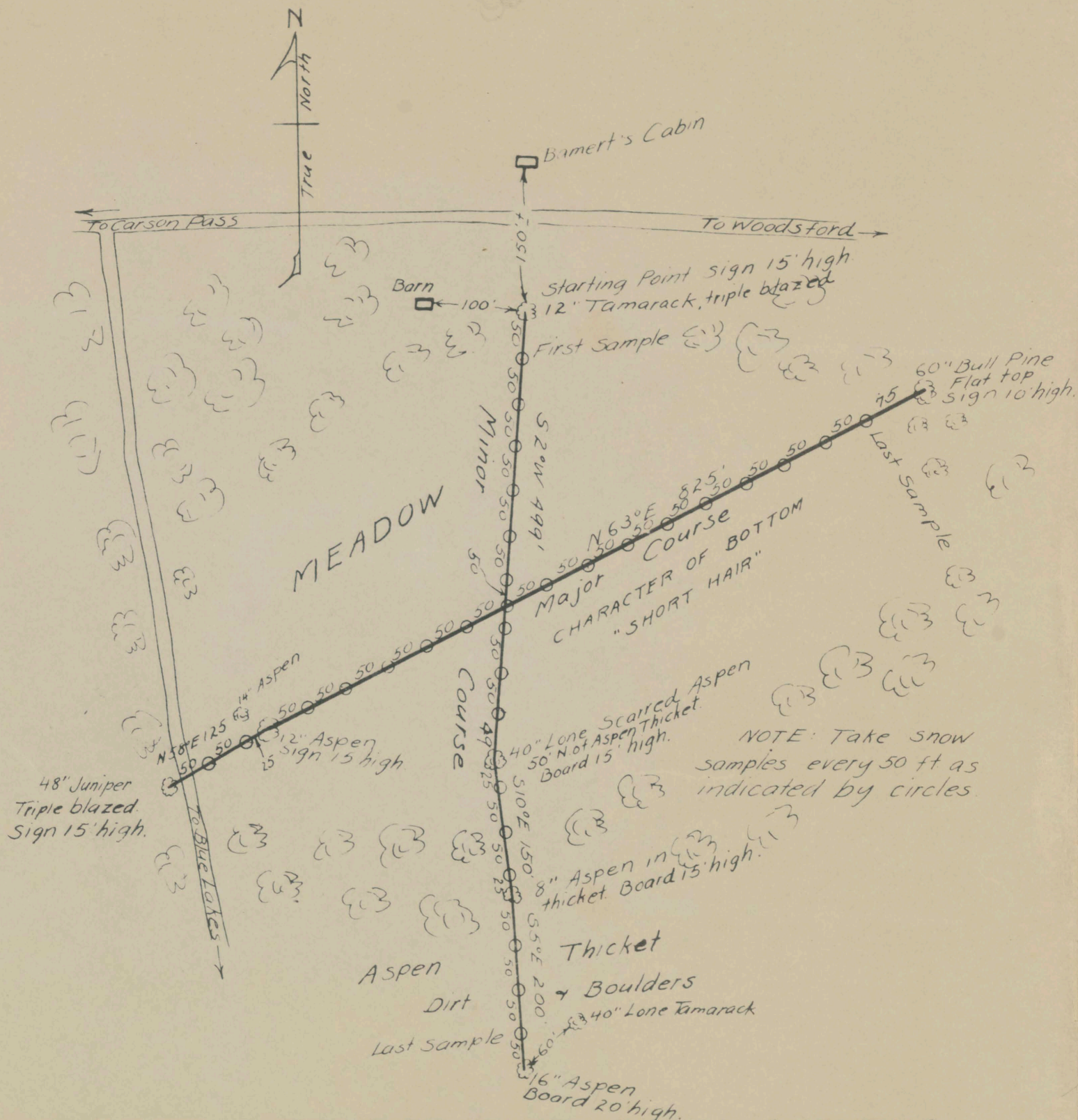

**CALIFORNIA COOPERATIVE SNOW SURVEYS**

**WEST CARSON BASIN**

**"WILLIAMS" COURSE**

APPROX. ELEV. 7800



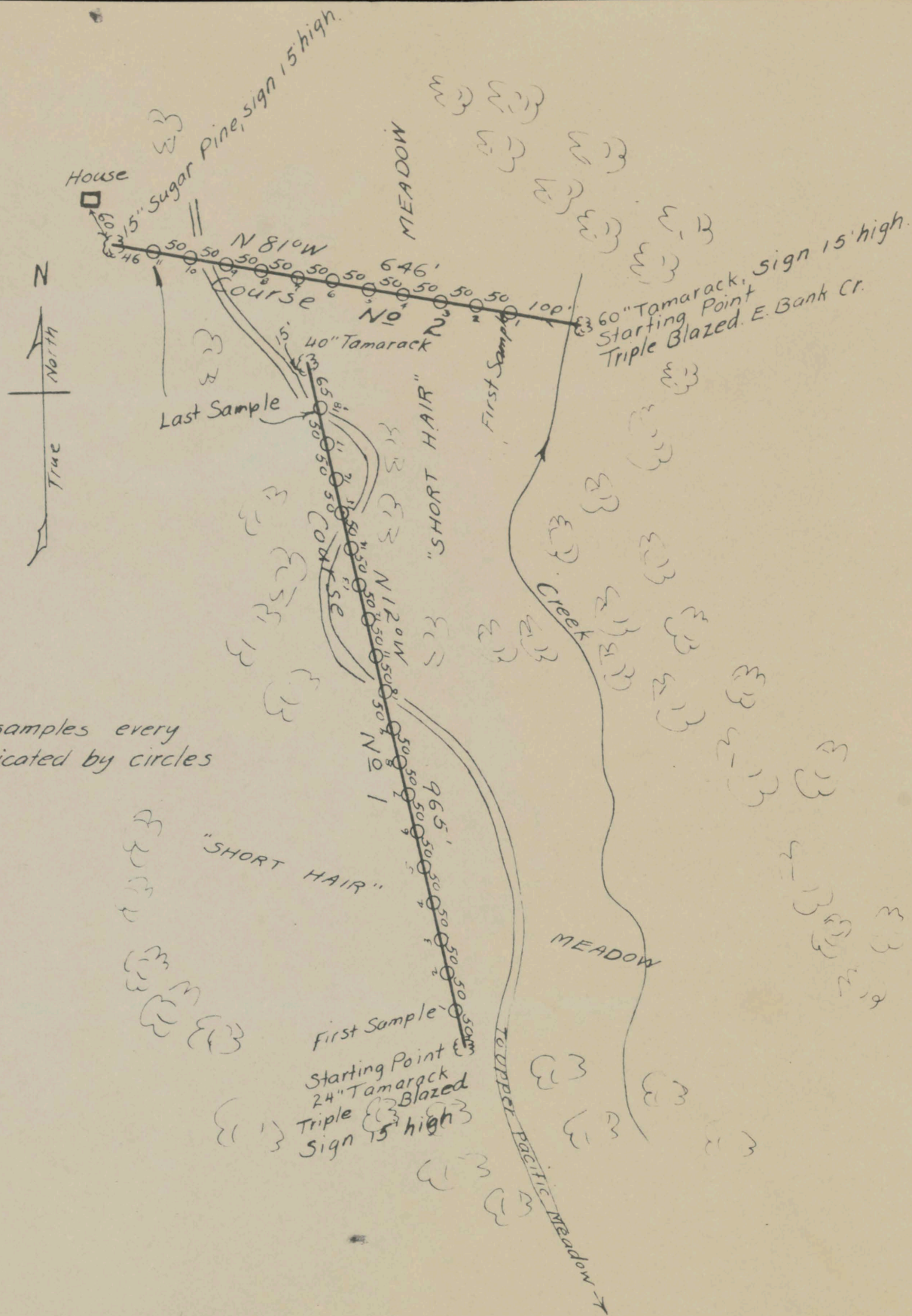

Note:  
 Take snow samples every  
 50 ft. as indicated by circles

**CALIFORNIA COOPERATIVE SNOW SURVEYS**

**"PACIFIC VALLEY" COURSE**

**MOKELUMNE RIVER BASIN**

APPROX. ELEV. 7500







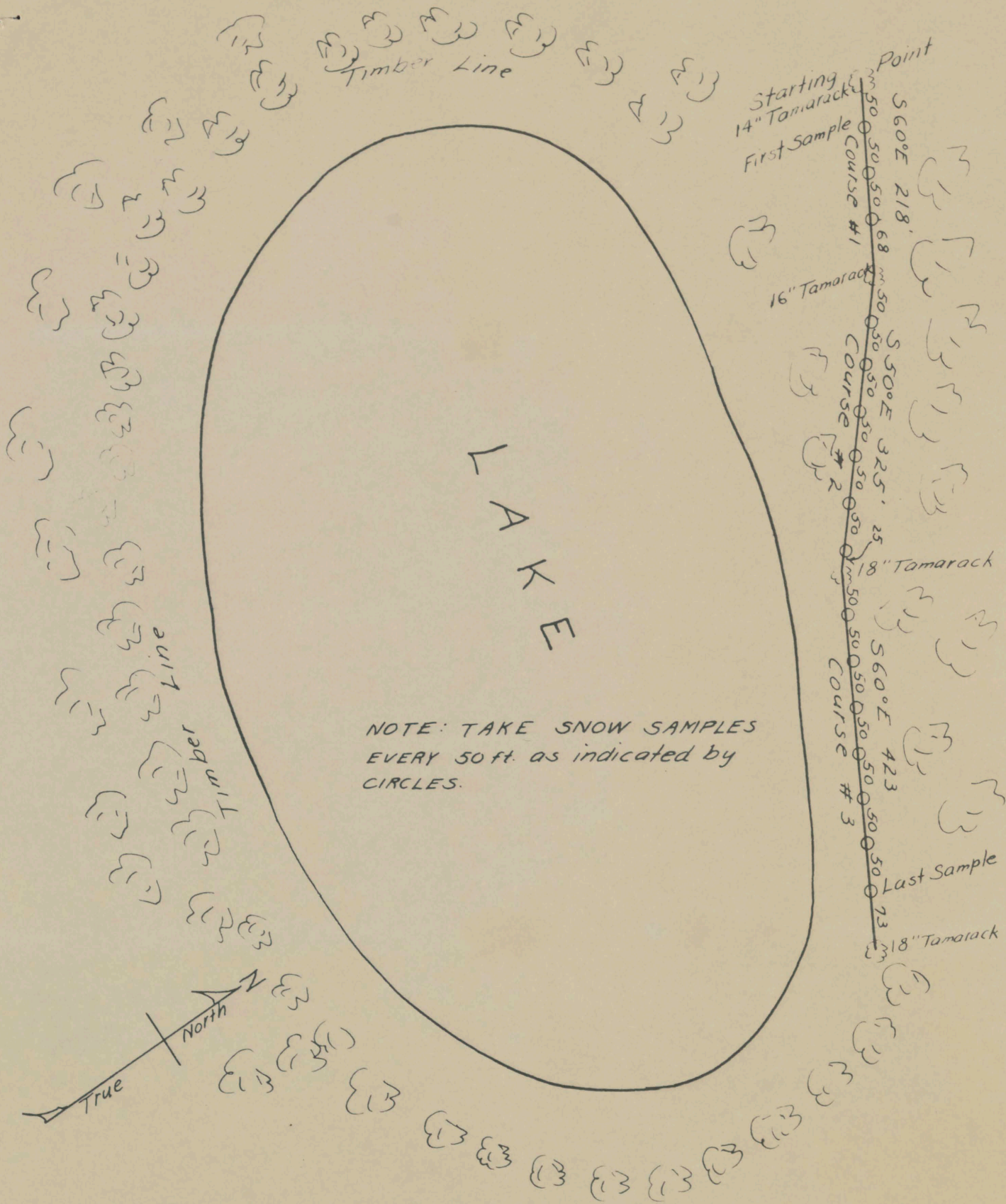

NOTE: TAKE SNOW SAMPLES EVERY 50 ft. as indicated by CIRCLES.

**CALIFORNIA COOPERATIVE SNOW SURVEYS**  
**EAST FORK CARSON RIVER BASIN**  
**"BURNSIDE LAKE" COURSE NO 1**

APPROX. ELEV. 8000

10-5-29



NOTE: Take snow samples every 50' as indicated by circles.

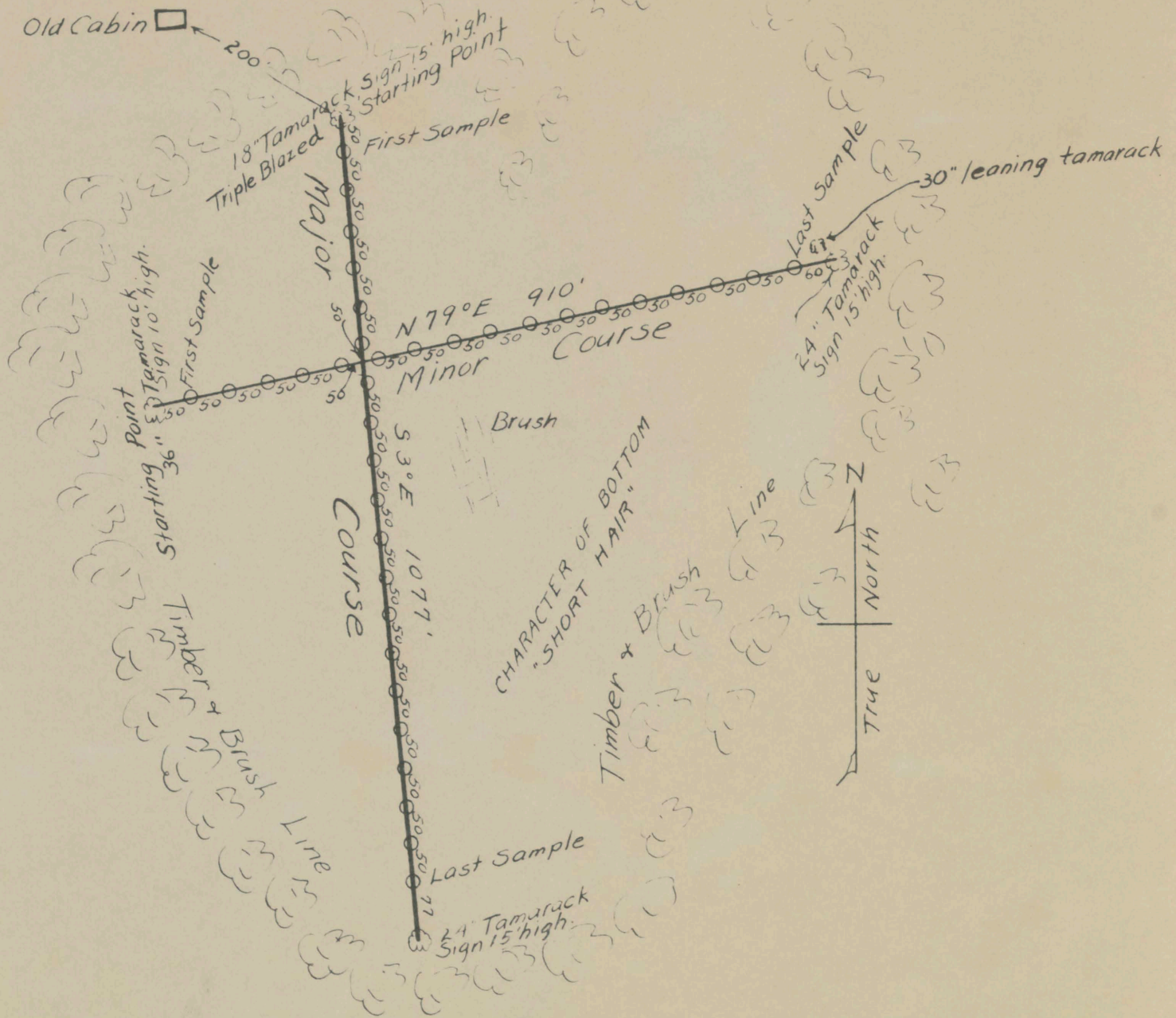

CALIFORNIA COOPERATIVE SNOW SURVEYS

EAST FORK CARSON RIVER BASIN

"BURNSIDE LAKE" COURSE NO 2

APPROX. ELEV. 8000

10-5-29



Caretaker's House  
 To Lake -->  
 Cabin

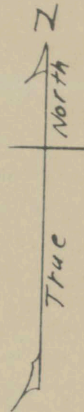
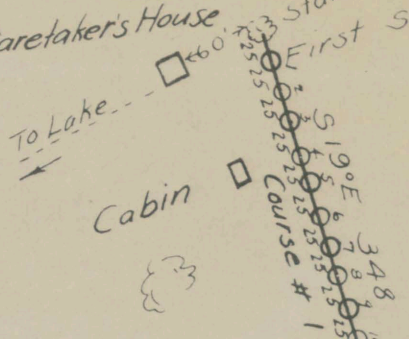

CHARACTER OF BOTTOM  
 DIRT & BOULDERS

14" Tamarack. Nevada sign.

Course # 2

180° E 4'

225'

30" Tamarack, blazed.

Note: Take snow samples every 25 ft. as indicated by circles.

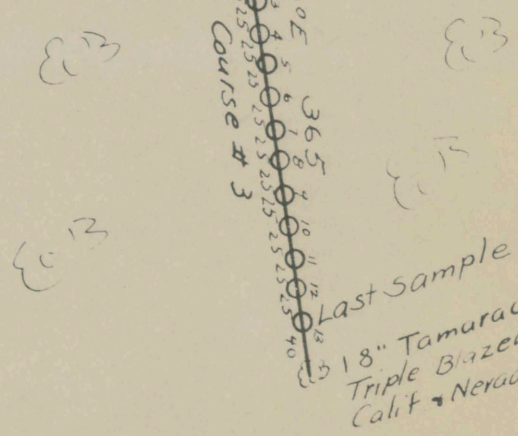

**CALIFORNIA COOPERATIVE SNOW SURVEYS**

**"BLUE LAKES" COURSE NO 1**

APPROX. ELEV. 8000

**MOKELUMNE RIVER BASIN**



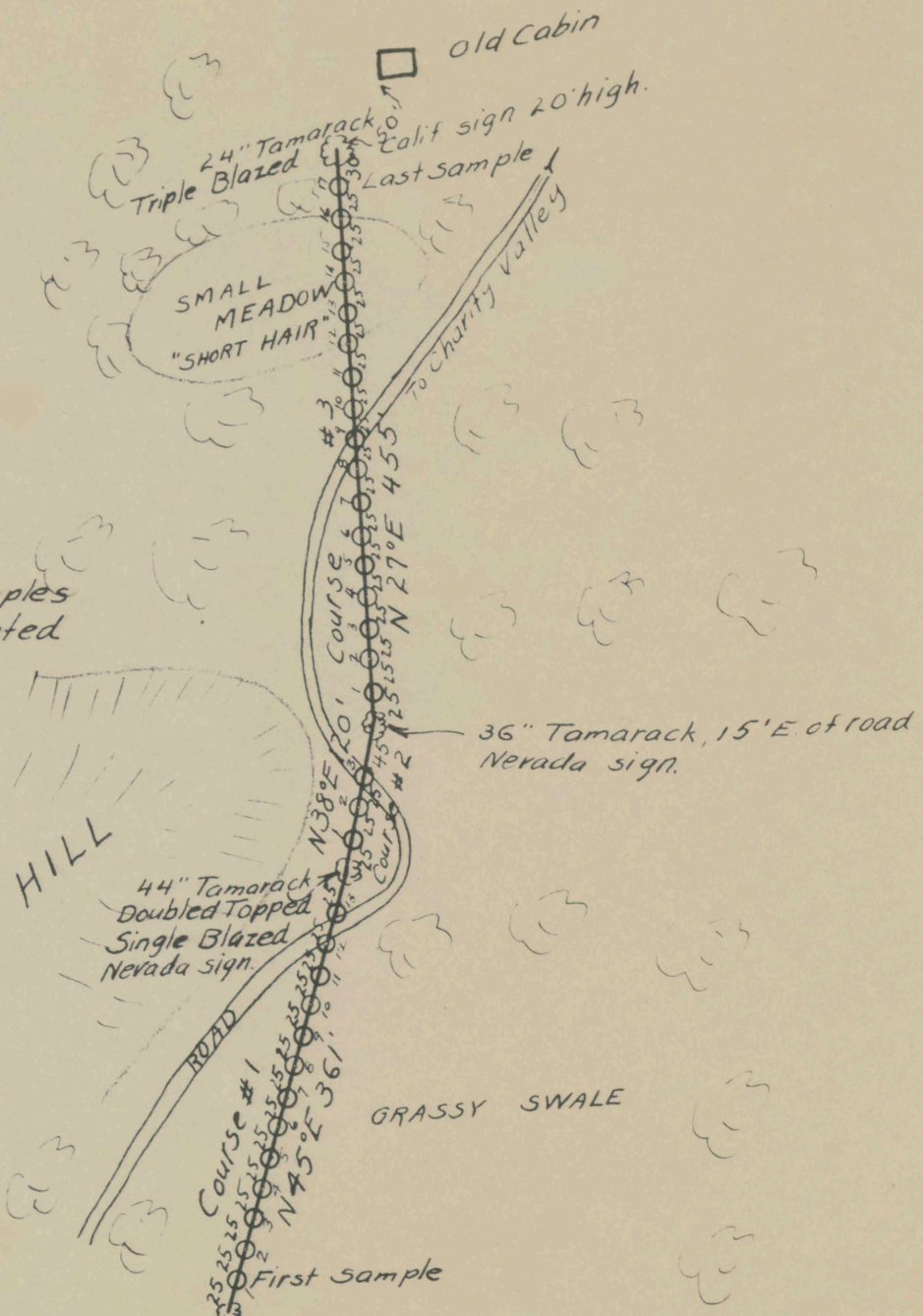
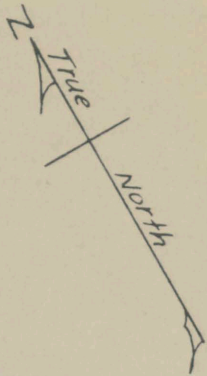

Note: Take snow samples every 25 ft. as indicated by circles.

Calif sign 20' Starting Point  
 Nevada " 15' high 36" Tamarack  
 Triple blazed  
 500' N. of Keepers house

**CALIFORNIA COOPERATIVE SNOW SURVEYS**

**MOKELUMNE RIVER BASIN**

**"BLUE LAKES" COURSE NO 2**

APPROX. ELEV. 8000