





... Contract ...

Publishers of "The Artemisia,"

Apr 4
..... 1905

Please insert my advertisement in "The Artemisia" for 1905;

Said ad to occupy

for which I agree to pay the sum of Dollars

upon publication of said "Artemisia."

The publishers agree to furnish advertisers with one book with each \$20.00 contract.

SIGNED

F. O. Bradley

..... BUS. MGR.

2612

Nevada State University

Received from

C. M. Sparks

\$65

For Chemistry, General \$; Qualitative \$; Quantitative \$; Bio-
logical Laboratory \$; Typewriting \$; Deposit, General Chemistry \$;
Qualitative \$; Quantitative \$; Guarantee \$1.00; Athletic \$2.00; Mineralogy
\$; Assaying \$; Metallurgy \$; Shop \$; Diploma
\$; Sewing \$; Cooking \$

Robt. Lewis

Registrar

2970

Nevada State University

Received from C. M. Sparks \$4²⁰

For Chemistry, General \$.....; Qualitative \$.....; Quantitative \$.....; Bio-
 logical Laboratory \$.....; Typewriting \$.....; Deposit, General Chemistry \$.....;
 Qualitative \$.....; Quantitative \$.....; Guarantee \$1.00; Athletic \$2.00; Mineralogy
 \$.....; Assaying \$.....; Metallurgy \$.....; Shop \$1⁵⁰.....; Diploma
 \$.....; Sewing \$.....; Cooking \$.....

Feb 28th

R. Jewers

Registrar

\$

4 00

RENO WHEELMEN'S CLUB

Reno, Nevada, 2-15- 1904

Received of

C. M. Sparks

Four

Dollars

for Dues to

May 1

1904

J. C. Shaver

Fin

F. T. Gleason.

224 South Columbia St.

Goldfield,

Yev.

Fred Minnis

13 508

FRED. J. TAIT

MANAGER

MONTEZUMA CLUB

GOLDFIELD, NEVADA

"A camel can go eight days
without a drink."

"Who the Hell would want to be
a camel?" — "Checkers."

CHARLES G. NAGLE

ATTORNEY-AT-LAW

517 MAIN STREET
GOLDFIELD, NEVADA

CHARLES G. NAGLE
ATTORNEY AT LAW
527 MAIN STREET
GOLDFIELD, - - - NEVADA

C. M. Sparks

1418

7
3

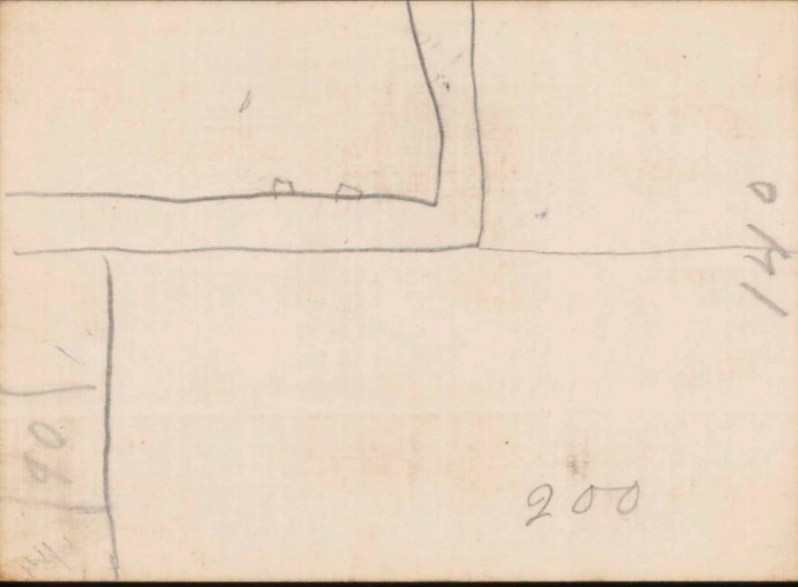

041

200

90

823
West Second
90

NOT TRANSFERABLE.

American Federation of Butters.



MEMBERSHIP CARD.



This Certifies That

Sparx.

IS ENTITLED TO "BUTT IN" ALL CONVERSATIONS
WHETHER PUBLIC OR PRIVATE.

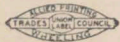

(OVER)

BILLY GOAT, PRESIDENT.
NANNY GOAT, SECRETARY.

“BUTT IN”

And ask your friends how they
like

MAIL POUCH TOBACCO.

Hear them tell you it is the
best Tobacco on Earth.

Mr F. A. Shobley
Luptforddale. Hawthorn
Canta Cruz es
Eugene W. Hunt } Cal

California State Fish Commission

My dear Frank

This will introduce my friend
Chas Sparks of Nevada. Any favors
shown him will be appreciated

No.

No goods delivered
Without this check

310

In issuing this check owner agree
not to hold us responsible if goods
are not called for inside of 60 days

Charges -----

Rafael Y. Mendez

% Geo. J. von Tolenz
— + Co.

Roy Taylor in care of
Patric & Pettet office

U. S. Registered

every post office in the U. S. to
Letters and parcels may be registered
at any post office or at any post-office
station, and by rural carriers throughout
their routes. Letters will be registered
by letter carriers in the residential dis-
tricts of cities.

For registered mail delivered through
a U. S. post office, the sender receives,
without request or extra charge, a return
receipt signed by the addressee or his
agent. For registered mail delivered in a
foreign country the sender receives with-
out extra charge a form of return receipt
if the words "Return Receipt Demanded"
appear on the envelope or wrapper.

Letter }
Parcel }

No. _____

645

P. O., _____

RENO NEV

Received for registration _____, 190 _____, from _____

addressed to _____

Chas. Ed-
170

class postage prepaid.

Mrs. B. H. Sparks
Uniton Cal.

Postmaster, per _____

Seaman

A. J. TAYLOR

FRANK ROBERTS

Roberts & Taylor

GENERAL CONTRACTORS



MANUFACTURERS AND BUILDERS OF CONCRETE BLOCKS
CONCRETE CONSTRUCTION IN ALL ITS BRANCHES
SIDEWALKS. FOUNDATIONS, ETC.

ESTIMATES FURNISHED
ALL WORK GUARANTEED

PHONE MAIN 179
118 ELM ST. RENO, NEV.

133 W. 2nd St.

Phone 937

G. F. Deet.

Haggert

Nevada State University

ATHLETIC ASSOCIATION

This ticket will admit the person whose name appears hereon to all Athletic Contests held on the U. of N. Campus or in the Gymnasium during the second semester of the year 1905. This ticket does not admit to Debates or other Literary exercises.

GOOD ONLY WHEN COUNTERSIGNED

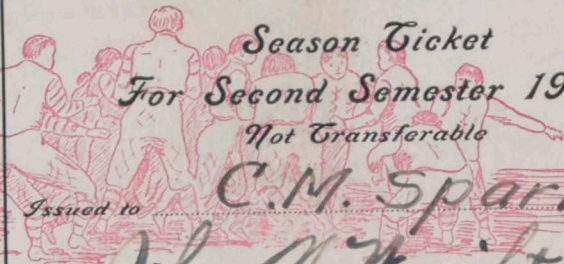

Season Ticket

For Second Semester 1905

Not Transferable

Issued to C. M. Sparks.

John H. Wright

Pres. of A. A.

Secy. of A. A.



MONTEZUMA CLUB

GOLDFIELD, NEVADA.

VISITOR'S CARD

MR. *C. M. Sparks.*

IS ENTITLED TO THE PRIVILEGE OF THE CLUB
FOR THE PERIOD OF TEN DAYS.

John W. Donnellan

SECRETARY.

DATE

March 25 1907

Mr Joe Moore
Columbia Cafe

6th + J St

San.
Cal



MONTEZUMA CLUB
GOLDFIELD, NEVADA.

VISITOR'S CARD

MR. *C. W. Sparks.*

IS ENTITLED TO THE PRIVILEGE OF THE CLUB
FOR THE PERIOD OF TEN DAYS.

Wm. Donnellan
SECRETARY.

DATE

March 16th 1907.

Compliments of
The Union Central
Life

CINCINNATI.

WM. L. CLAIBORNE, Agent,
GOLDFIELD, NEV.



UNION CENTRAL LIFE.

1907	Sunday	Monday	Tuesday	Wednes.	Thursd.	Friday.	Saturd.	1907	Sunday	Monday	Tuesday	Weanes.	Thursd.	Friday.	Saturd.
Jan.	1	2	3	4	5	July	..	1	2	3	4	..	6
	6	7	8	9	10	11	12		7	8	9	10	11	12	13
	13	14	15	16	17	18	19		14	15	16	17	18	19	20
	20	21	22	23	24	25	26		21	22	23	24	25	26	27
	27	28	29	30	31		28	29	30	31
Feb.	1	2	Aug.	1	2	3
	3	4	5	6	7	8	9		4	5	6	7	8	9	10
	10	11	12	13	14	15	16		11	12	13	14	15	16	17
	17	18	19	20	21	22	23		18	19	20	21	22	23	24
	24	25	26	27	28		25	26	27	28	29	30	31
Mar.	1	2	Sep.
	3	4	5	6	7	8	9		1	2	3	4	5	6	7
	10	11	12	13	14	15	16		8	9	10	11	12	13	14
	17	18	19	20	21	22	23		15	16	17	18	19	20	21
	24	25	26	27	28	29	30		22	23	24	25	26	27	28
	31		29	30
Apr.	..	1	2	3	4	5	6	Oct.	1	2	3	4	5
	7	8	9	10	11	12	13		6	7	8	9	10	11	12
	14	15	16	17	18	19	20		13	14	15	16	17	18	19
	21	22	23	24	25	26	27		20	21	22	23	24	25	26
	28	29	30		27	28	29	30	31
May	1	2	3	4	Nov.	1	2
	5	6	7	8	9	10	11		3	4	5	6	7	8	9
	12	13	14	15	16	17	18		10	11	12	13	14	15	16
	19	20	21	22	23	24	25		17	18	19	20	21	22	23
	26	27	28	29	30	31	..		24	25	26	27	28	29	30
June	1	Dec.
	2	3	4	5	6	7	8		1	2	3	4	5	6	7
	9	10	11	12	13	14	15		8	9	10	11	12	13	14
	16	17	18	19	20	21	22		15	16	17	18	19	20	21
	23	24	25	26	27	28	29		22	23	24	25	26	27	28
	30		29	30	31

2
Tanapoh Goldfield
meat Co

Goldfield
near

Bill Calmes

S

35

PAY CASHIER

for Halbildig
Woodworth
Mount.

S

33

Prude
Hunter
Well Wells

BOOLS & BUTLER

228 N. CENTER ST.

Harness, Saddles and Canvas
Auto Trimming

Reno, Nevada,

1912

Sold to

Mr Sparks

Stringing saddle	1.00
Bucking rolls	2.75
Coirch	3.25
Stumps & Leather	3.00
	<hr/>
	\$7.50

Paid

Charges are based upon value, and the liability of this Company is limited to \$50.00 unless a greater value is declared at time of shipment. Fragile articles and articles consisting of or contained in glass or chinaware, at owner's risk.

Express Charges do not include Duties or Custom House Expenses, which must be guaranteed by Shipper.

NOT
NEGOTIABLE

Wells Fargo & Company Express

Carson, Nev. 6/24/1909

RECEIVED from

W. H. ... said to contain

value declared by shipper as

Twenty dollars marked

Which Wells Fargo & Company, hereinafter called the Company, undertakes to carry upon the following terms and conditions, to which the shipper hereby agrees, and as evidence of such agreement accepts this Shipping Receipt.

1. It being understood that the Company relies upon railroad, steamboat, stage and other lines for transportation, and has no control over same, it is agreed that its liability shall be that of a forwarder only, and that it shall not be liable for any damage to said property from delay of any railroad train, steamboat or other conveyance on which the same may be carried.

2. The charge for forwarding said property being based upon a valuation not exceeding Fifty Dollars, unless a greater value is declared, it is hereby agreed that the Company shall not be liable in any event for more than Fifty Dollars unless a greater value is stated herein and in case of partial loss or damage, shall not be liable for more than such a proportion of same as Fifty Dollars, or the value declared herein, bears to the actual value if greater.

3. If the Company has no office at destination, it shall carry said property to its office nearest or most convenient to destination, and there notify consignee or deliver said property to connecting carrier to complete transportation, and the Company shall not be liable for any loss or damage occurring after giving such notice to consignee or after delivery to connecting carrier.

4. The Company, unless negligent, shall not be liable for loss of or damage or delay to said property caused by quarantine, customs regulations, strikes, riots or perils of navigation, fire or steam, the act of God, heat, cold, wet or decay, nor for the escape, injury or death of live birds or animals, the Company not being a carrier thereof, except at owner's risk. Nor shall the Company be liable in any event for any loss of or damage or delay to said property from any cause whatever, unless the same shall be proved to have resulted from the fraud or negligence of the Company, or its servants.

5. The said property being packed, secured and addressed by the shipper, it is agreed that the Company shall not be liable for any delay or damage to same resulting from improper or insufficient packing, securing and marking, nor shall the said Company be liable for any damage to fragile articles or articles consisting wholly or in part of or contained in glass or chinaware, unless the same shall be marked, described and accepted as such herein, and additional compensation paid or agreed to be paid therefor.

Nor shall the Company be liable for any loss of money, jewelry or valuable papers, unless the same are separately packed, sealed, marked as such and so described herein.

6. If any C. O. D. is not paid by consignee within thirty days from the date hereof, it is agreed that the Company may, at its option, return the said property to shipper, who shall pay charges for transportation both ways, and that the liability of the Company shall be that of warehouseman only, except during actual transportation and twenty-four hours thereafter.

7. In no event shall the Company be liable for any loss, damage or delay unless written claim therefor shall be presented to it within ninety days of the date of such loss, damage or delay; and any suit for or on account of such loss, damage or delay shall be brought within one year from the date hereof or be forever barred, any statute of limitation to the contrary notwithstanding.

8. It is further agreed that any carrier or party liable on account of loss of or damage to said property shall have the full benefit of any insurance that may have been effected upon or on account of said property.

9. The Company shall not be required to deliver said property except within its present delivery limits unless herein otherwise agreed and specially paid for. At points where the Company has no delivery service, the consignee shall receive said property at the office of the Company.

10. If said property shall be forwarded upon Ocean Routes, it is agreed that the regular Bill of Lading of any steamship company to whom the same may be delivered, shall limit and define the Company's liability with respect to such ocean transportation unless an extra charge has been paid or agreed to be paid for Marine Insurance and noted herein by receiving agent of the Company.

11. All the terms and conditions of this receipt shall apply to any forwarding or return of said property, and shall extend to and inure to the benefit of any person, company or corporation to whom the Company may deliver the said property for transportation, storage or delivery.

For WELLS FARGO & COMPANY EXPRESS

Charges \$

(17)

Shipments are forwarded in Charge of Messengers and by the Swiftest Trains, Stages and Steamers.

WELLS FARGO & COMPANY

EXPRESS CARRIERS

Over Railroad, Stage and Steamboat Routes.

**Throughout the United States
AND TERRITORIES.**

ALSO, IN
BRITISH COLUMBIA and MEXICO

The Company's Lines Covering some **40,000 Miles.**

EXPRESS FORWARDERS

FROM NEW YORK, TO

**Liverpool, London,
Havre, Paris, Hamburg,**
And all the Principal Points in Europe.

And, by Steamers from San Francisco, to
ALL PACIFIC COAST PORTS

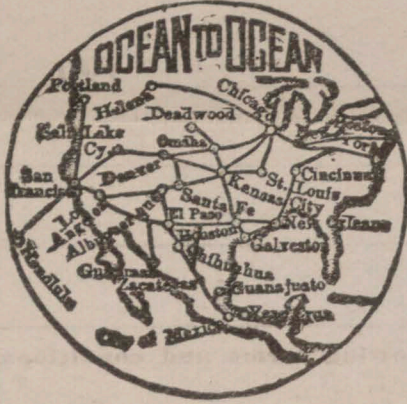

Connections are made with ALL RESPONSIBLE EXPRESS COMPANIES, thus reaching nearly every Hamlet, Town and City in the UNITED STATES and CANADA.

CARRIES AND DELIVERS

MONEY, VALUABLE PARCELS, PACKAGES,
MERCHANDISE, LETTERS, ETC.

FILLS COMMISSIONS

Records Deeds, Pays Taxes for Non-Res-
idents, Serves Legal Papers, Etc.

RECLAIMS BAGGAGE ETC.

At Depots and Hotels, and Redeems
Goods in Pawn.

MONEY ORDERS

Paid everywhere in the United States,
Canada and Mexico.

TRAVELERS' MONEY ORDERS

Payable in all countries of the world at par.

Money sent by Telegraph to all Principal
Agencies and delivered promptly
by Special Messengers.

COLLECTS

Drafts, Notes, Bills, Coupons, Divi-
dends and Other Paper.

ATTENDS TO ORDERS

For Goods and Household Supplies to be
returned by Express.

FOREIGN TRAVEL ETC.

Attends to Passengers and Baggage, coming or
going, and to Transportation of
Goods in Bond.

Orders For Exchange—Foreign and Domestic—are taken at all Offices.

Favorable Rates for Produce, Vegetables, Fruit, Game, Etc.

Fair Rates, Quick Despatch and Careful Handling.